

- 10.35 Sketch|St. Paul's Cathedral
- 10.50 Group picture|cathedral steps
- 11.00 Gather for guided tour
- 11.15 Guided tour|St Paul's Cathedral|your ticket was included in your packet, *remember to bring it with you*; omiyage [*Regan Campbell*] for tour guide
- 14.00 Self-guided tour|Victoria and Albert Museum (VAM) [free]; must sees|
  - Architecture Gallery, room 127–128A
  - Galleries rooms 50a & 50b, Cast Courts room 46

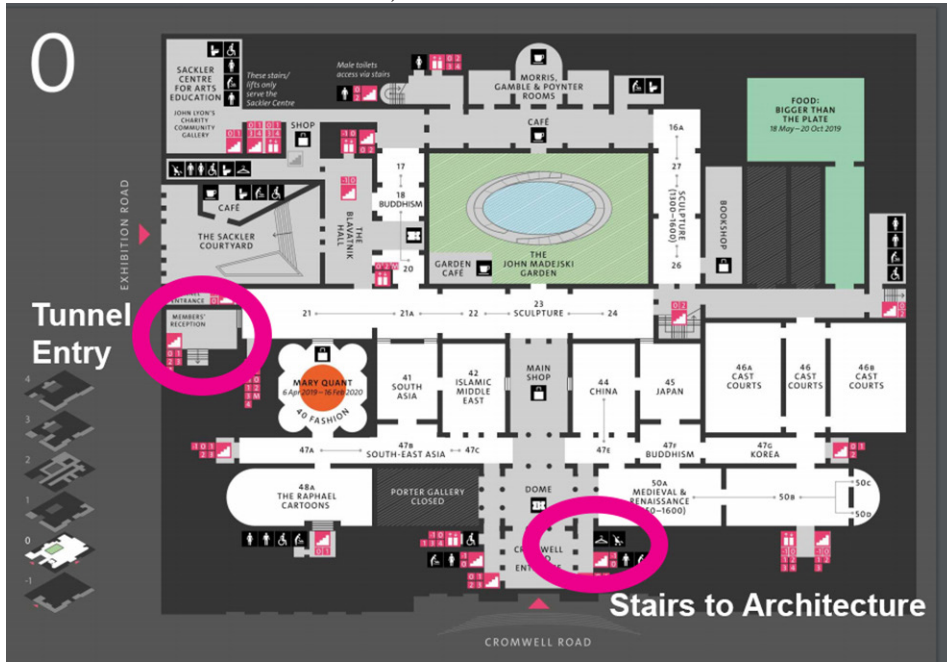

floor plan: Victoria and Albert Museum brochure

- 16.00 Visit Serpentine Pavilion [£0]; *conduct site analysis in preparation for the charette*. Pavilion open daily, until park closure.

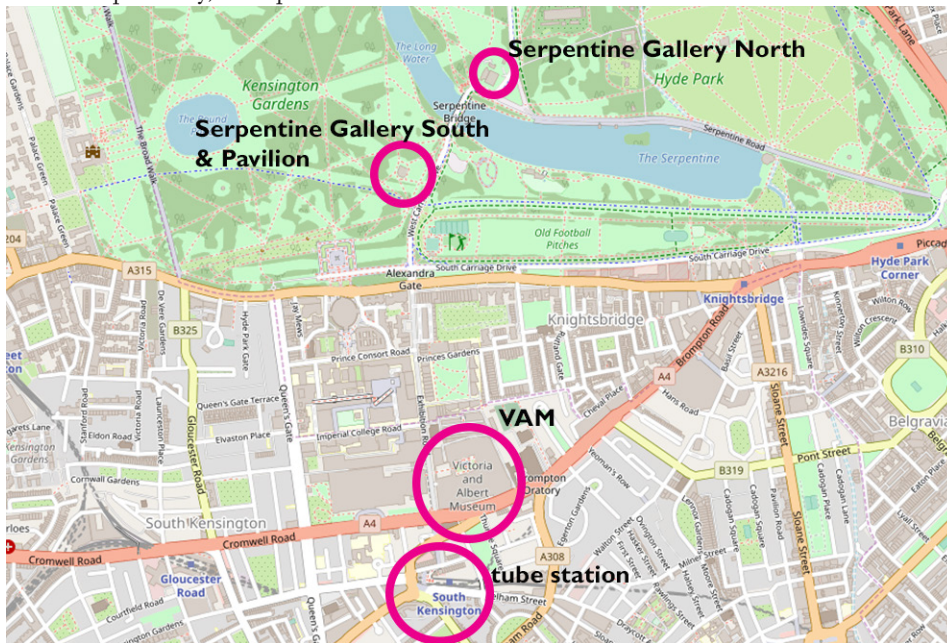

- Also see|Serpentine Galleries South (closeby) and North. Both galleries are open T–Sun and require free timed tickets, booked in advance.

## GETTING THERE

- *Remember to bring your St. Paul's Cathedral admission ticket (in your packet)*

## ST. PAUL'S CATHEDRAL

St. Paul's Churchyard; EC4M 8AD;  
 <<https://www.stpauls.co.uk/>>

- Tube Destination|St. Paul's
- Walk through Paternoster Square and Temple Bar (gate) to the cathedral stairs (eastside)
- *Dress modestly|no bare shoulders, no shorts.*

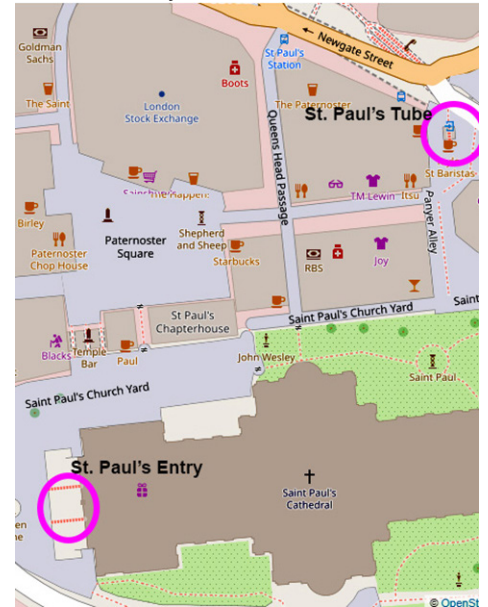

## VICTORIA & ALBERT MUSEUM (VAM)

Cromwell Road; SW7 2RL; <<https://www.vam.ac.uk/>>; open daily 10.00–17.45, 10.00–22.00 F

- Tube Destination|South Kensington
- Use the subway (tunnel) from the tube station to walk to the basement entry of the VAM. It avoids lots of congestion, confusion, and perhaps inclement weather (wet or hot!).

## SERPENTINE PAVILION

next to Serpentine South Gallery;  
 Kensington Gardens; W2 3XA; <[www.serpentinegalleries.org/whats-on](http://www.serpentinegalleries.org/whats-on)>

- Walk north from VAM on Exhibition Road into Hyde Park to Serpentine Gallery South and Pavilion (15 min.)

## OTHER POINTS OF INTEREST

SERPENTINE GALLERIES  
 open T–Sun, 10.00–18.00.

## SERPENTINE NORTH GALLERY

West Carriage Drive; W2 2AR  
 • houses ZHA's café