

Sustainability and Daylighting

—for Carolina Hidalgo

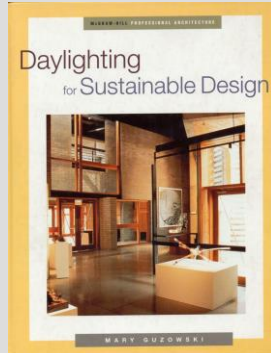

Original title
Daylighting & Ecology:
Towards a Sustainable
Approach to Design
Mary Guzowski, UMinn

1

Environmental Considerations		
Take a Bioregional Approach	Do More with Less	Design for Evolution, Flexibility, and Adaptability
Architectonic Considerations		
Shape Form to Guide Flow	Use Technology that is Appropriate	Take an Integrated Approach*
Human Considerations		
Address Health and Well-Being	Consider Quality of Life	Reveal Process to Educate*

2

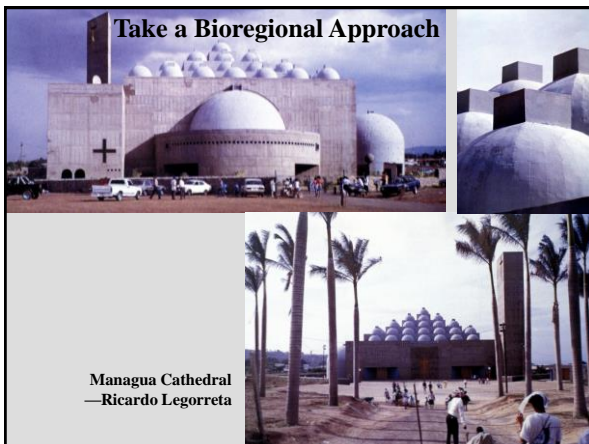

3



4



5

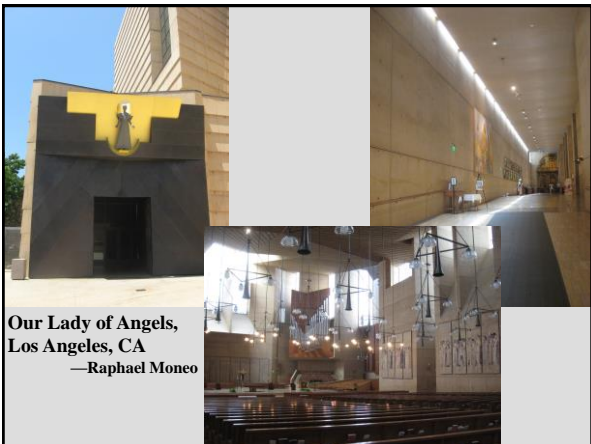

6

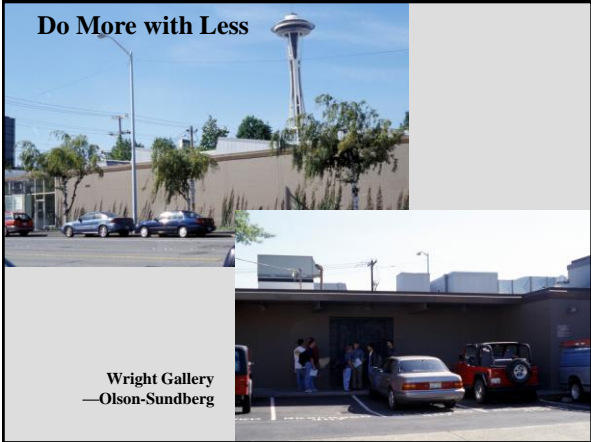

7



8



9

Design for Evolution, Flexibility, and Adaptability



Musée d'Orsay
Paris

10

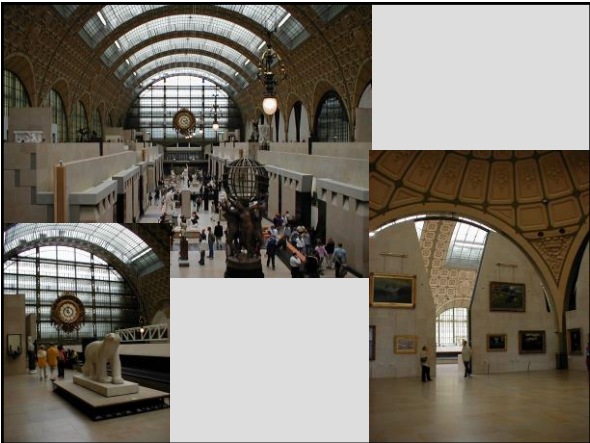

11

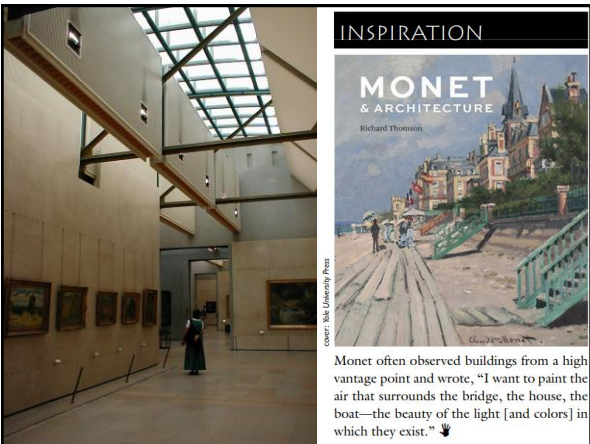

12



13

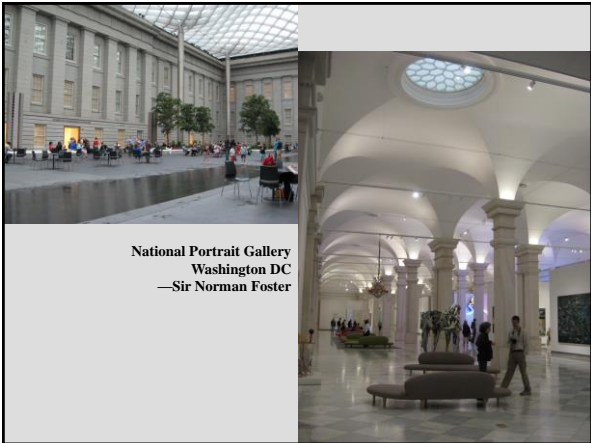

14

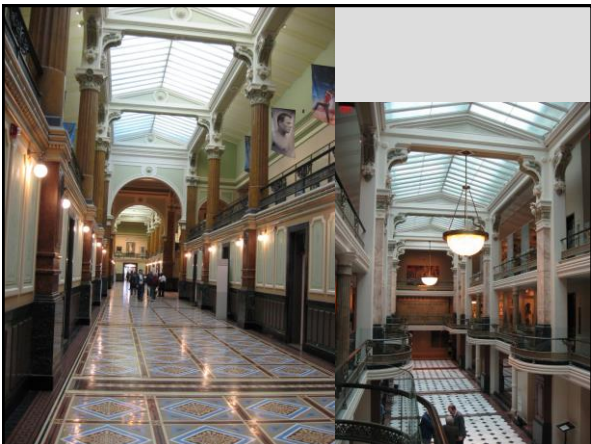

15

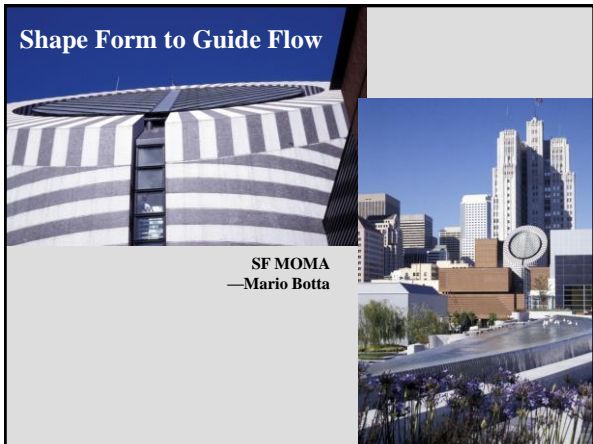

16



17



18

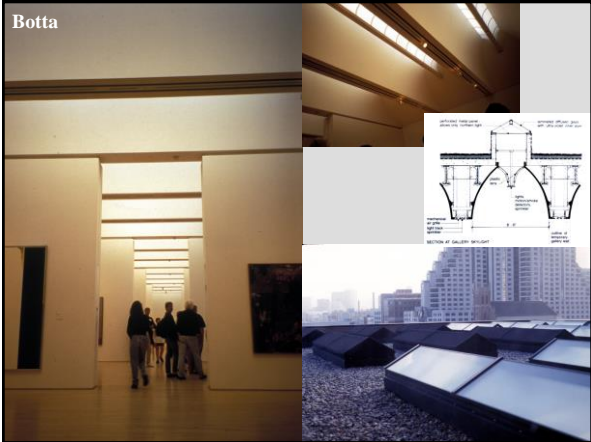

19

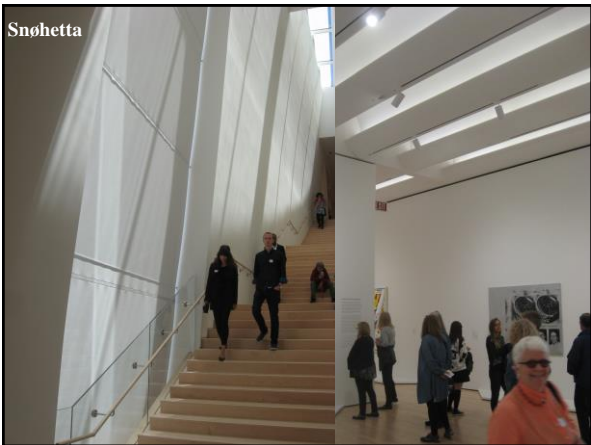

20



21

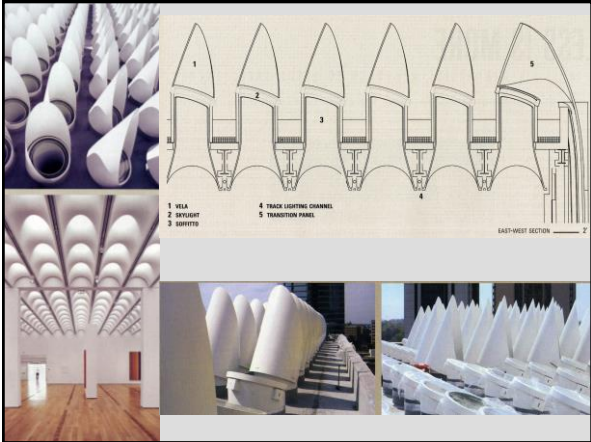

22

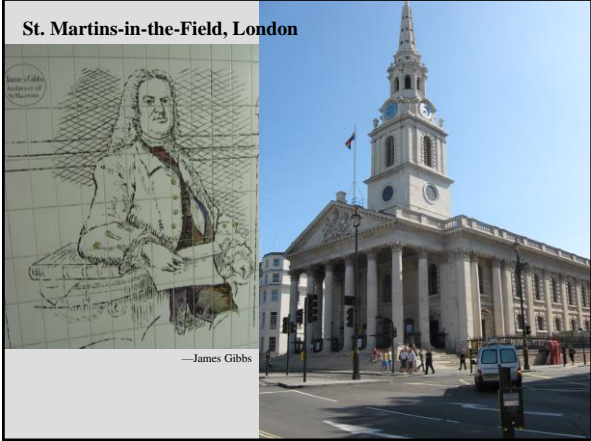

23



24



25



26

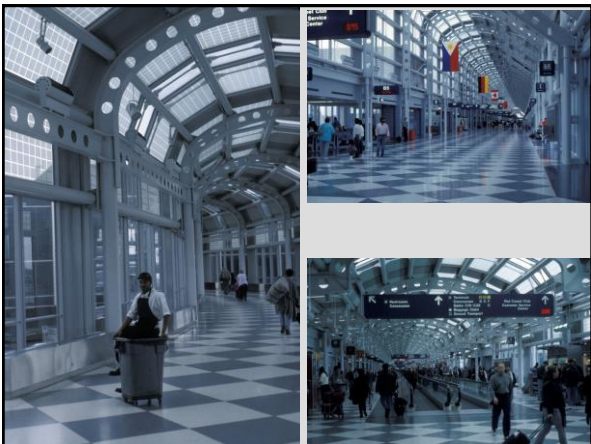

27

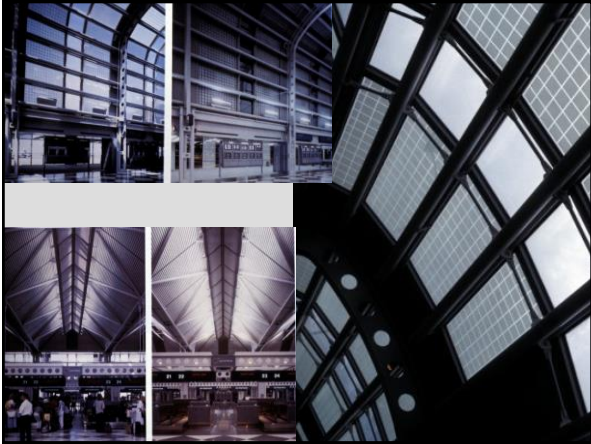

28



Underground connector of terminals B & C, O'Hare

Underground Space Center U. Minnesota

29

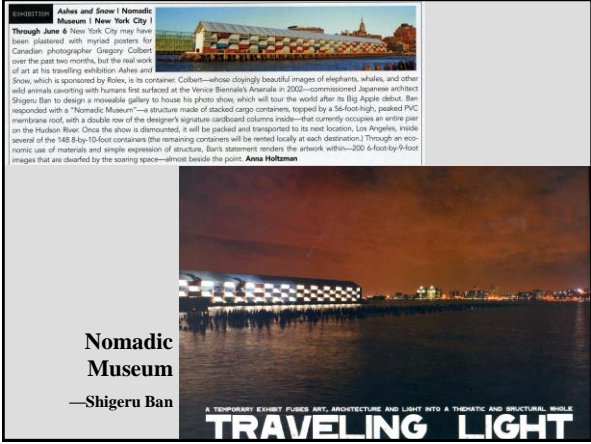

Installation **Ashes and Snow | Nomadic Museum | New York City |**
 Through June 4 New York City may have been plastered with myriad posters for Canadian photographer Gregory Colbert over the past two months, but the real work of art at his traveling exhibition *Ashes and Snow*, which is sponsored by Rolex, is its container. Colbert—whose slyly beautiful images of elephants, whales, and other wild animals (covering with humans first surfaced at the Venice Biennale's Arsenalate in 2002—commissioned Japanese architect Shigeru Ban to design a movable gallery to house his photo show, which will tour the world after its Big Apple debut. Ban responded with a "Nomadic Museum"—a structure made of stacked cargo containers, topped by a 58-foot-high, peaked PVC membrane roof, with a double row of the designer's signature cardboard columns inside—that currently occupies an entire pier on the Hudson River. Once the show is dismantled, it will be packed and transported to its next location, Los Angeles, inside several of the 148 8-by-10-foot containers (the remaining containers will be rented locally at each destination.) Through an economic use of materials and simple expression of structure, Ban's statement renders the artwork within—200 to four-by-10-foot images that are dwarfed by the soaring space—almost beside the point. **Anna Holtzman**

Nomadic Museum —Shigeru Ban

A TEMPORARY EXHIBT FUSES ART, ARCHITECTURE AND LIGHT INTO A THEMATIC AND STRUCTURAL WHOLE
TRAVELING LIGHT

30

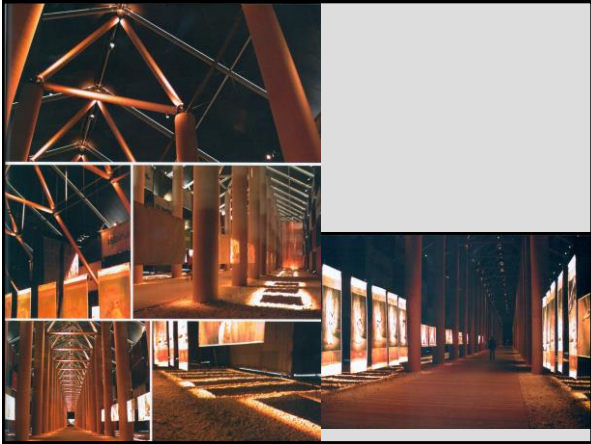

31

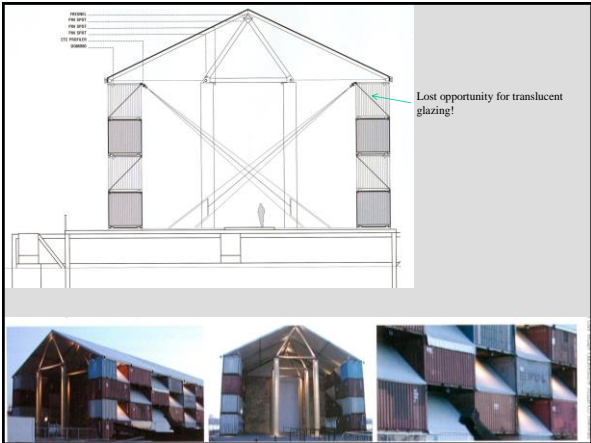

32



33



34

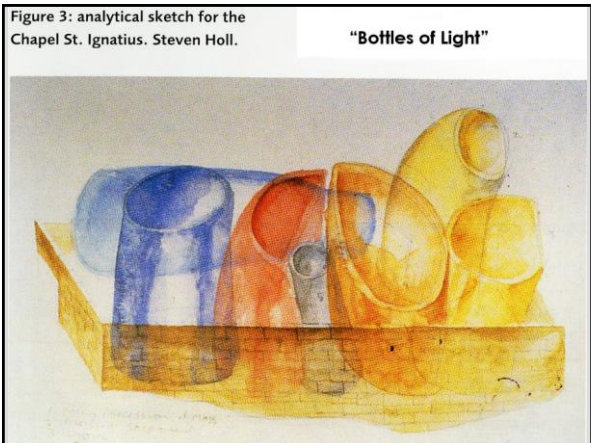

35



36



37

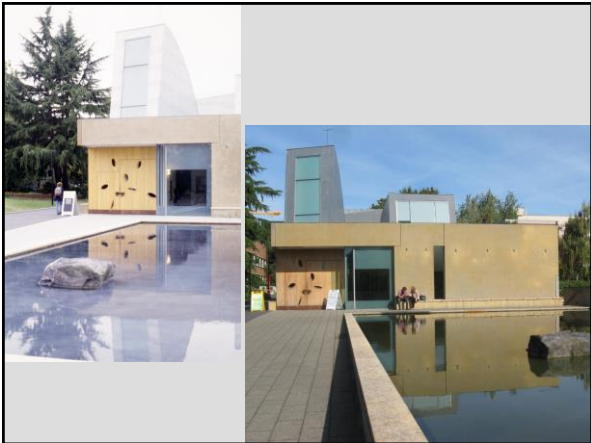

38

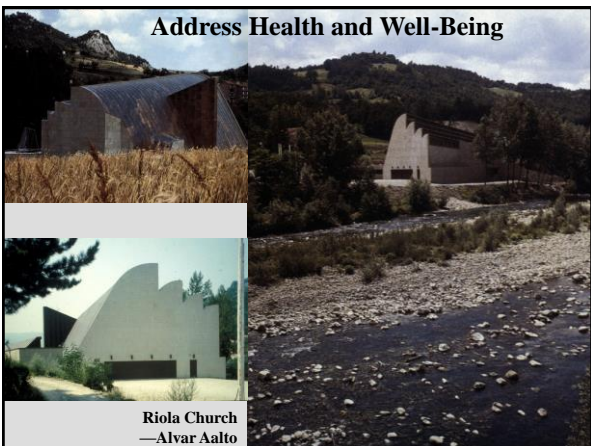

39

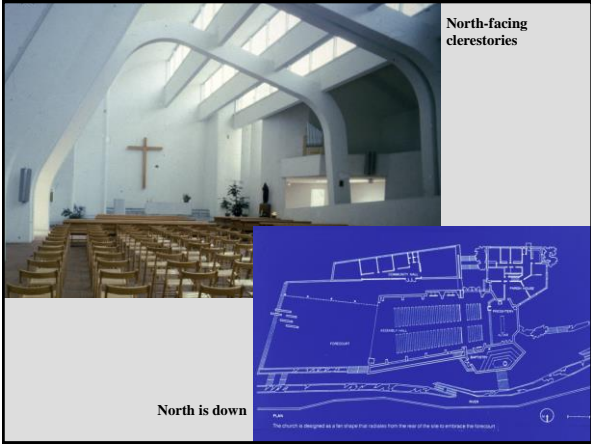

40

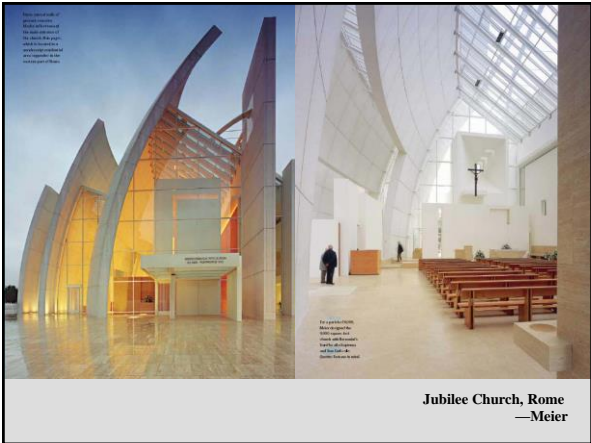

41

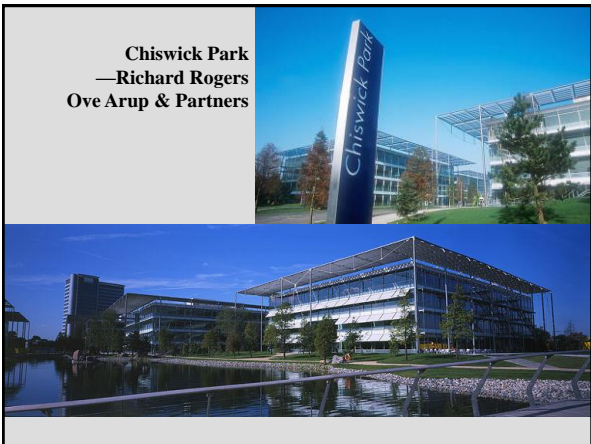

42

CHISWICK PARK
ENJOY-WORK.COM
 I ENJOY WORK. HOW CAN I HELP?
 I DON'T ENJOY WORK. DON'T EVEN ASK
WELCOME

THE FACTS MASTERPLAN LOCATION IMAGES PROGRESS AWARDS TEAM CONTACT

ENJOY! **ON SITE SERVICE** EVENTS USES/ME **DATA/FACTS** **EVENTS**

CHISWICK PARK	Sq.ft.	Car Spaces
BUILDING 1	81,000	103
BUILDING 2	99,500	100
BUILDING 3	129,000	149
BUILDING 4	157,000	157
PLOT 5	136,000	136
PLOT 6 & 7	220,000	220
PLOT 8	140,000	140
PLOT 9	160,000	160
BUILDING 10	114,500	114
BUILDING 11	99,500	100
BUILDING 12	81,000	80

WHO'S WHO?
 ROLL OVER THE COMPLETED BUILDINGS TO SEE THE TENANTS...

- COMPLETED
- NEXT PHASE
- BAR/BRASSERIE AND HEALTH CLUB
- SPECIFICATION
- VIEW FLOORPLATES FOR AVAILABLE BUILDINGS

Sumnerbury

43

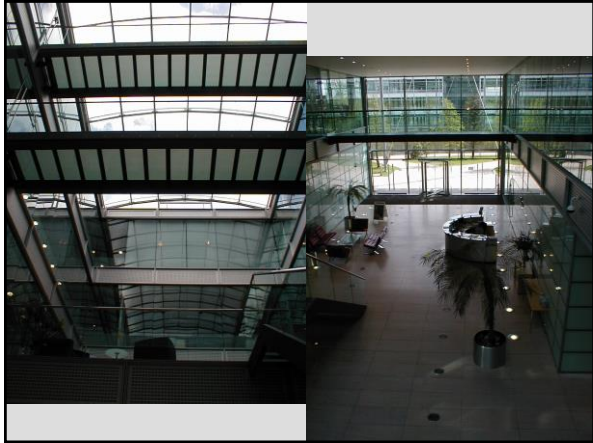

44

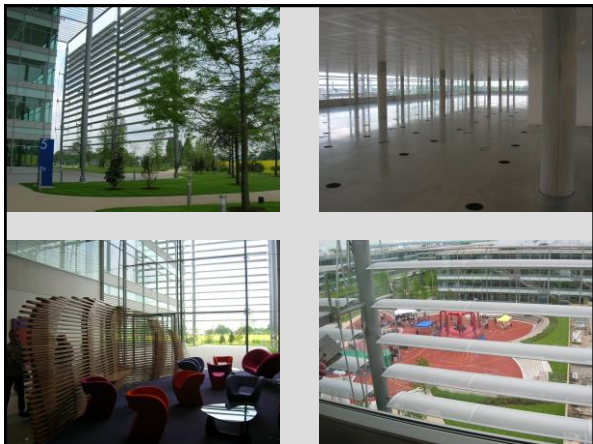

45



46



47

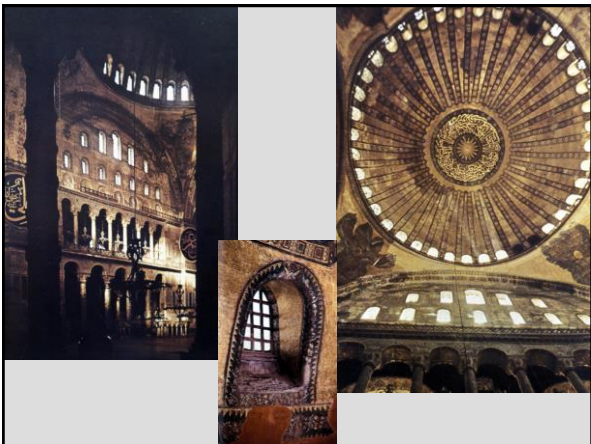

48

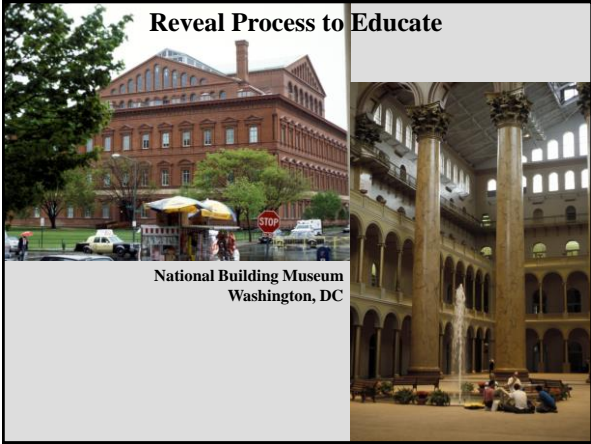

49

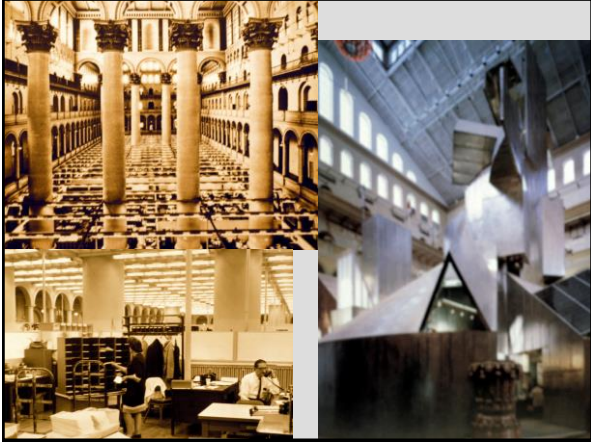

50

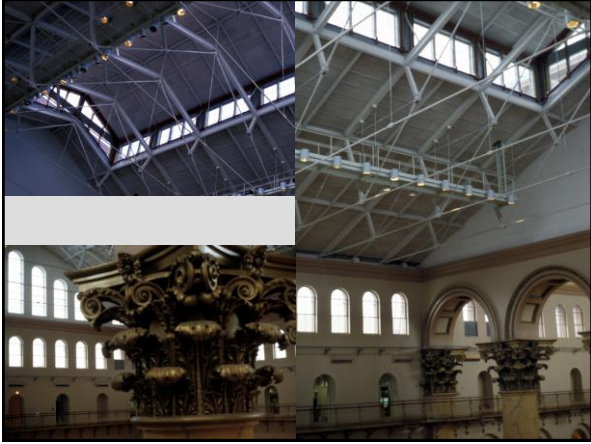

51



52



53

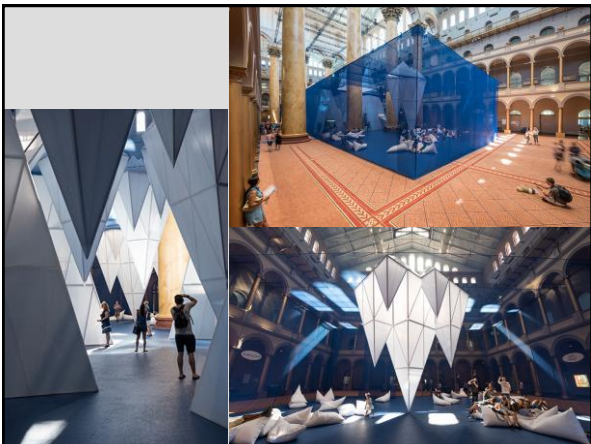

54

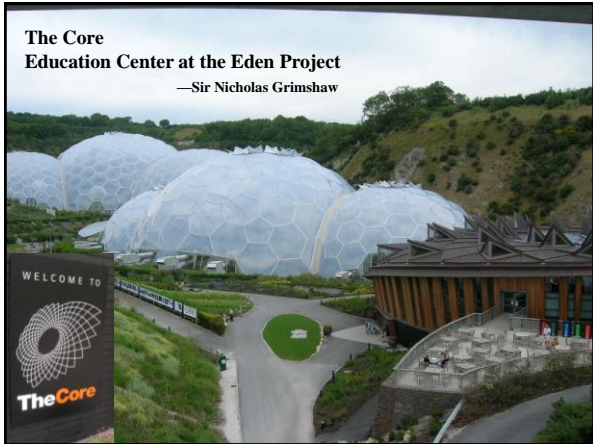

55

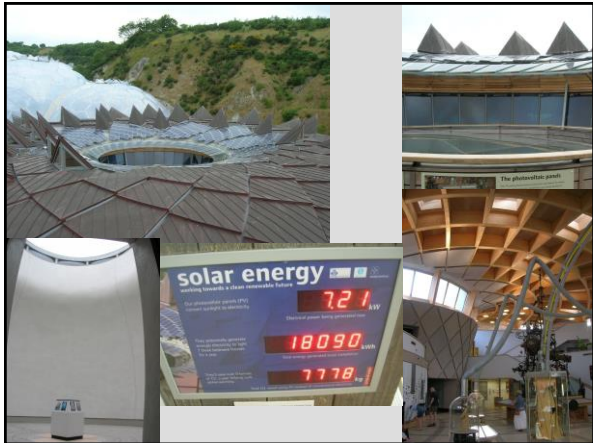

56
