

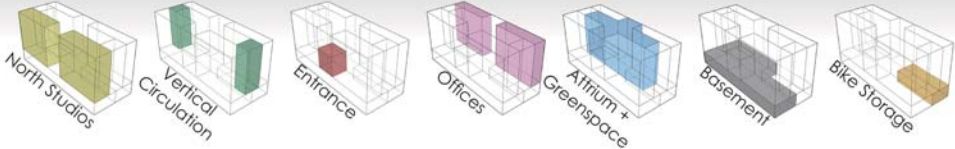

TREEHOUSE

Glasgow, Scotland

- 100% Onsite Water Capture and Treatment
- EUI of 21.43 kBtu/sqft/yr
- 15% of Square Footage Dedicated to Vegetation
- Walkscore of 98 - Walker's Paradise
- Cycle Friendly - Encourages Alternative Transportation



Wall Section: Vertical Fin Connection

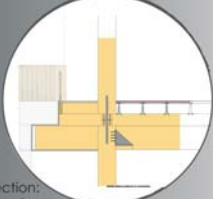

Wall Section: Southern Overhang

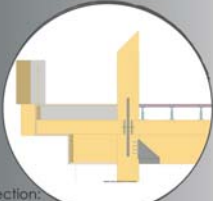

Wall Section: Southern Overhang

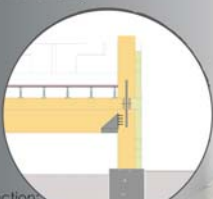

Wall Section: Foundation

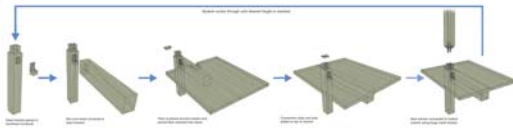

Structure is composed of three main timber components that connect seamlessly. This kit of parts was designed with adaptive reusing in mind - it is easy to put together and take apart, making future changes in floor plans easy to accomplish.

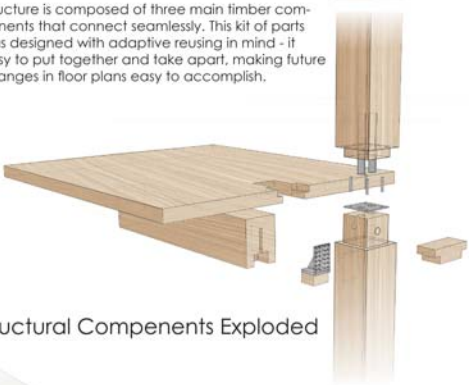

Structural Components Exploded



Section Perspective

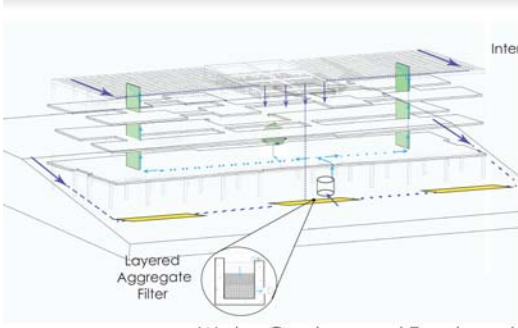
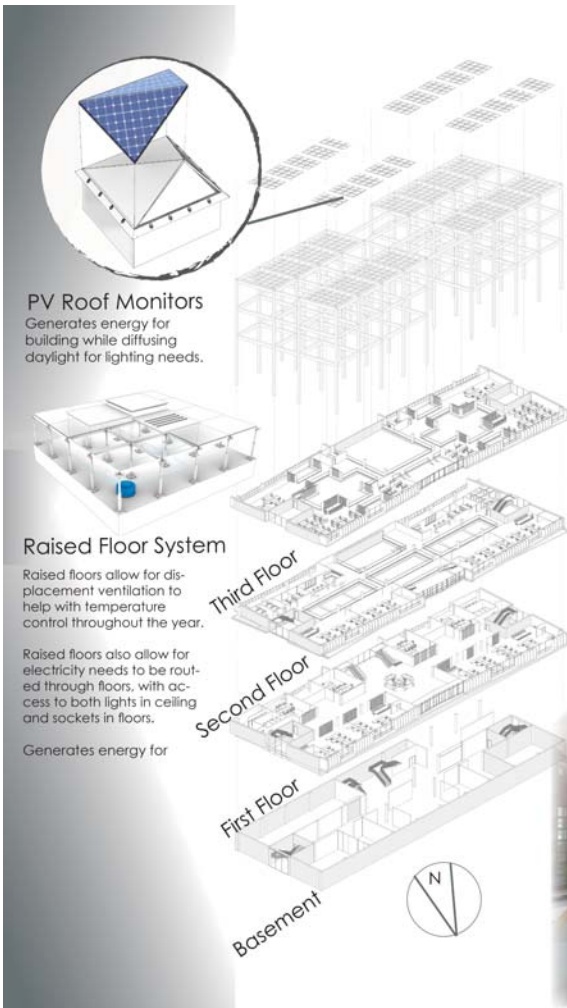

Water Capture and Treatment

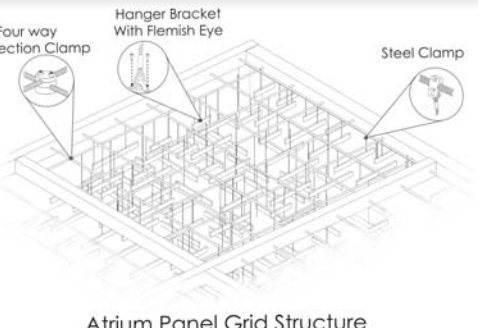

Atrium Panel Grid Structure