

1. INSTRUMENT STORAGE
2. GREEN ROOM1
3. GREEN ROOM2
4. PERFORMERS LOUNGE
5. INSTRUMENT STORAGE
6. RESTROOMS
7. ORCHESTRAL WAITING
8. REHEARSAL HALL
9. OPEN CAFE
10. INDOOR CADE
11. RESTROOMS
12. ADMINISTRATION

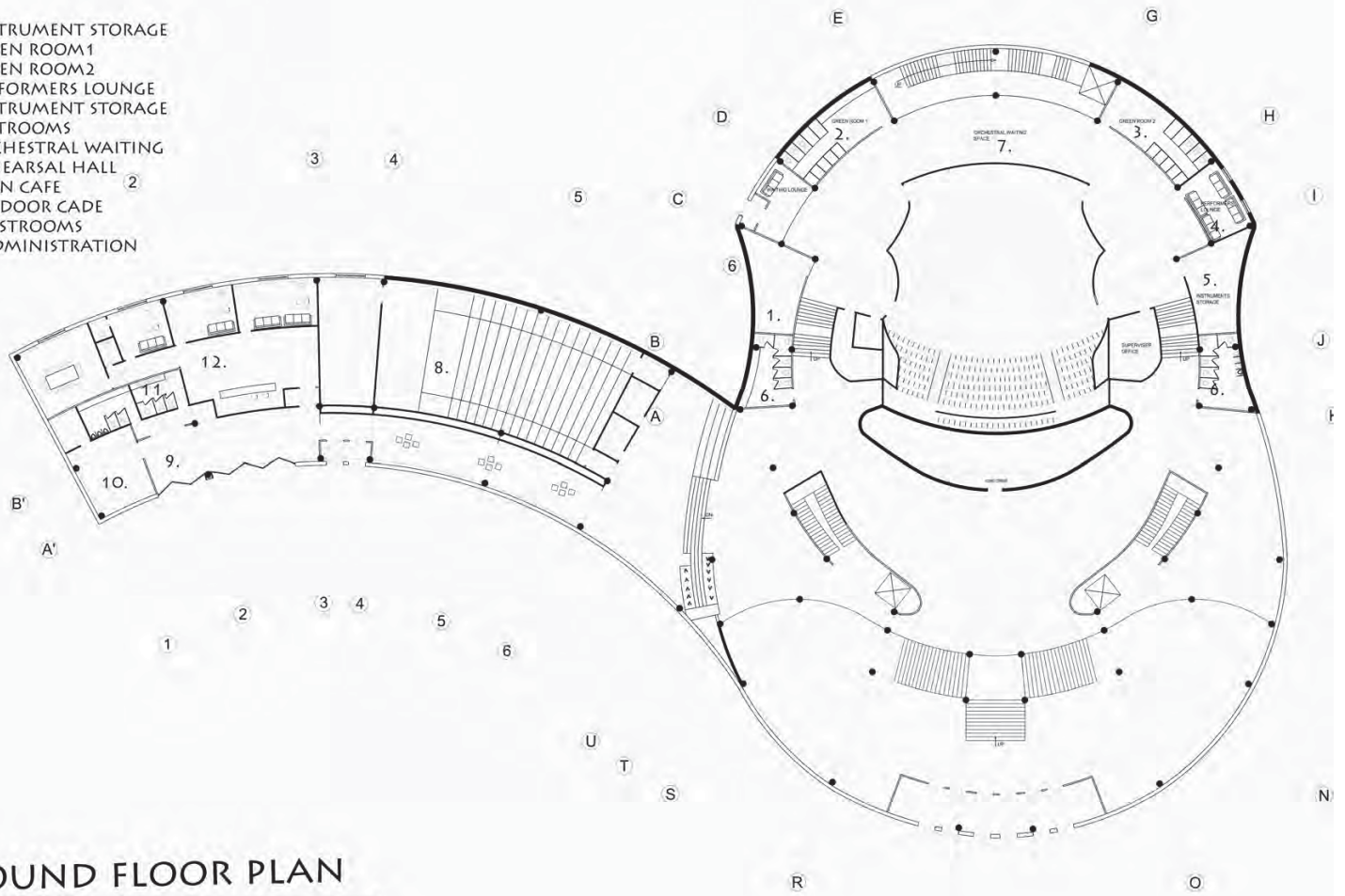

**GROUND FLOOR PLAN**

1. INSTRUMENT STORAGE
2. GUEST ROOMS
3. STORE
4. GUEST GREEN ROOMS
5. INSTRUMENT STORAGE

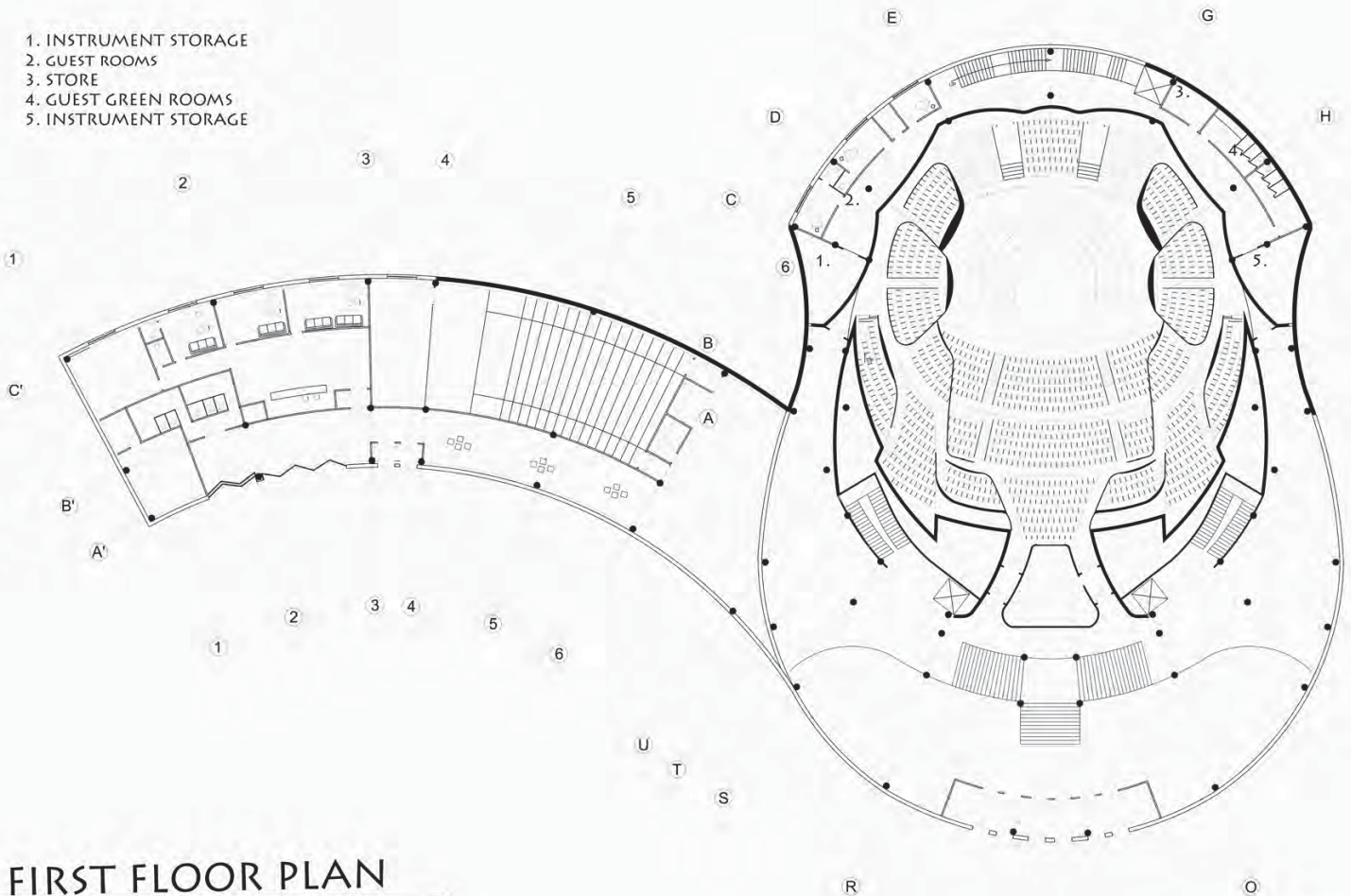

**FIRST FLOOR PLAN**

- 1. PRACTISE SPACE 1
- 2. PRACTISE SPACE 2
- 3. REST ROOMS

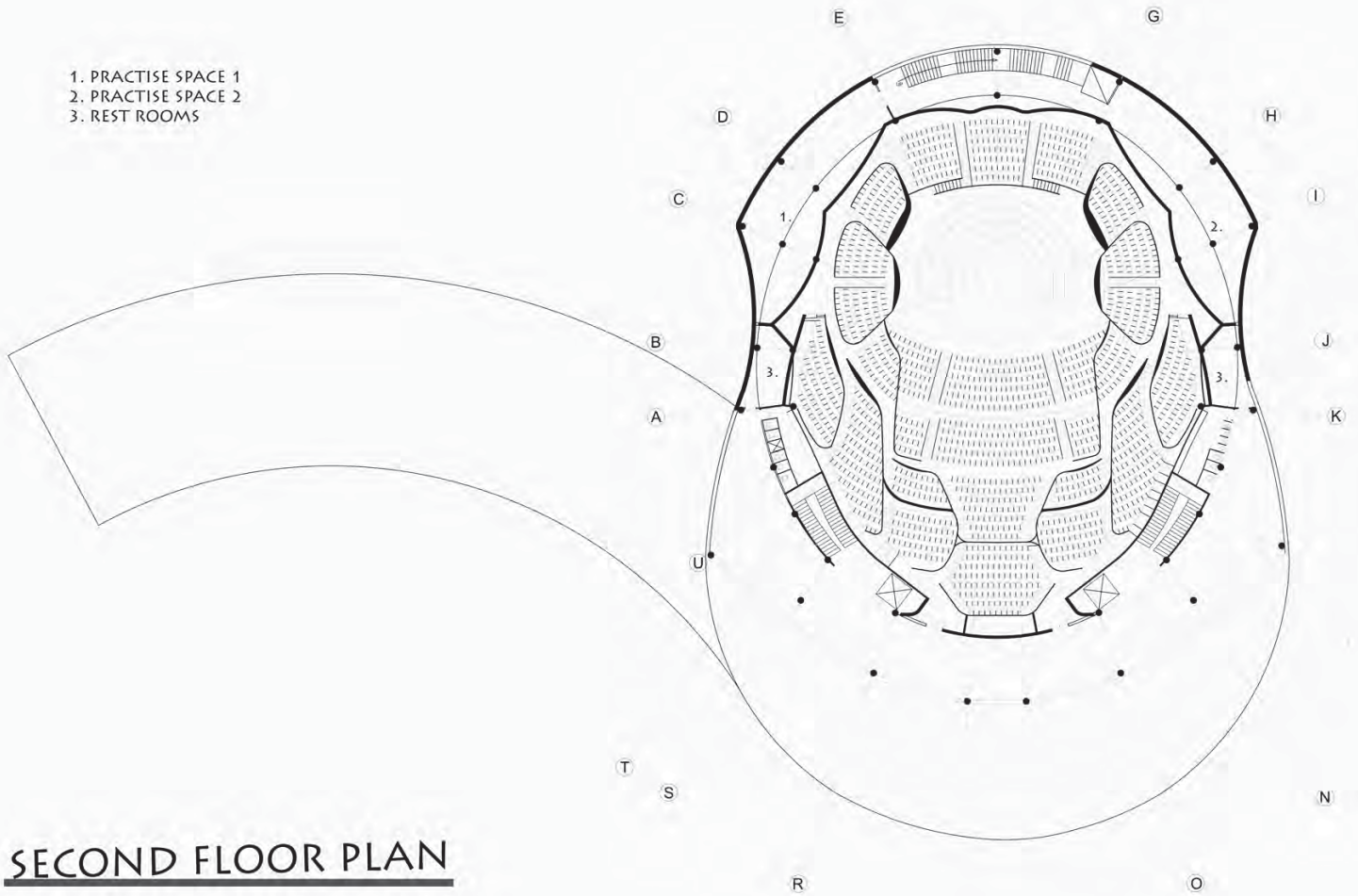

SECOND FLOOR PLAN

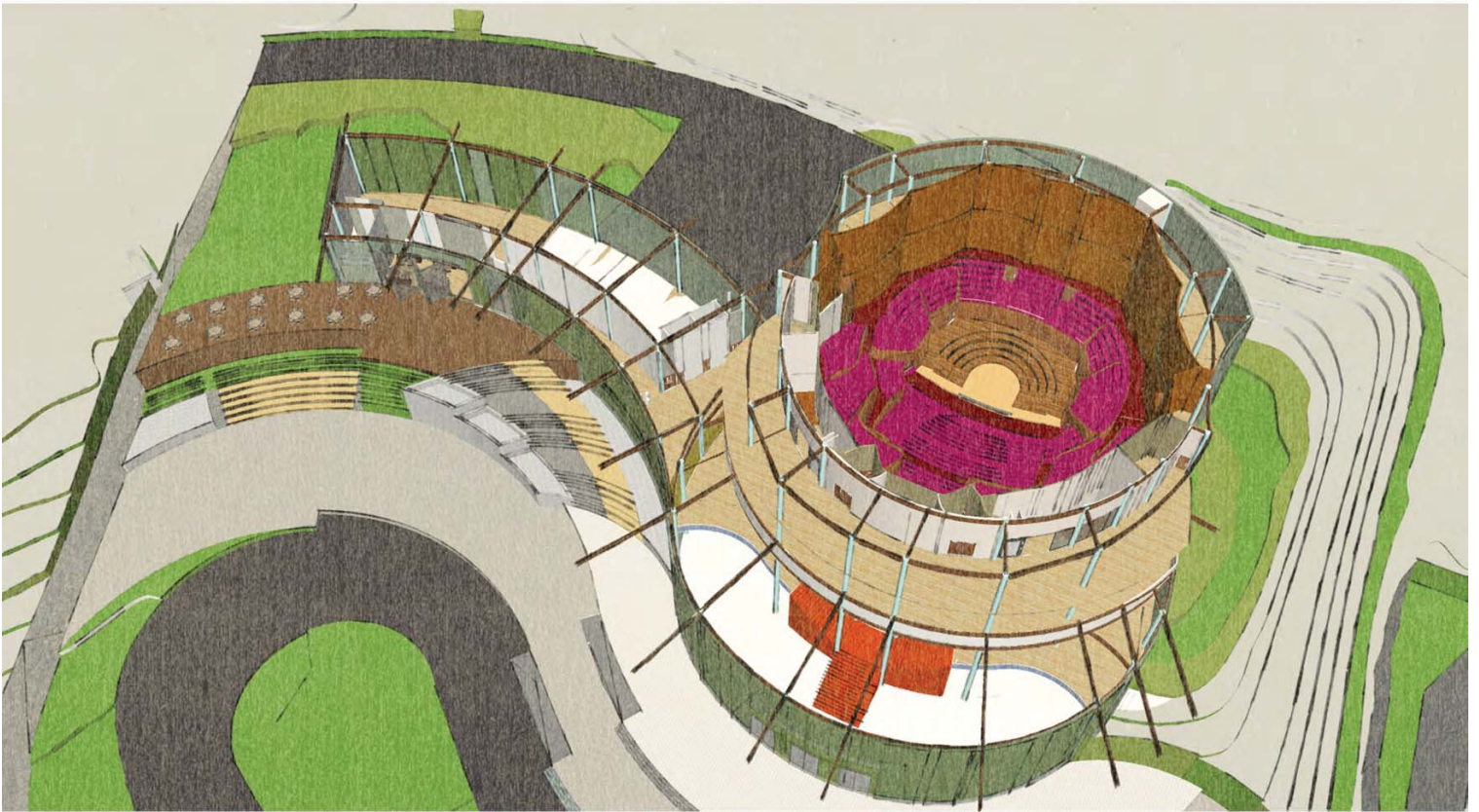

STRUCTURAL VIEW

Room(Full Occupancy)@ 500 Hz				
Surface	Material	Area (sq. ft)	Absorbency	Absorption(S)
Ceiling	Gypsum Bd.	14000	0.05	700
Ceiling, absorptive	Polycarbonate	6000	0.9	5400
Side Wall	CMU, painted	12000	0.4	4800
Side Wall, absorptive	CMU	7000	0.06	420
Balcony	beech wood	2500	0.7	1750
Rear Wall	Heavy carpet	6000	0.8	4800
Aisles	Carpet on concrete	2000	0.14	280
Orchestra Pit & Apron	Wood	700	0.1	70
Stage Opening	(furnished)	12000	0.5	6000
Audience	seated in upholstered seats	3060	0.8	2448
		Volume (cu. Ft.)	Total Absorption	26668
Room Volume		1368498.04	Reverberation Time	2.51
Room(Half-Occupancy)@500Hz				
Auditorium (less audience)				24220
Seats				1713.6
Audience				2448
		Total Absorption	28381.6	
		Reverberation Time	2.36	

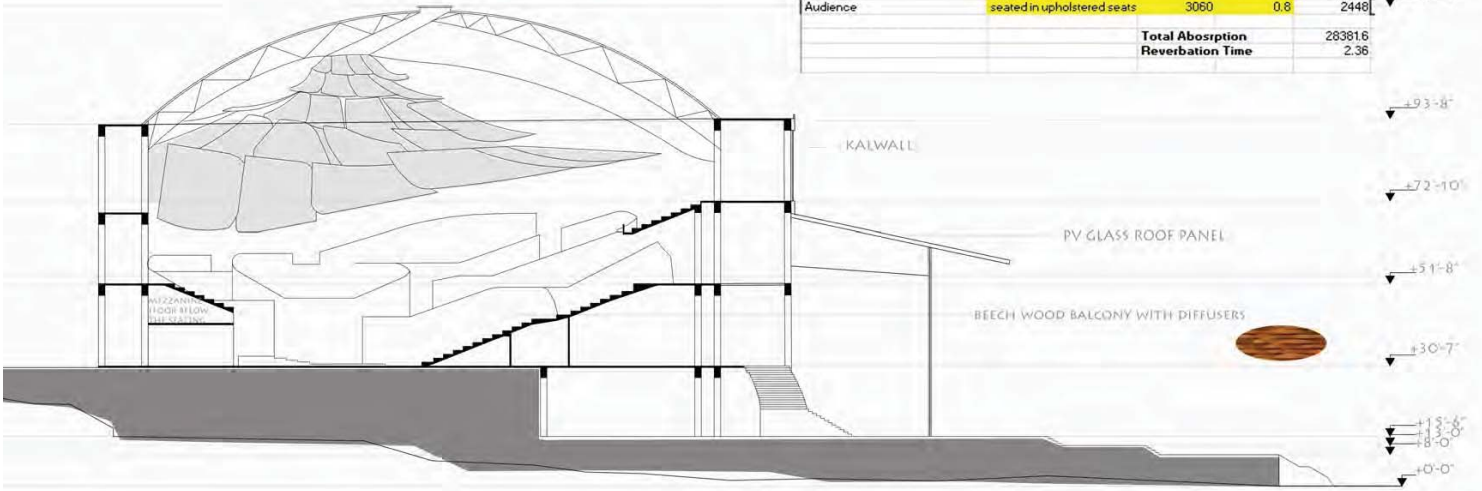

## SECTIONAL DRAWING





3D VIEWS



3D VIEWS



GALLERY SPACE



VIEW FROM THE LOBBY OF HALL



FIRST FLOOR LOBBY SPACE



LINKAGE SPACE BETWEEN HALL AND WING

3D VIEWS