

MICHAEL HOPKINS:

SUSTAINABLE ARCHITECT



BACKGROUND:

- SIR MICHAEL HOPKINS
FOUNDED HOPKINS
ARCHITECTS WITH WIFE PATTY
IN **1976**
- BASED IN **LONDON**, WITH
PROJECTS ALL OVER THE
WORLD
- A **PIONEER IN SUSTAINABLE
ARCHITECTURE**



THEIR APPROACH:

- START WITH **EXTREME WISH LIST**, THEN NARROW DOWN THE ITEMS THAT ARE BEST FOR THE CLIENT.
- STRIVES TO **EMBED SUSTAINABILITY FULLY INTO THEIR DESIGN** PROCESS
- **LONG-TERM SUSTAINABILITY**, THROUGH PAYING CLOSE ATTENTION TO THE FORM, SCALE, AND ORIENTATION OF THE BUILDING
- FOCUSING ON **OCCUPANT BEHAVIOR** IS THEIR KEY TO GETTING EFFECTIVE, LOW-ENERGY RESULTS

STANCE ON SUSTAINABILITY:

- COMMITMENT TO **SUSTAINABLE DESIGN** HAS BEEN THEIR CORE **FOCUS** SINCE THE FIRM WAS FOUNDED
- WORKS WITH CLIENTS TO DEVISE **LONG-LASTING, ECONOMICALLY-VIABLE SOLUTIONS** TO HELP SAVE MATERIALS AND ENERGY, REDUCE WASTE THAT HOLISTICALLY ENHANCES AND INTEGRATES WITH A COHERENT ARCHITECTURAL EXPRESSION
- WORKS TO ATTAIN SOME LEVEL OF SUSTAINABILITY ON **EVERY PROJECT** TO FIT WITHIN THEIR BUDGET

AWARDS:

- AWARDED A **CBE AND KNIGHTED** FOR SERVICES TO ARCHITECTURE,
- WON THE **RIBA GOLD MEDAL** FOR ARCHITECTURE IN 1994,
- A **ROYAL ACADEMICIAN** AND PAST PRESIDENT OF THE ARCHITECTURAL ASSOCIATION
- MULTIPLE PROJECTS AWARDED **LEED AND BREEAM CERTIFICATION**



JUBILEE CAMPUS:

UNIVERSITY OF NOTTINGHAM | NOTTINGHAM, UNITED KINGDOM



- RATED: 10/13

- LEED 'PLATINUM'

- SYMBOL OF THE SCHOOL'S IDEALS AND VALUES THAT APPROACHES **CARBON NEUTRALITY**

- MET UK GOVERNMENT'S 2050 CO2 REDUCTION TARGET IN 1999

KROON HALL:

SCHOOL OF FORESTRY AND ENVIRONMENTAL STUDIES |
YALE UNIVERSITY, NEW HAVEN, CONNECTICUT, USA



- RATED: 12/13

- LEED 'PLATINUM'

- CONSTRUCTED OF A MIX OF
NATURAL AND CONTEMPORARY
MATERIALS

- ELIMINATED 2/3 OF ENERGY
USED IN MODERN BUILDINGS.

PORTCULLIS HOUSE:

NEW PARLIAMENTARY BUILDING | LONDON, UNITED KINGDOM



- RATED: 9/13

-AWARDED BREEAM 'EXCELLENT'

- OFFICES FOR 210 MPS AND A SUITE OF SELECT COMMITTEE ROOMS, FACES THE RIVER

- INTEGRATES THE DISPARATE BUILDINGS OF THE PARLIAMENTARY ESTATE

APPLIED RESEARCH & DEVELOPMENT BUILDING

NORTHERN ARIZONA UNIVERSITY | FLAGSTAFF, ARIZONA

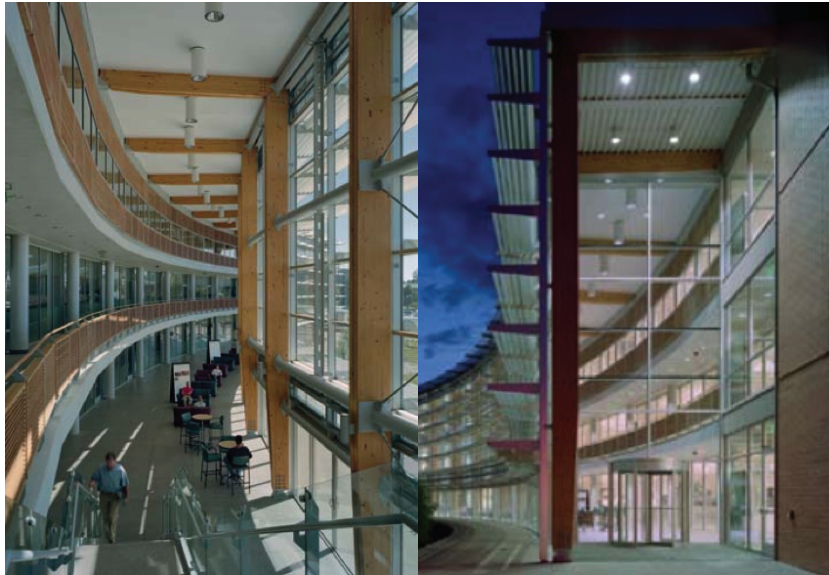

- RATED: 9/13

- THE HIGHEST LEED 'PLATINUM' RATINGS EVER

- REDUCTION OF **89% OF ENERGY** USE COMPARED TO A TYPICAL BUILDING

- RECYCLED BUILDING MATERIALS USED FOR **1/3 OF BUILDING**

SUSTAINABILITY:

LEADER IN THE INDUSTRY

- **COMMITTED TO ENVIRONMENTALLY ADVANCED DESIGN FOR OVER A DECADE**
- 1994 INLAND REVENUE CENTRE AT NOTTINGHAM
 - **FIRST BUILDING EVER CERTIFIED AS EXCELLENT UNDER THE BREEAM**
 - WON THE GREEN BUILDING OF 1996 AWARD
- 2008 RECEIVED BUILDING MAGAZINE'S **"SUSTAINABLE ARCHITECT OF THE YEAR" AWARD**

SUSTAINABILITY:

[HTTP://www.google.com/search?client=safari&rls=en&q=leed&oe=utf-8&um=1&ie=utf-8&hl=en&tbm=isch&source=og&sa=n&tab=wi&ei=ybb5udbvH5HOIGK26YDYAW&biw=829&bih=655&sei=y7B5UDAKHKWNIQKRv4HOBG#imgrc=g9JUB6BNLJDM6M%3A%3BF7VYGOQOGCLMKM%3BHTTP%253A%252F%252Fwww.englertinc.com%252Fimages%252Fstories%252Fleed.jpg%3BHTTP%253A%252F%252Fwww.englertinc.com%252Fnews-events%252Fleed-certification.html%3B640%3B360](http://www.google.com/search?client=safari&rls=en&q=leed&oe=utf-8&um=1&ie=utf-8&hl=en&tbm=isch&source=og&sa=n&tab=wi&ei=ybb5udbvH5HOIGK26YDYAW&biw=829&bih=655&sei=y7B5UDAKHKWNIQKRv4HOBG#imgrc=g9JUB6BNLJDM6M%3A%3BF7VYGOQOGCLMKM%3BHTTP%253A%252F%252Fwww.englertinc.com%252Fimages%252Fstories%252Fleed.jpg%3BHTTP%253A%252F%252Fwww.englertinc.com%252Fnews-events%252Fleed-certification.html%3B640%3B360)

[HTTP://www.google.com/search?client=safari&rls=en&q=breeam+certification&oe=utf-8&um=1&ie=utf-8&hl=en&tbm=isch&source=og&sa=n&tab=wi&ei=j7B5UFTBHYL2IGKB44GAAG&biw=829&bih=655&sei=kBB5UYU-L4QCIQLTUOCGAG#imgrc=hqaxc4JXVA600M%3A%3BP2PFHFRK4STVYM%3BHTTP%253A%252F%252Fwww.breeam.org%252Ffilelibrary%252Fbreeam%252520awards%252Fbreeam_awards2012winner.png%3BHTTP%253A%252F%252Fwww.breeam.org%252Fpage.jsp%253Fid%253D470%3B178%3B213](http://www.google.com/search?client=safari&rls=en&q=breeam+certification&oe=utf-8&um=1&ie=utf-8&hl=en&tbm=isch&source=og&sa=n&tab=wi&ei=j7B5UFTBHYL2IGKB44GAAG&biw=829&bih=655&sei=kBB5UYU-L4QCIQLTUOCGAG#imgrc=hqaxc4JXVA600M%3A%3BP2PFHFRK4STVYM%3BHTTP%253A%252F%252Fwww.breeam.org%252Ffilelibrary%252Fbreeam%252520awards%252Fbreeam_awards2012winner.png%3BHTTP%253A%252F%252Fwww.breeam.org%252Fpage.jsp%253Fid%253D470%3B178%3B213)

[HTTP://www.hopkins.co.uk/s/practice/people/#226](http://www.hopkins.co.uk/s/practice/people/#226)

[HTTP://www.hopkins.co.uk/USR/Downloads/projects/pdf_s/sustainable_by_design_small.pdf](http://www.hopkins.co.uk/USR/Downloads/projects/pdf_s/sustainable_by_design_small.pdf)

[HTTP://www.hopkins.co.uk/USR/Library/Documents/Main/2011-sustainability.pdf](http://www.hopkins.co.uk/USR/Library/Documents/Main/2011-sustainability.pdf)

[HTTP://www.hopkins.co.uk/s/practice/sustainability/](http://www.hopkins.co.uk/s/practice/sustainability/)

[HTTP://www.hopkins.co.uk/s/projects/2/90/](http://www.hopkins.co.uk/s/projects/2/90/)

[HTTP://www.hopkins.co.uk/s/projects/2/111](http://www.hopkins.co.uk/s/projects/2/111)

[HTTP://www.youtube.com/watch?v=xurxy8pz5ay&feature=related](http://www.youtube.com/watch?v=xurxy8pz5ay&feature=related)

[HTTP://books.google.com/books?id=pzW41A4RQSUC&pg=PA19&lpg=PA19&dq=reasons+why+hopkins+architects+are+sustainable+designers&source=bl&ots=yQH6ZYYD8A&sig=qxU7RMYXQEDOABRPBX9OYKRskC8&hl=en&sa=x&ei=M694UE6OBoF1IGLQRYGADG&ved=0CEKQ6AEWBA#v=onepage&q=reasons%20why%20hopkins%20architects%20are%20sustainable%20designers&f=false](http://books.google.com/books?id=pzW41A4RQSUC&pg=PA19&lpg=PA19&dq=reasons+why+hopkins+architects+are+sustainable+designers&source=bl&ots=yQH6ZYYD8A&sig=qxU7RMYXQEDOABRPBX9OYKRskC8&hl=en&sa=x&ei=M694UE6OBoF1IGLQRYGADG&ved=0CEKQ6AEWBA#v=onepage&q=reasons%20why%20hopkins%20architects%20are%20sustainable%20designers&f=false)