

A Day in the Life of
the
Cause and Effect
Machine

Brilliant!

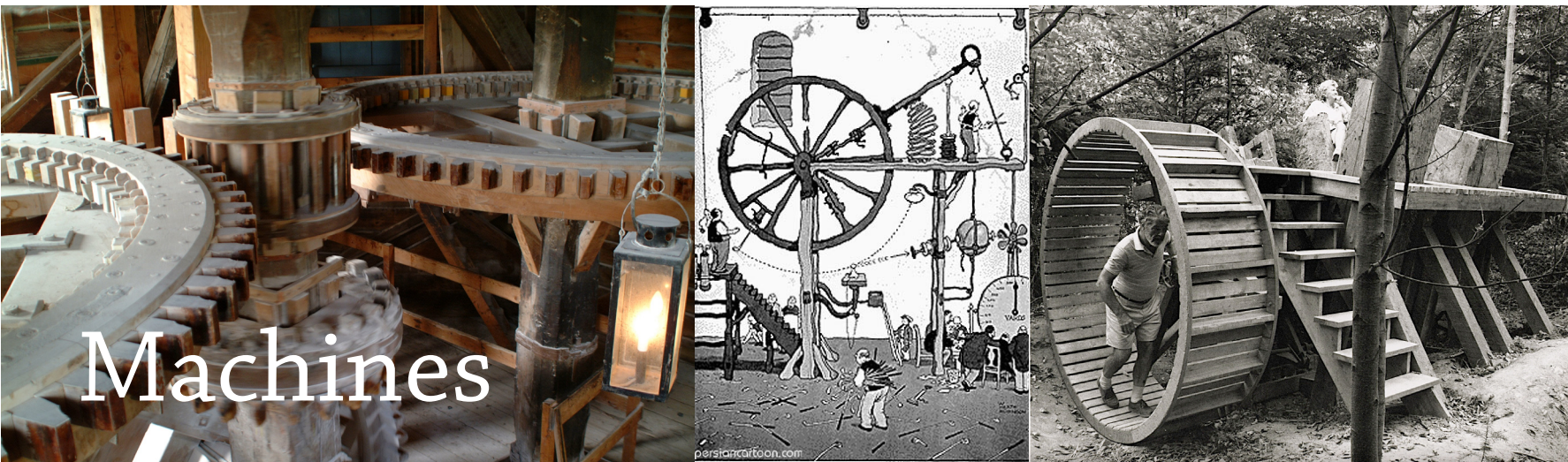

Inspiration



Inspiration



Mechanisms



Leaves

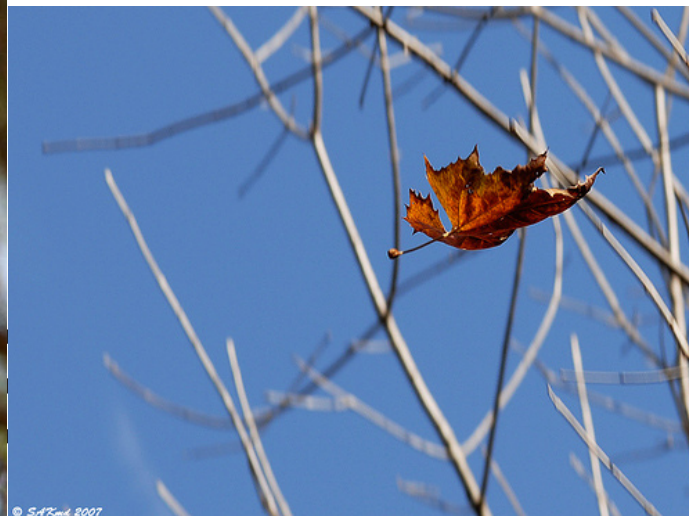

Core Concepts

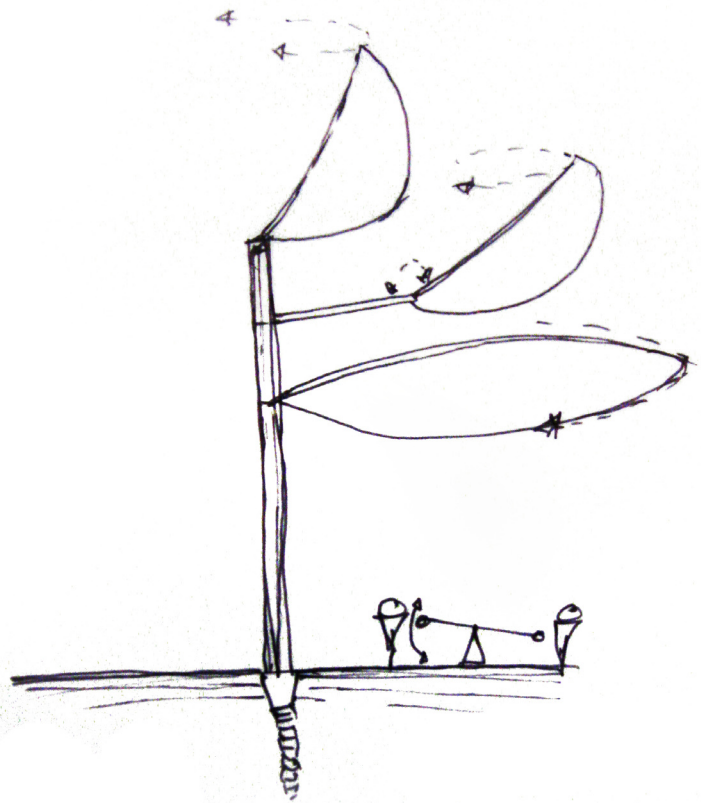

Adaptability

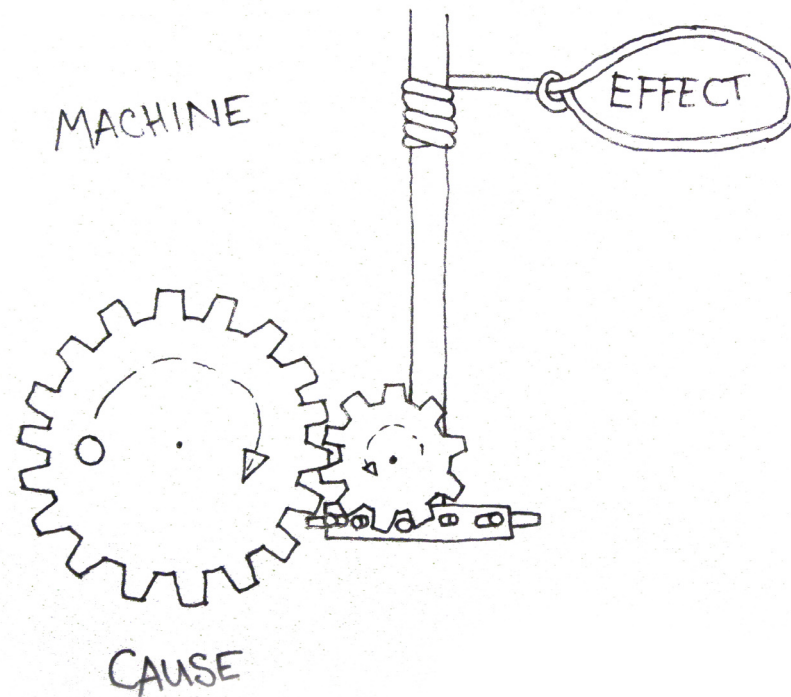

Interactivity

Core Concepts

hmm...

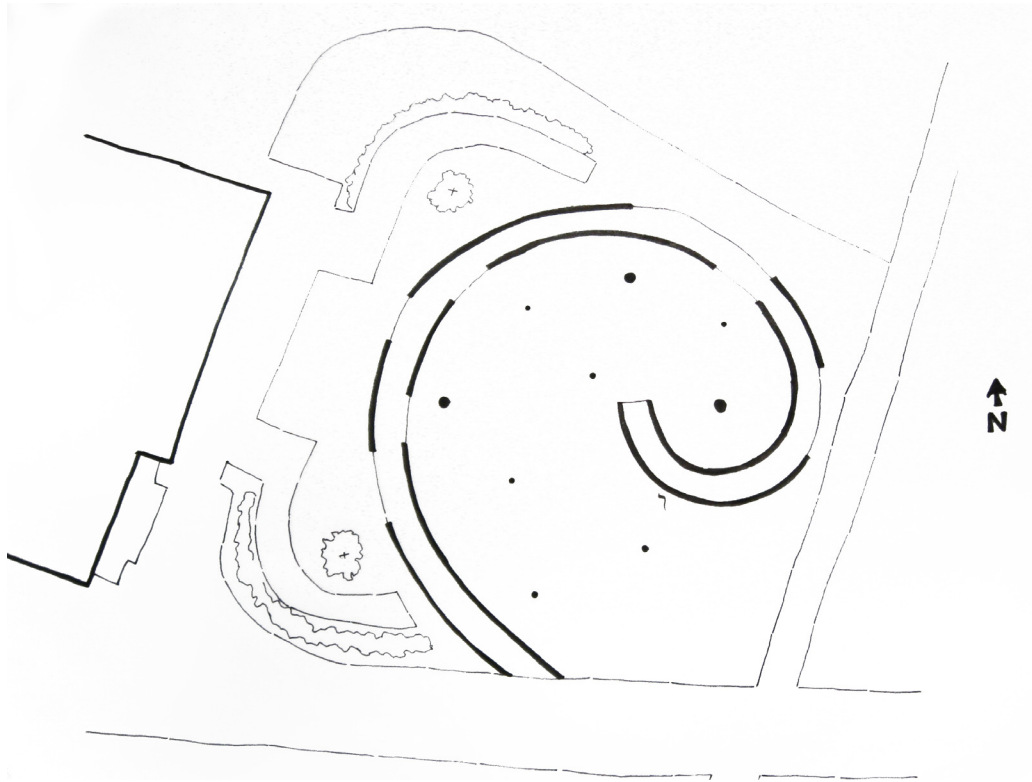

Enclosure

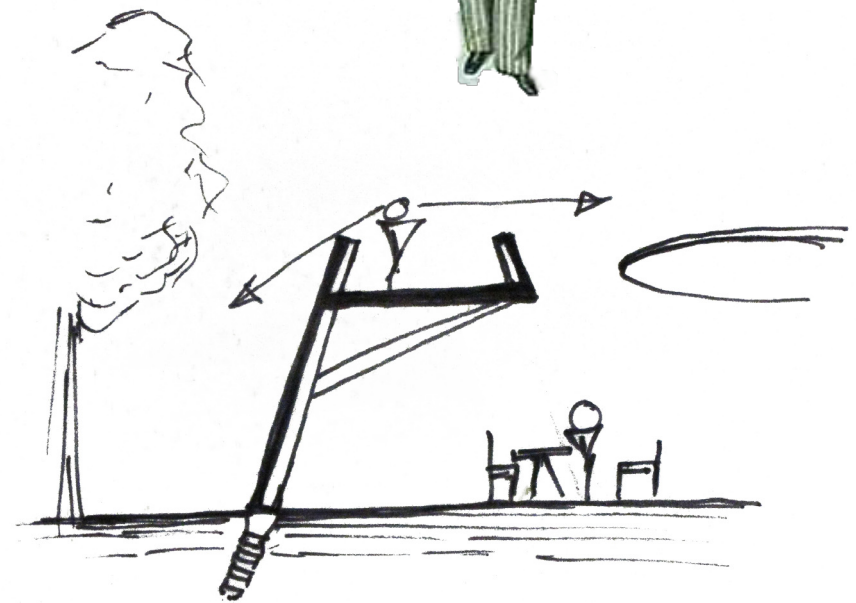

Levels

Space Adaptation

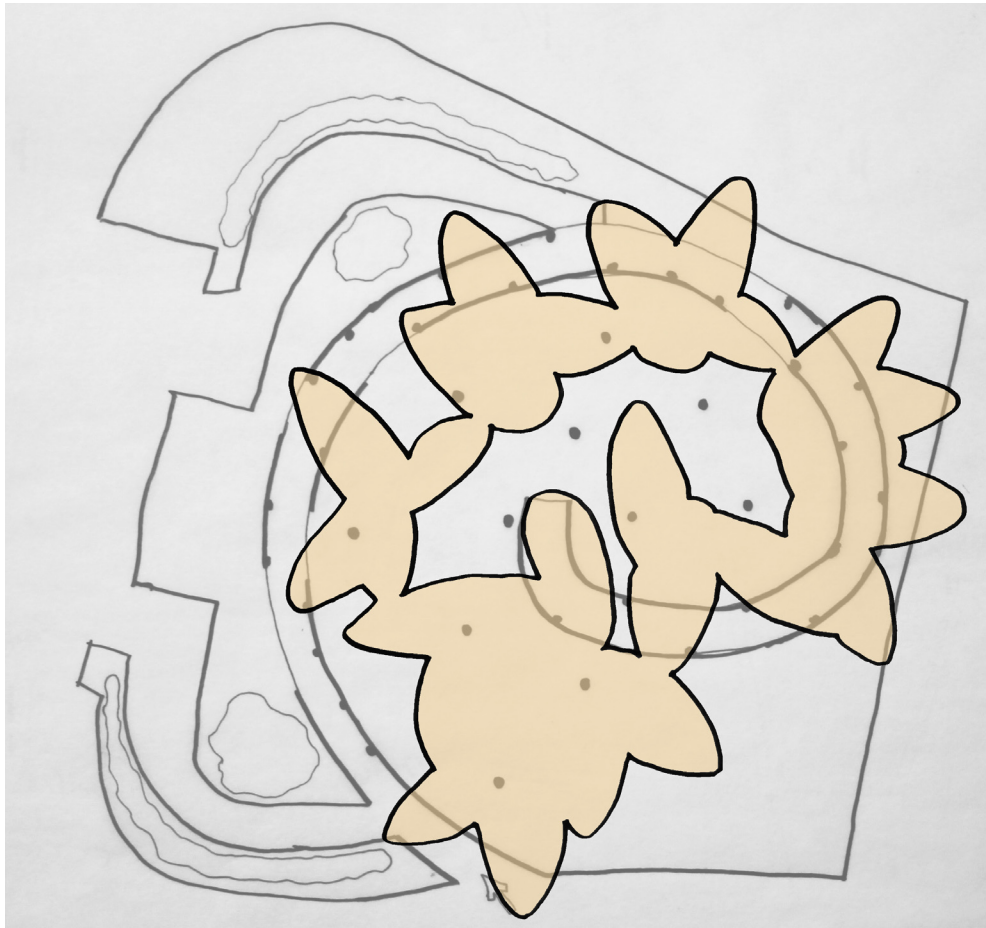

Shading with fins opened

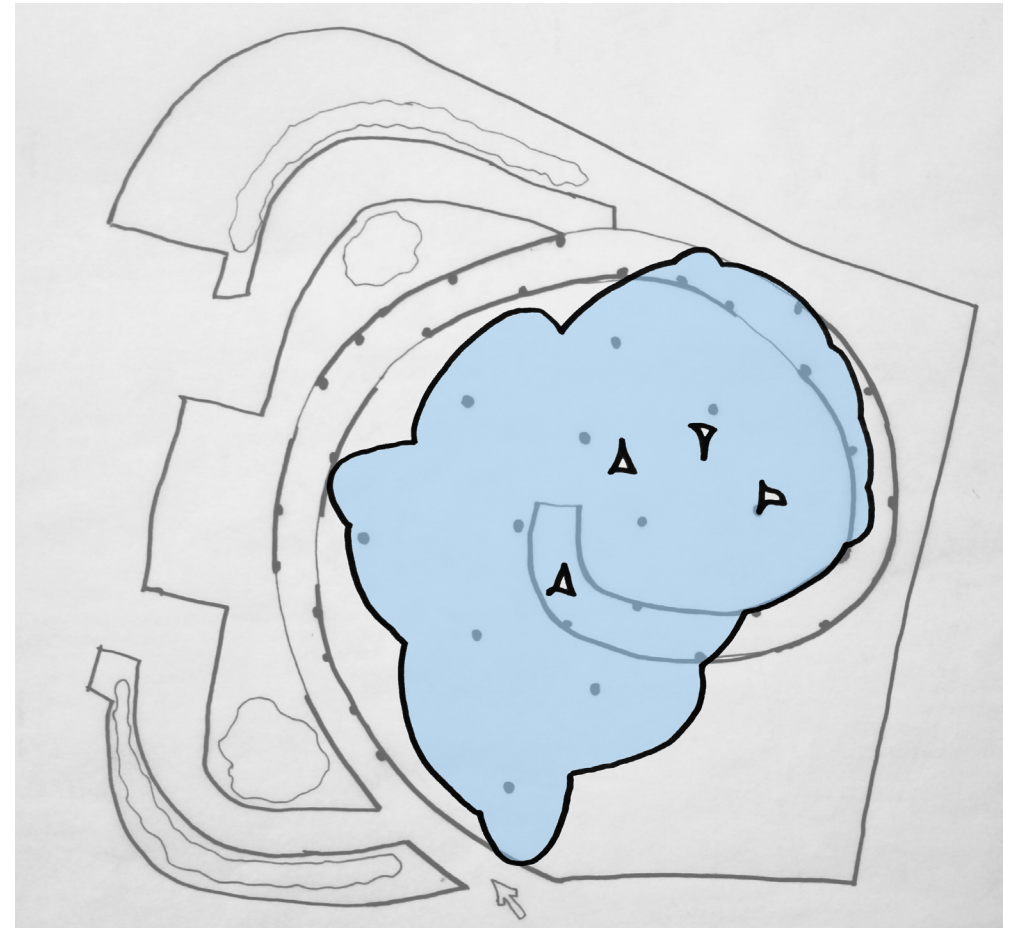

Shading with fins lapped

Section

Mechanism

Canvas Fin

Reclaimed Timber Cladding

Supporting Structure

Screw-Pile Foundations



The
Journey
Begins



Meet Little Johnny and his red balloon. One day, Johnny decides to go for a walk, and he stumbles upon a fantastic machine in the park.



Little Johnny and his red balloon approach the machine to explore. There are all kinds of fantastic pulleys and wheels, and great fins overhead which move to change the light and shadows.

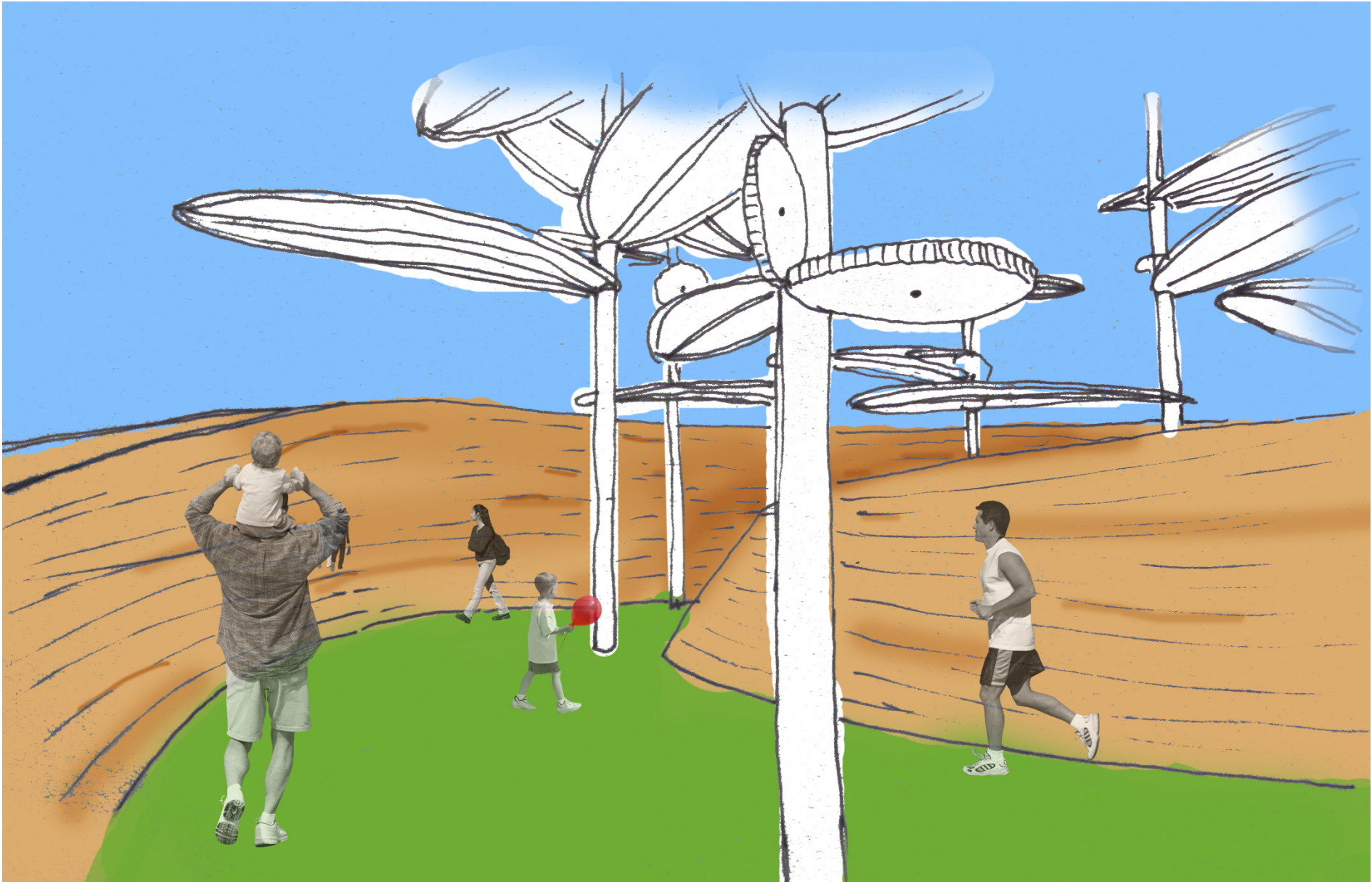

Little Johnny heads up the curious looking ramp,
excited to see what awaits him at the top.

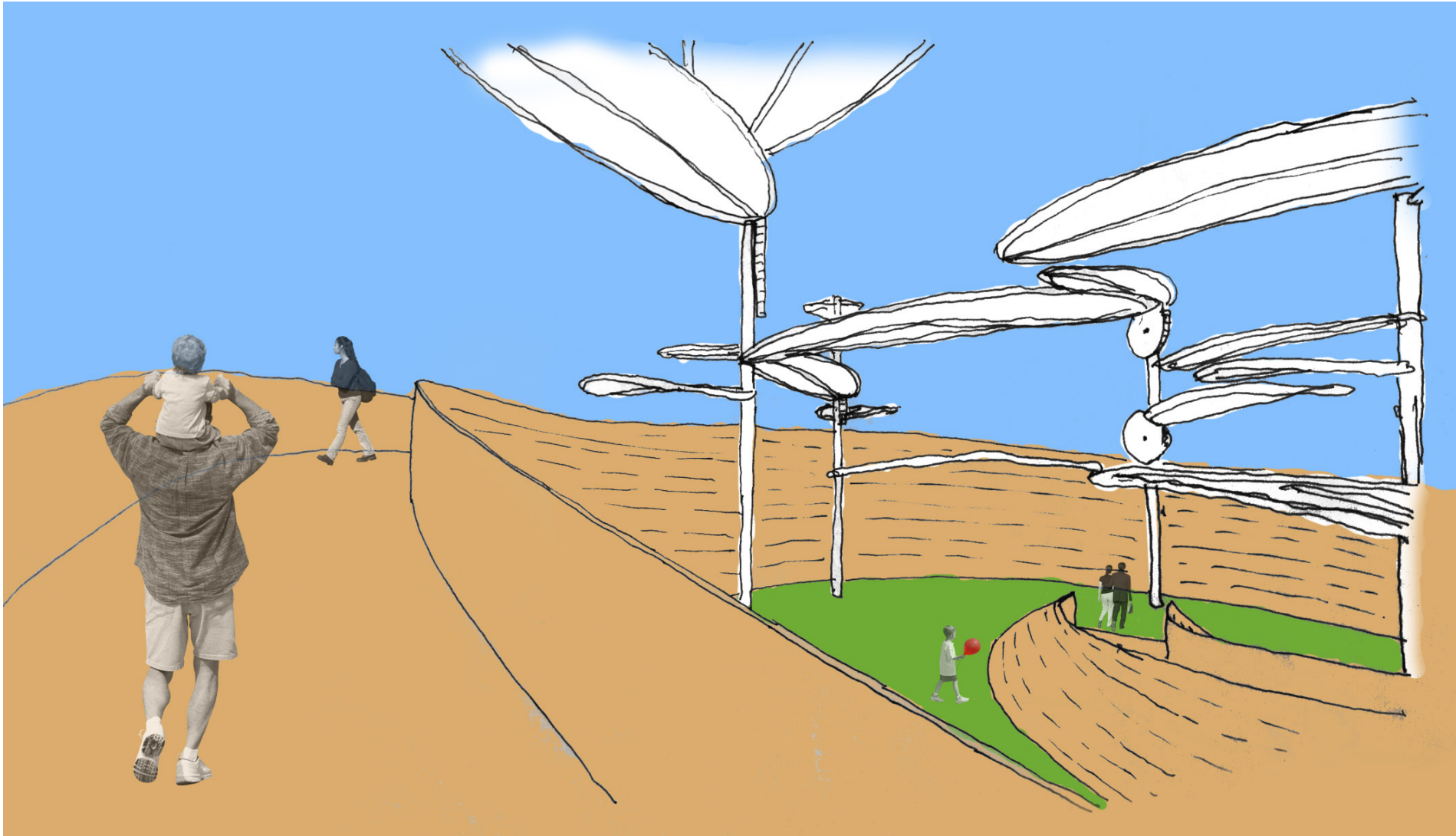

Other children are turning massive cranks and levers, which operate the fins. Little Johnny is excited to watch the fins as they rotate below while he runs the crank.

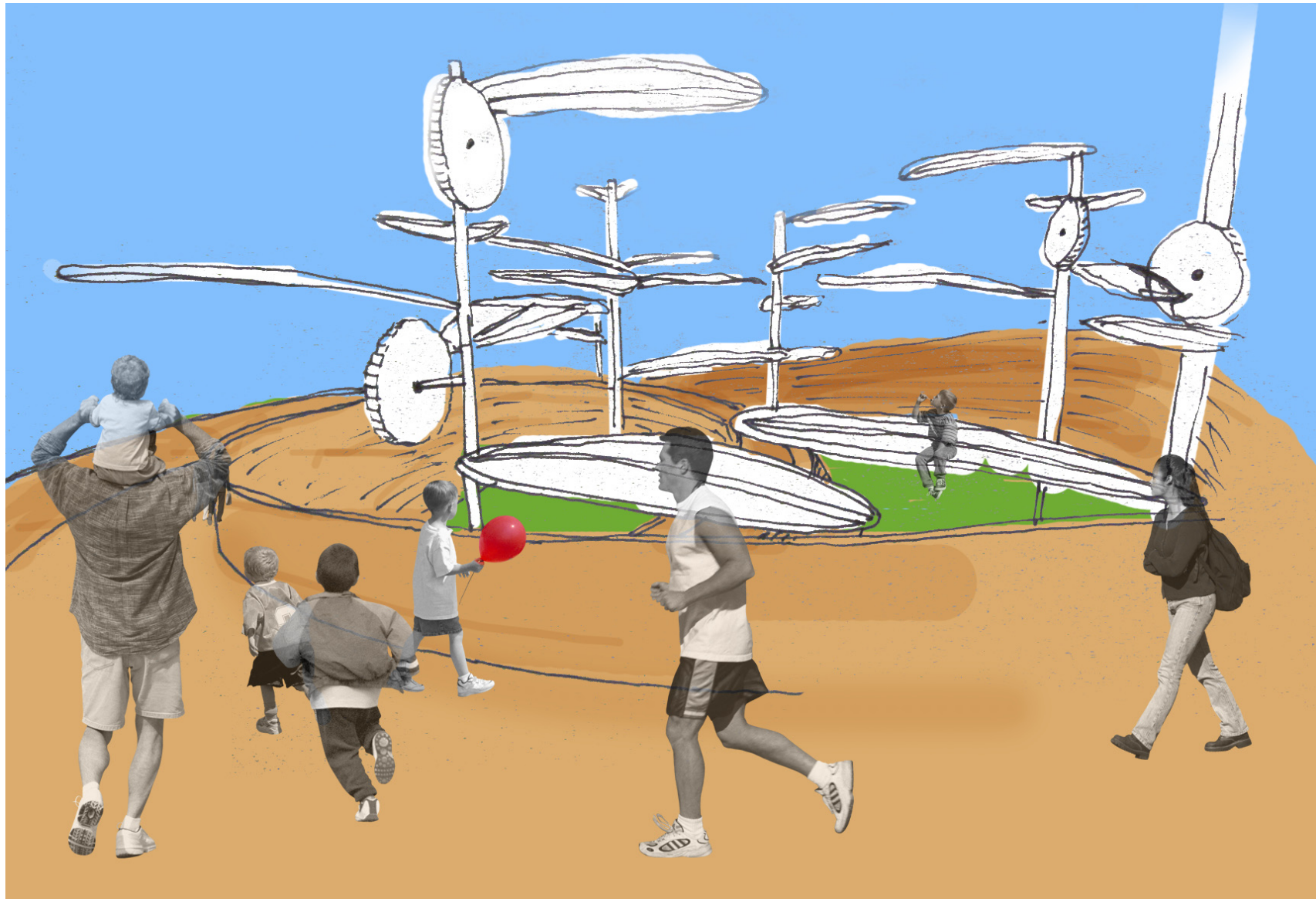

Satisfied with his new arrangement, Little Johnny and his red balloon descend the ramp and are greeted at the bottom with an ice cream and a relaxing nap in the cool grass.



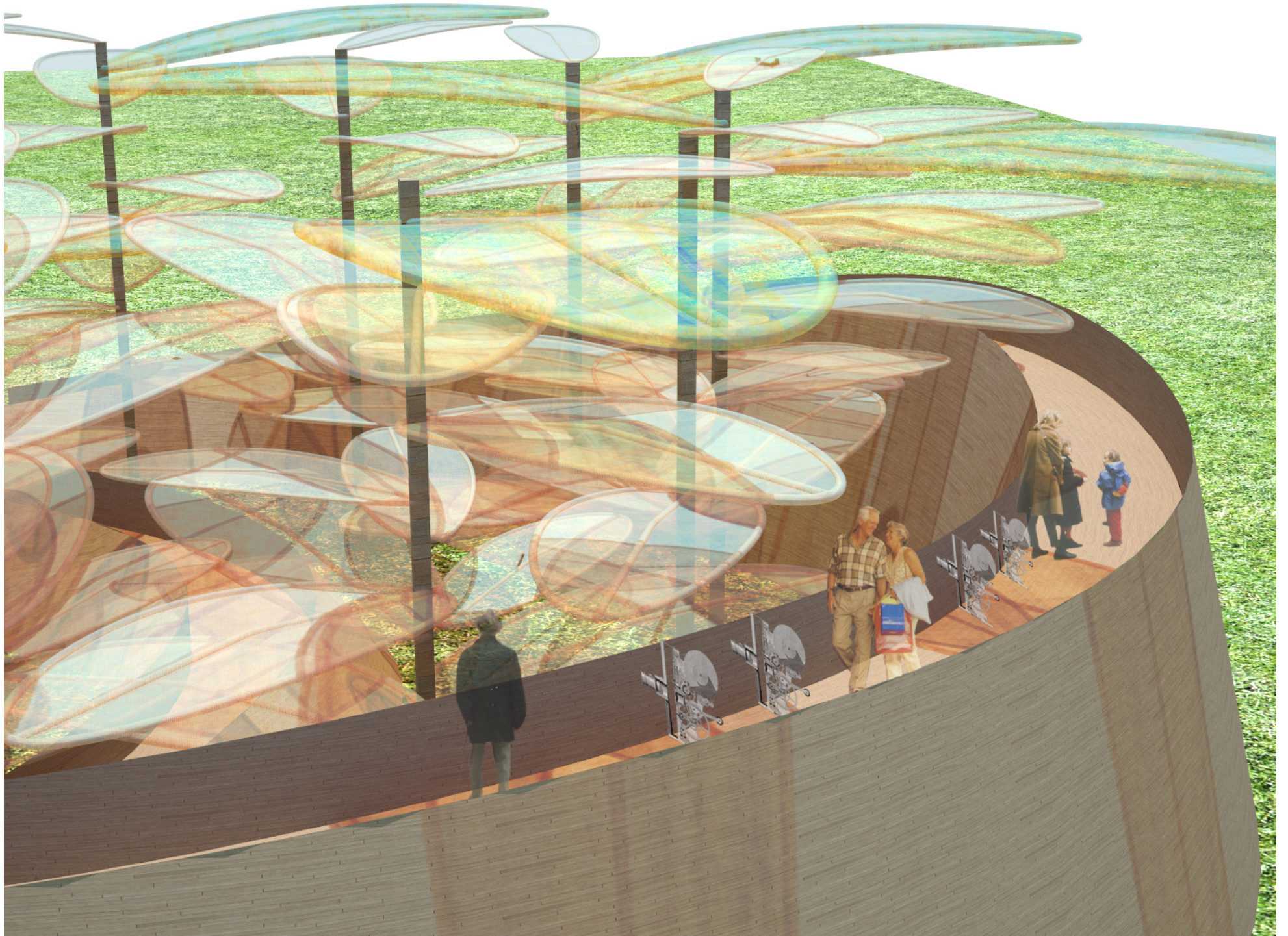



Questions?

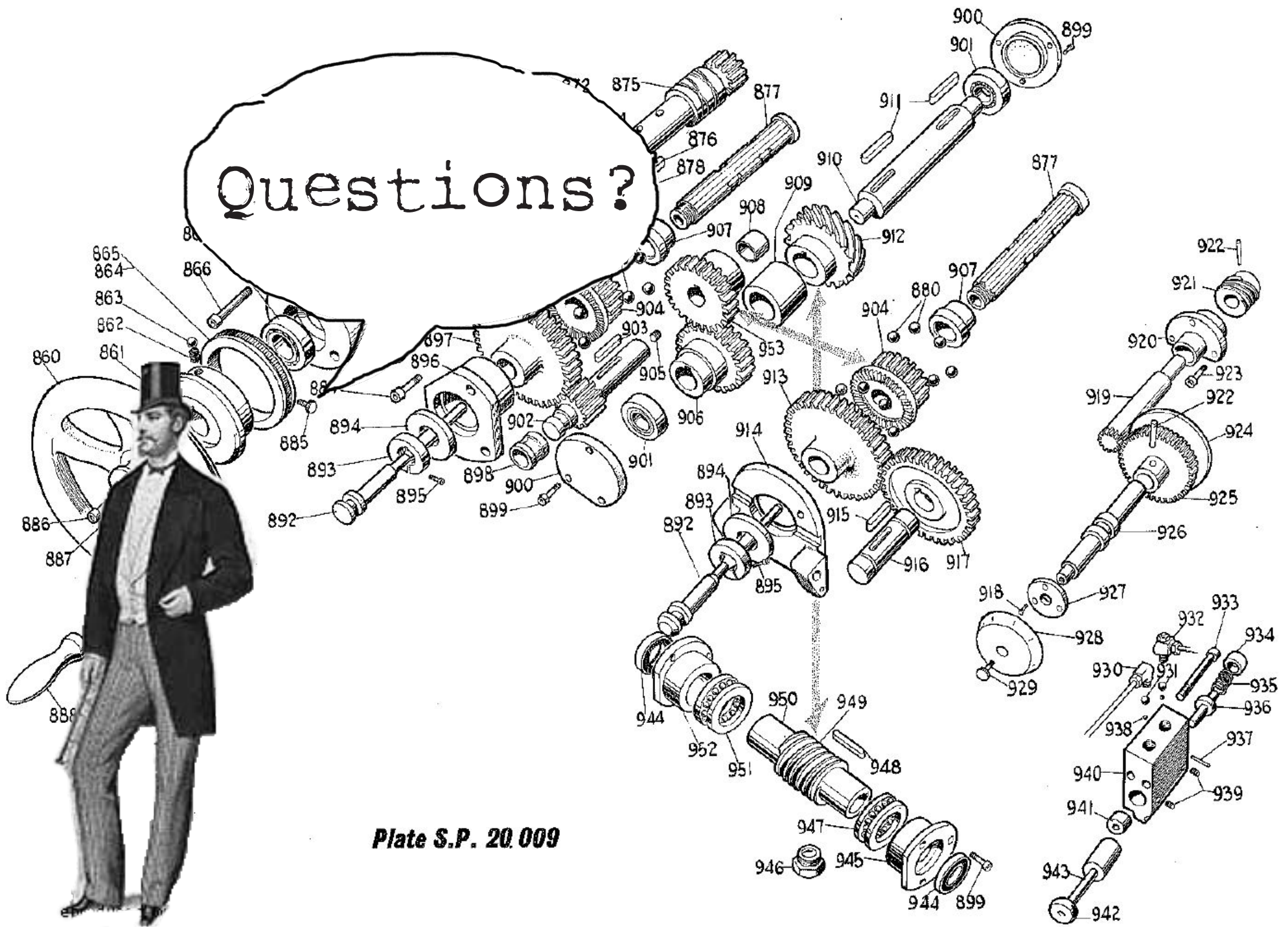

Plate S.P. 20.009