



**SUN PATH:**  
HYDE PARK CONDENSED

Emily Eixenberger

Mike Garrett

Jeremiah Long

Amanda Ryan

And Edward Cullinan Architects

# Site Conditions

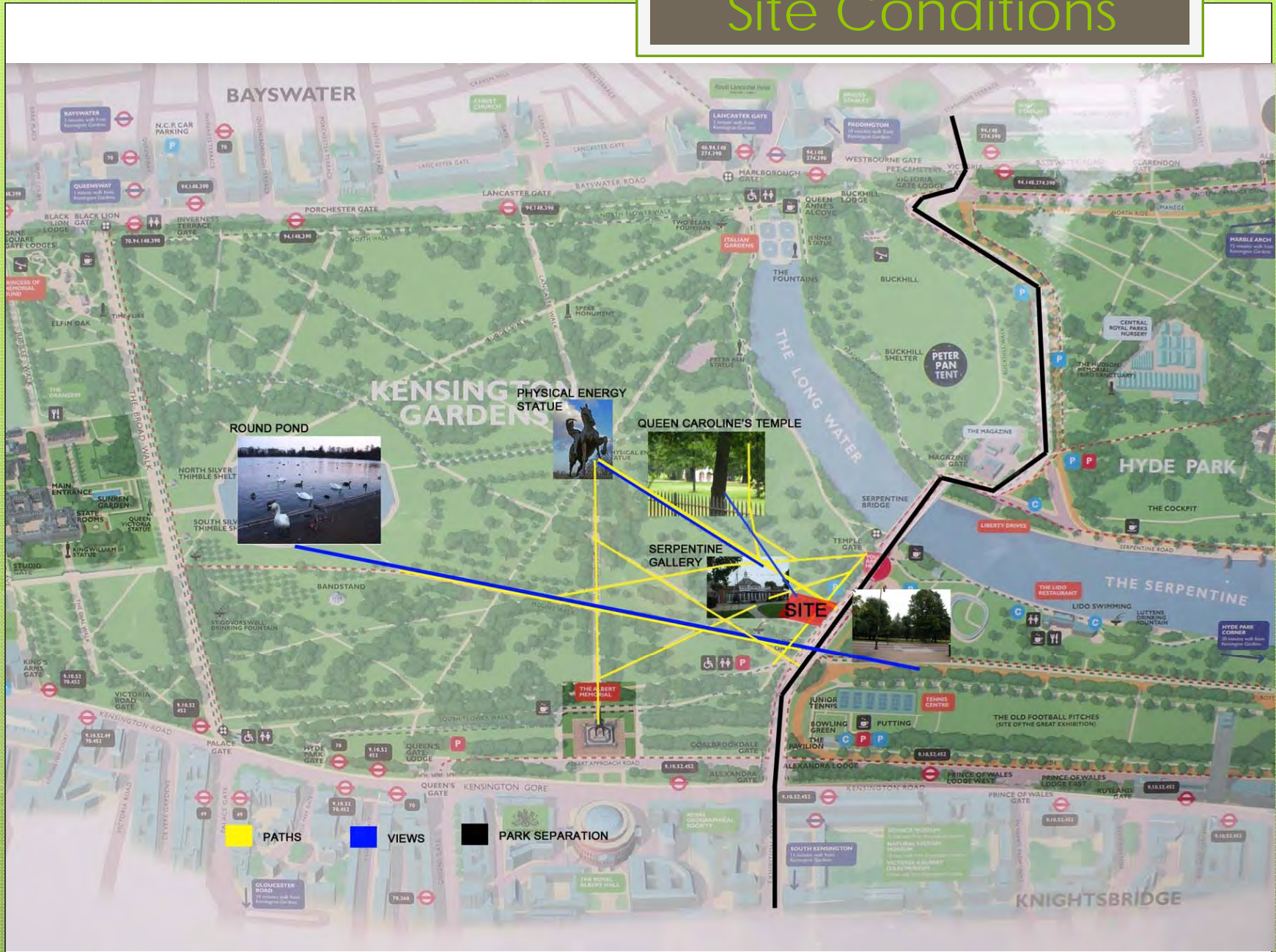

# Design Intentions

## Program Intentions:

Sustainable  
Temporary  
Education  
Assembly

## Design Intentions:

### Social

Meeting space of connection  
All the many paths of people, although different come dependent on one thing, the earth  
Linking Kensington Gardens and Hyde Park

### Economic

Reusable  
Modular / Modifiable  
Stand Alone – Can be bought in pieces as needed

### Environmental

Reusable / movable  
Sustainability isn't Temporary  
Solar Path Connection  
Solar panels that move to the sun

## Site Conditions:

Disconnected Parks  
Many Pedestrian Paths  
Views of Park Landmarks

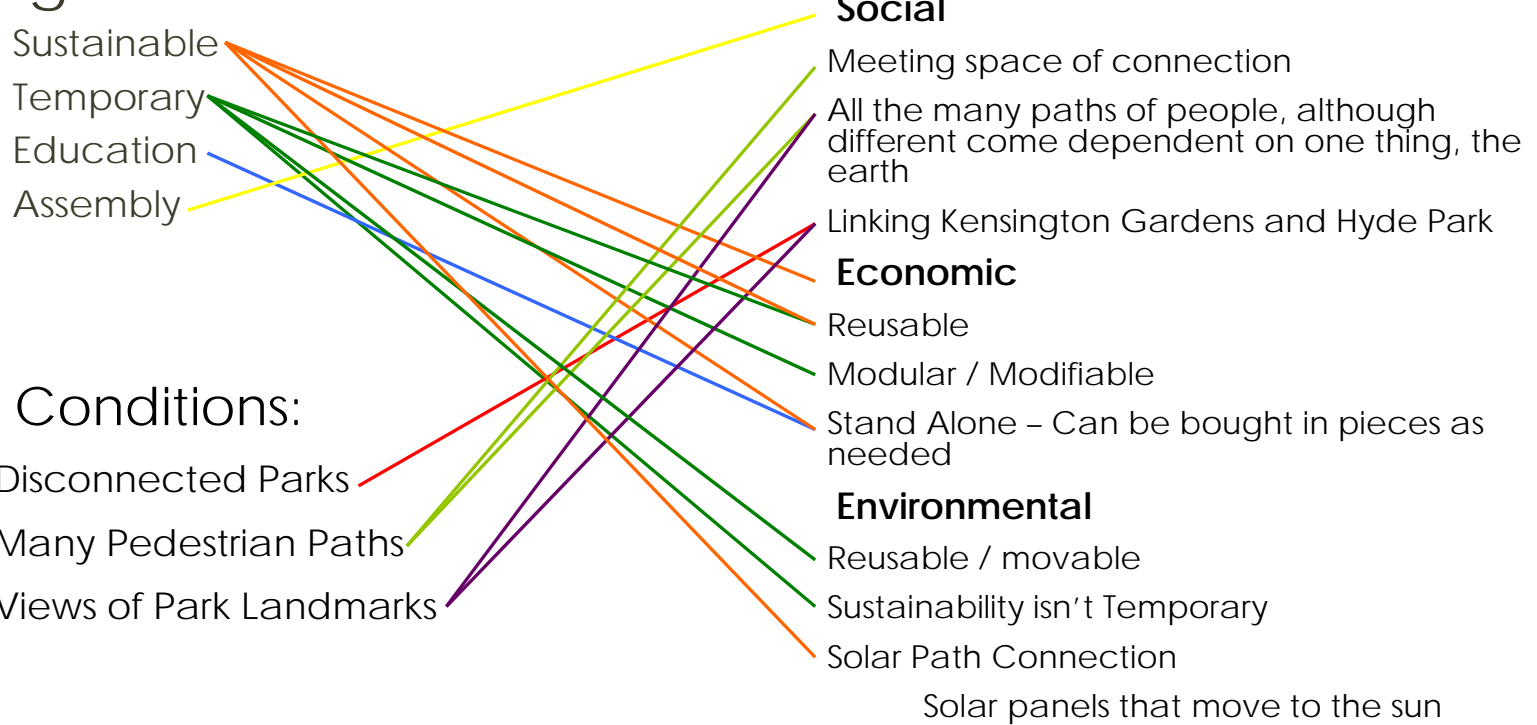

# Design Concepts

An intrigue of possibilities through reflection

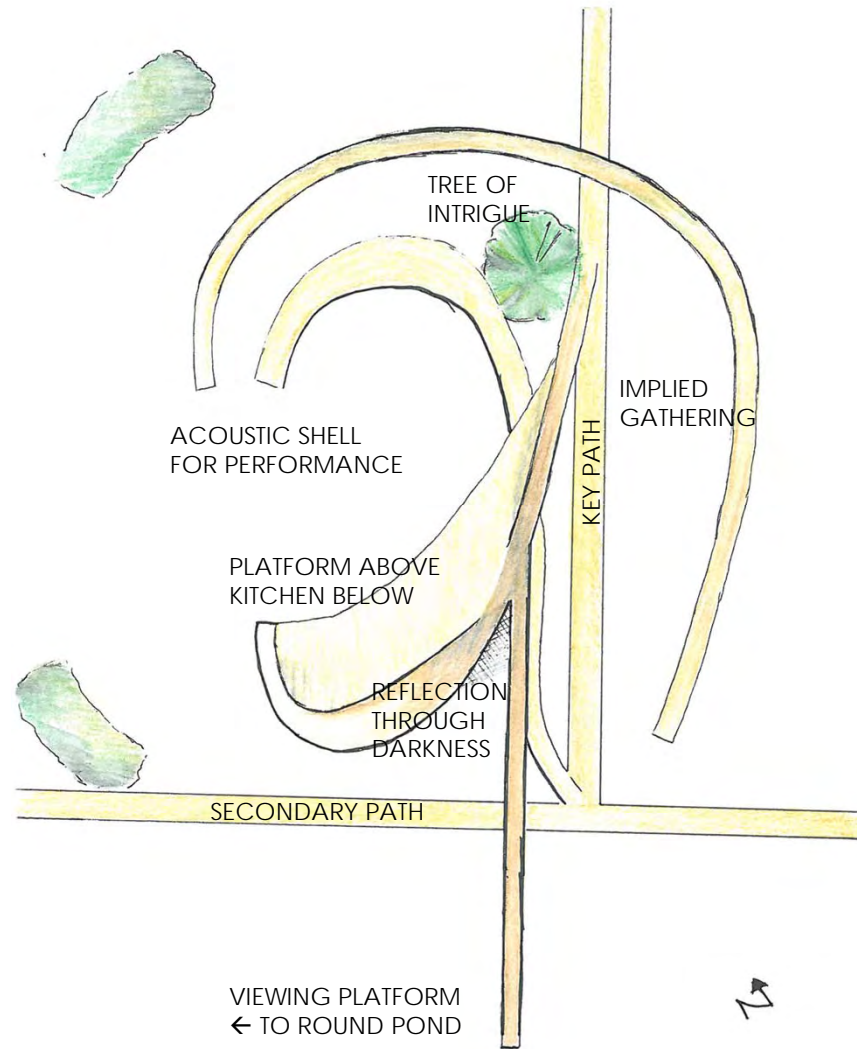
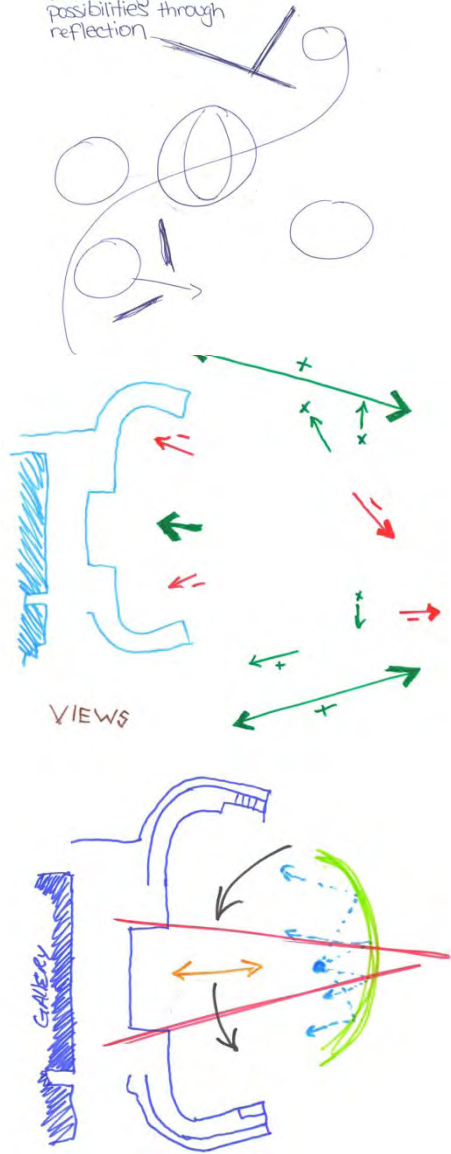

# Solar Relationships

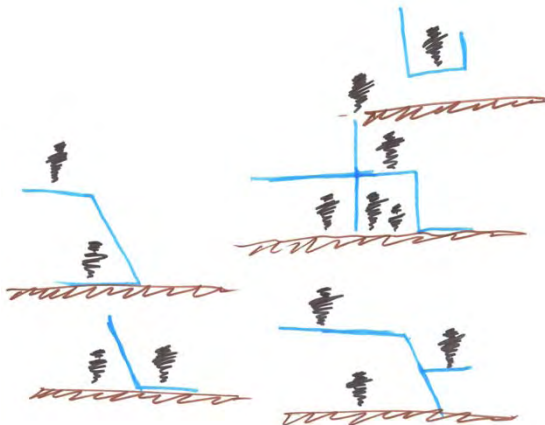
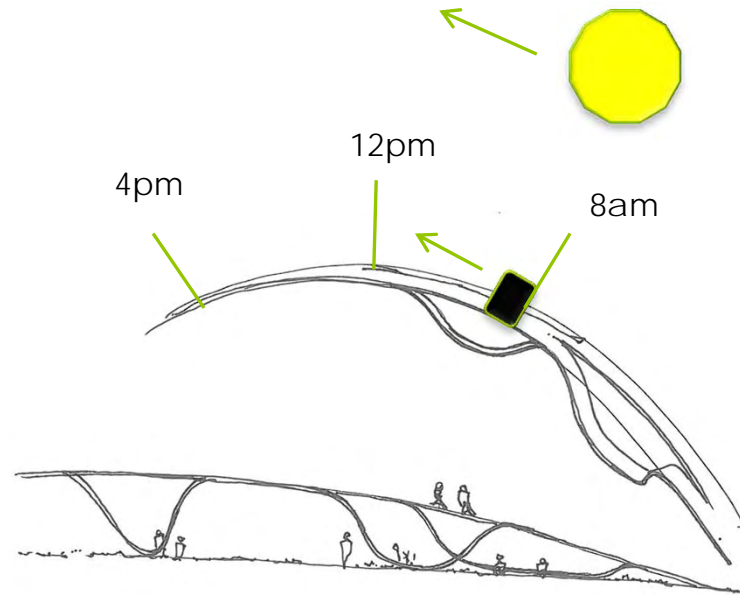
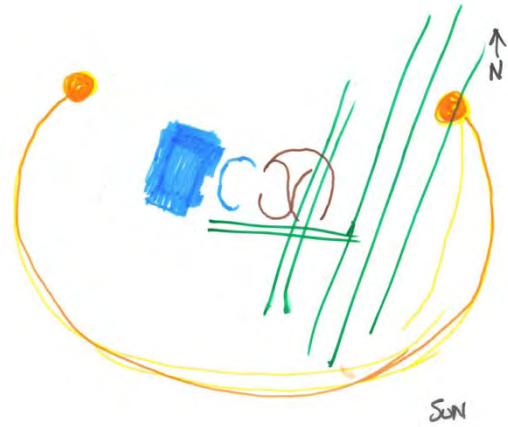

• IMPATH

Educational Solar Cell

# Entry from South

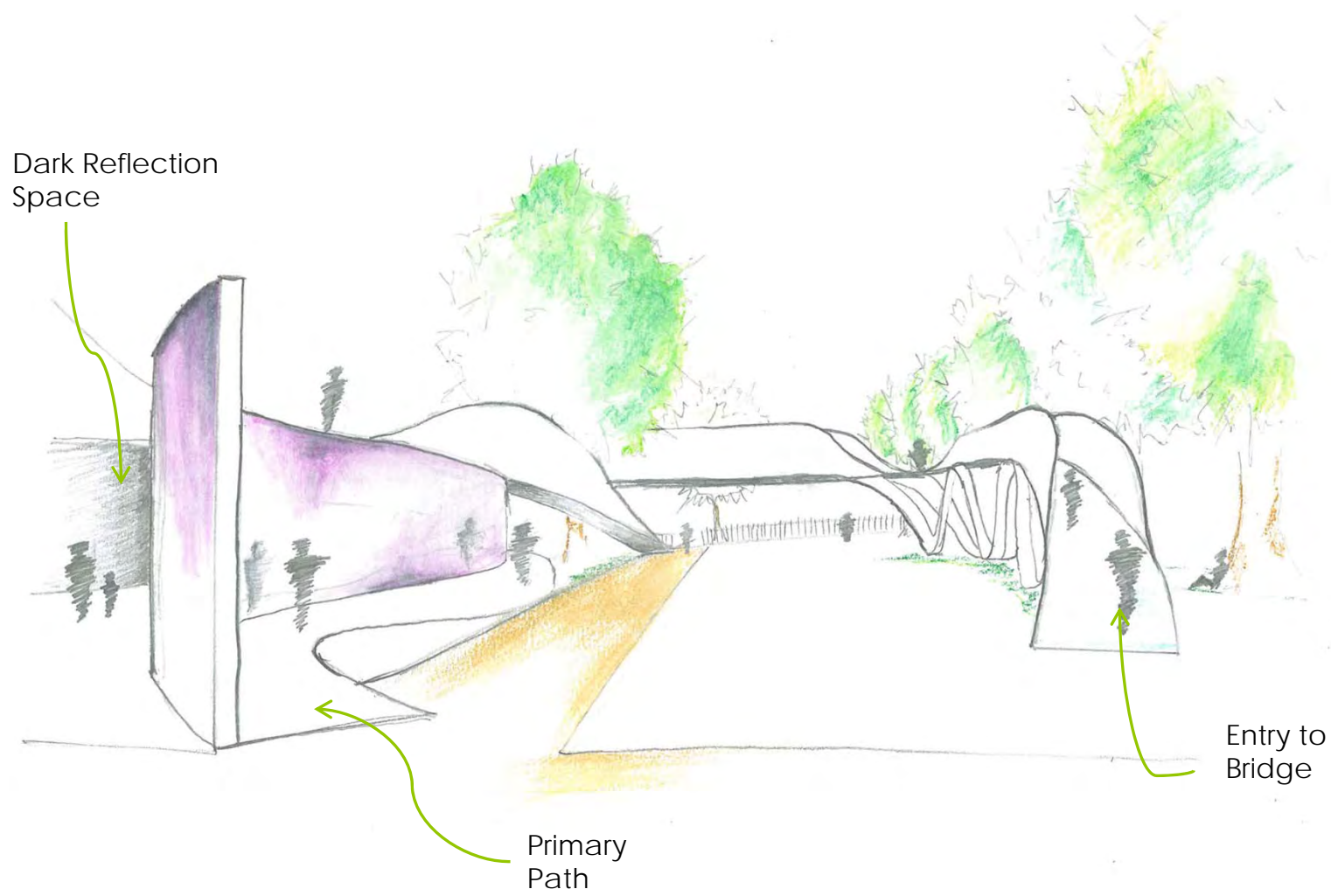

# Entry from North

Bridge of Surroundings

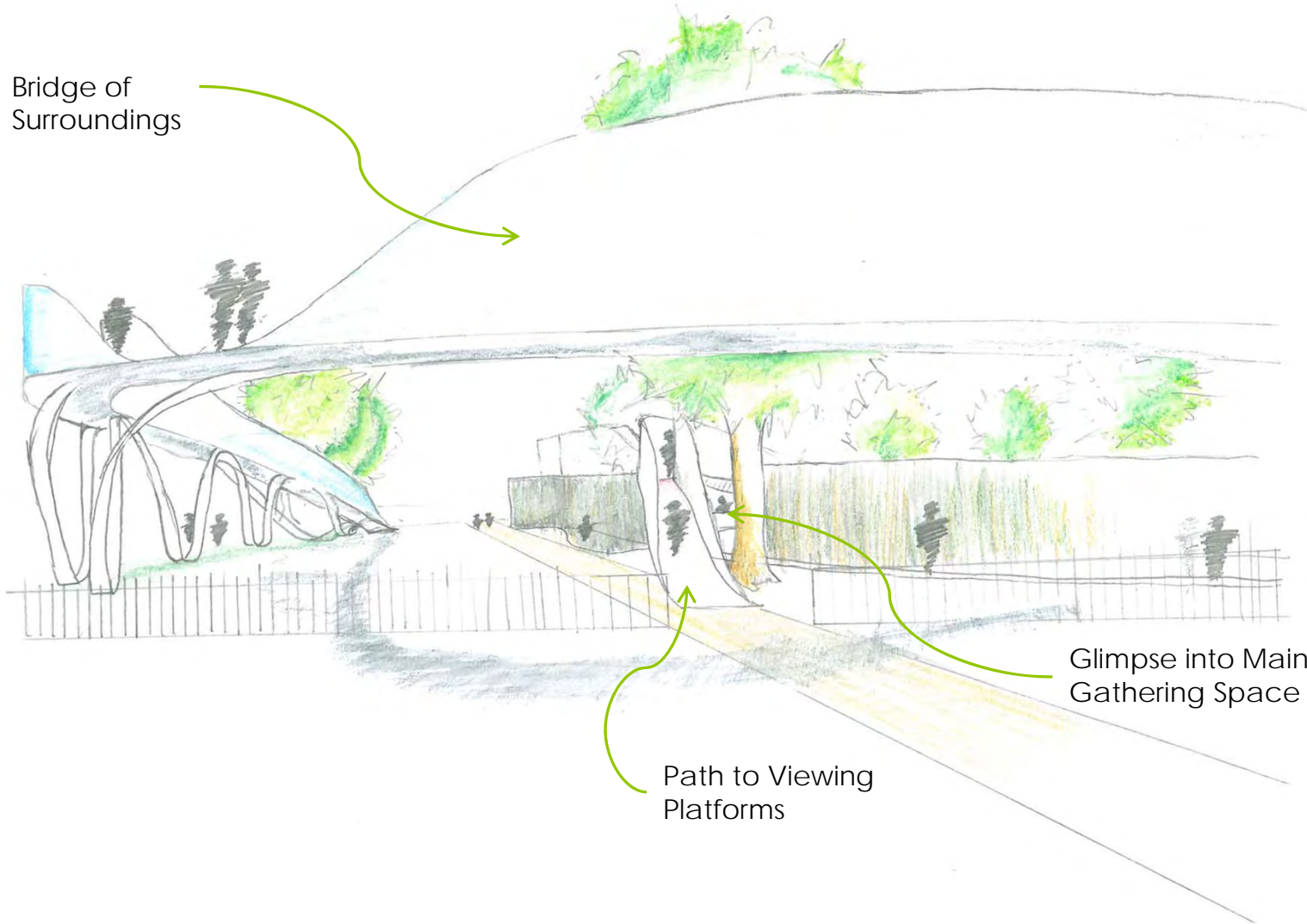

Glimpse into Main Gathering Space

Path to Viewing Platforms

# Main Gathering

Interactive Solar Wall

Interactive Roof

Food Services

Serpentine Gallery

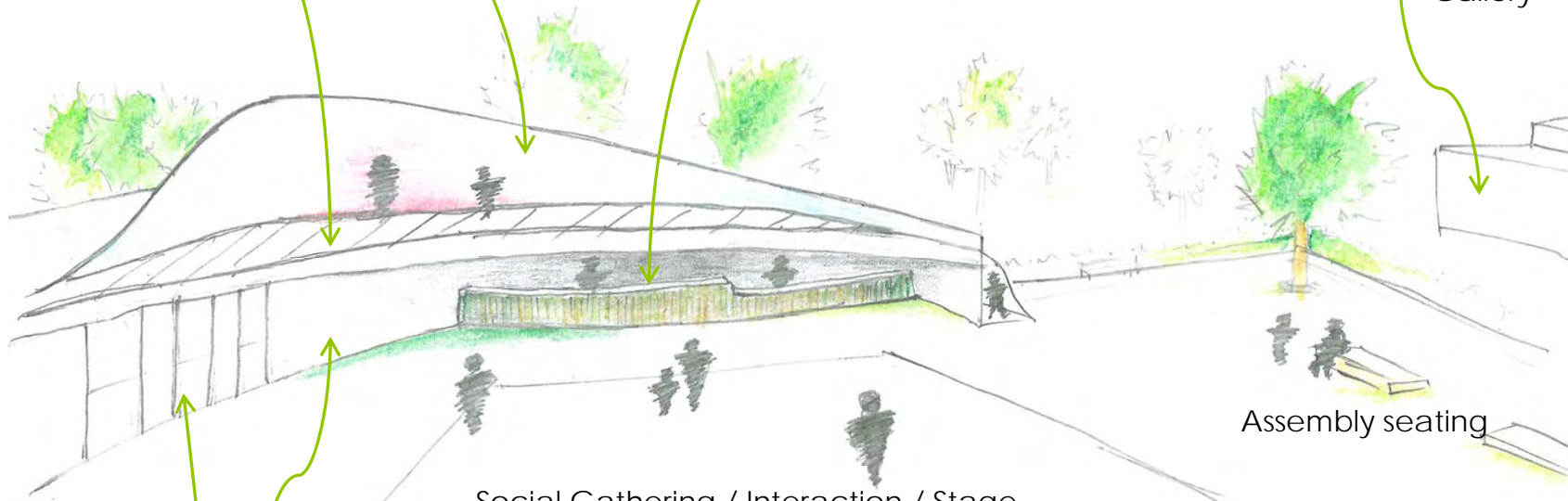

Further Interaction Options

Acoustic Shell

Social Gathering / Interaction / Stage

Assembly seating



# Overall Design

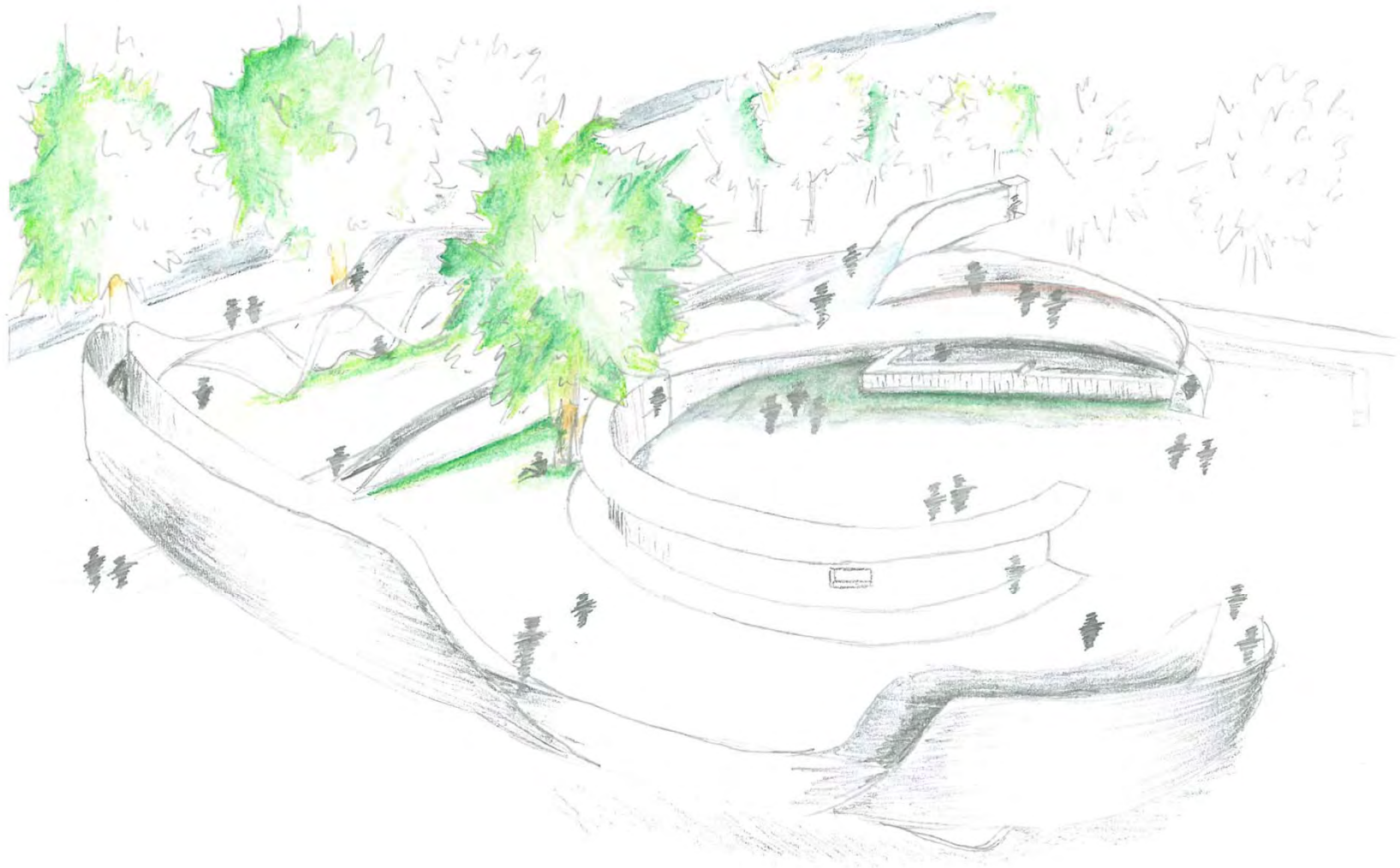

# Assembly Diagrams

Modular Panels Connection Possibilities

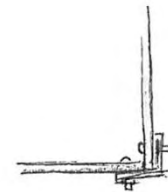
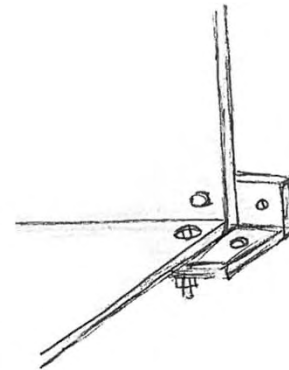
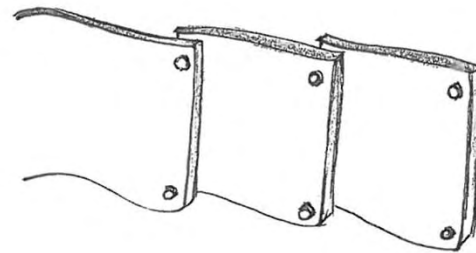
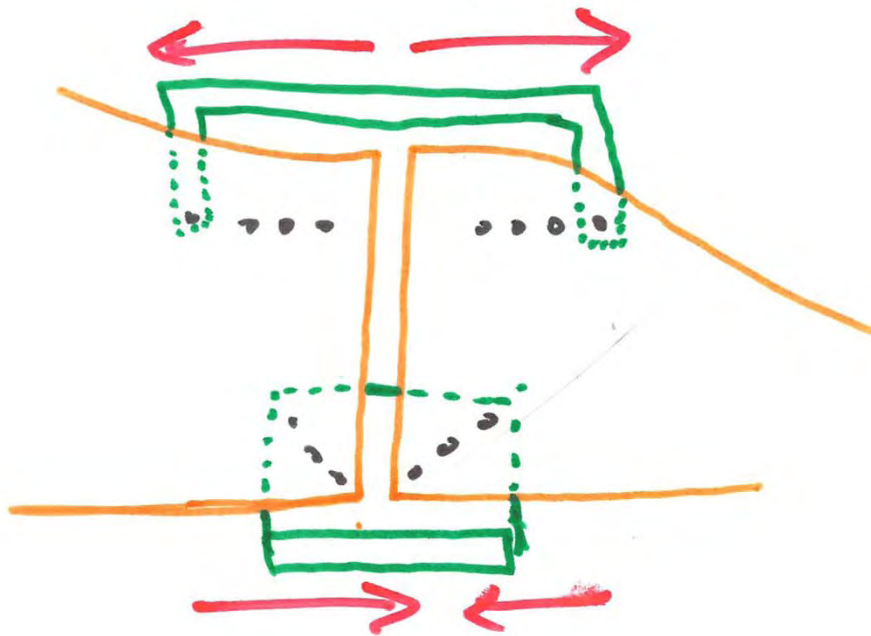

## Post Serpentine Use

- Sustainability is not stored in a warehouse. Therefore, stand alone elements – can be purchased separately as needed.

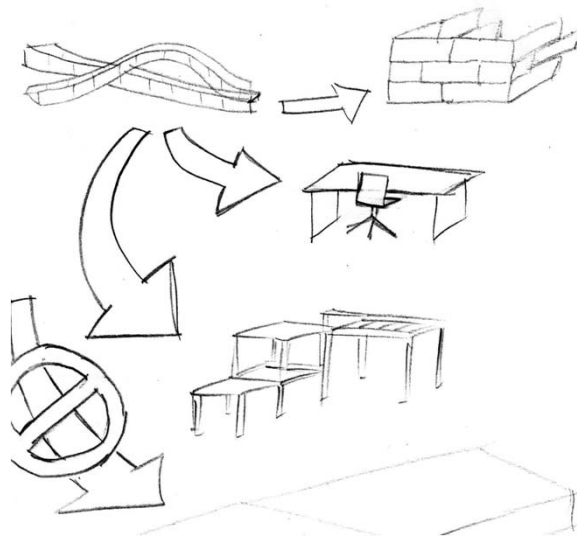

Options for the individual panels to be reused

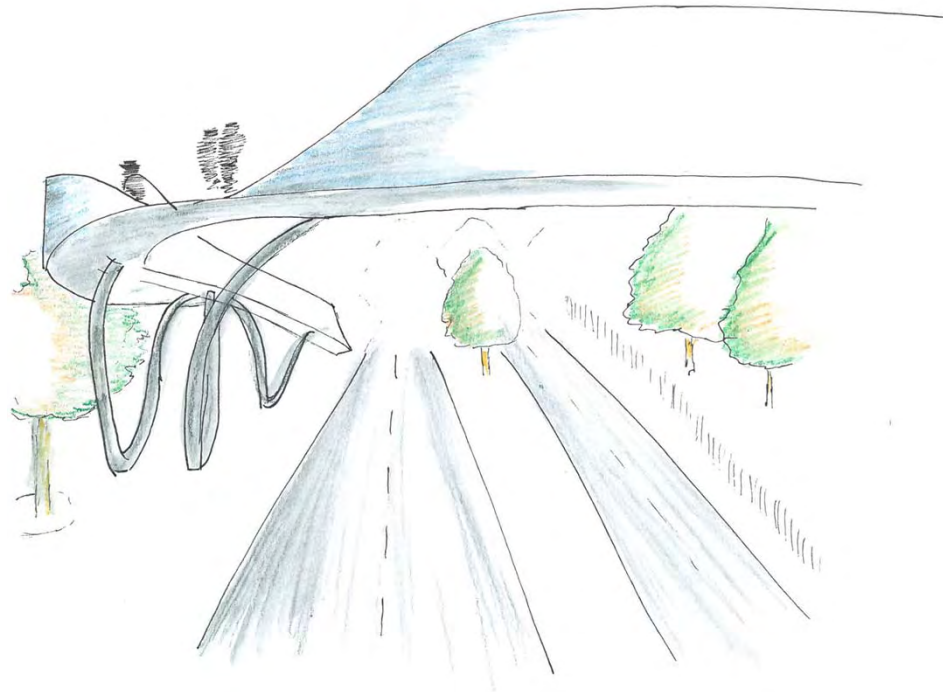

Rotating the ramp over the road creates a safe pedestrian path between Kensington Gardens and Hyde Park