



# G E O D E

PROPOSAL FOR A SUSTAINABLE SERPENTINE PAVILION

**UNIVERSITY OF IDAHO | ANGLIA RUSKIN UNIVERSITY | HOSTED BY CULLINAN STUDIO**

MEGHAN BALLOCK | KELTON BERRETT | RYAN ERSTAD | JESSICA FARIA DE SOUZA

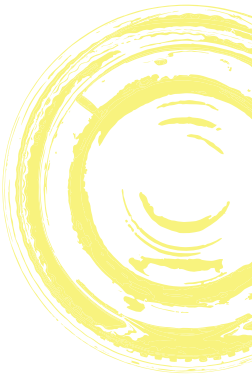
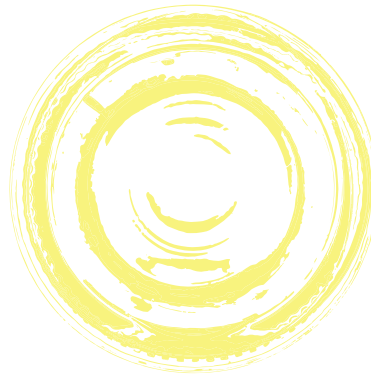

# CONCEPTUAL BEGINNINGS

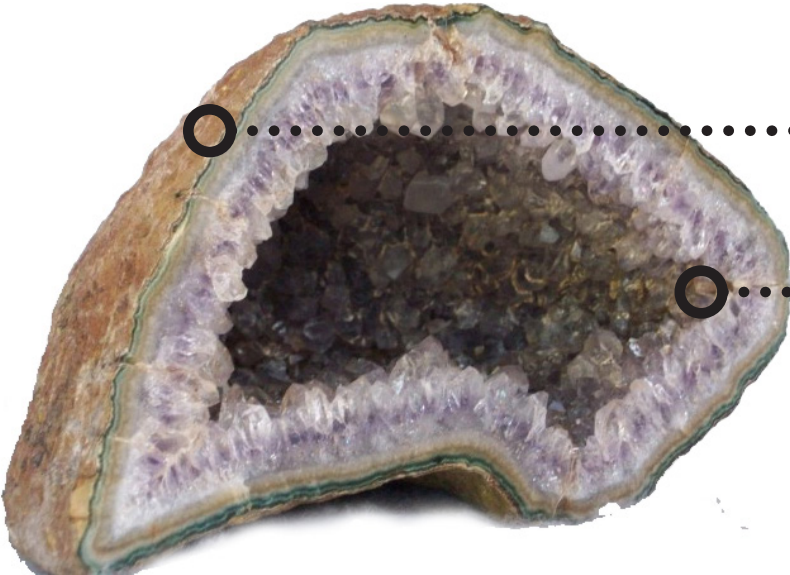

HARD, UTILITARIAN EXTERIOR



SPARKLING, DELICATE INTERIOR

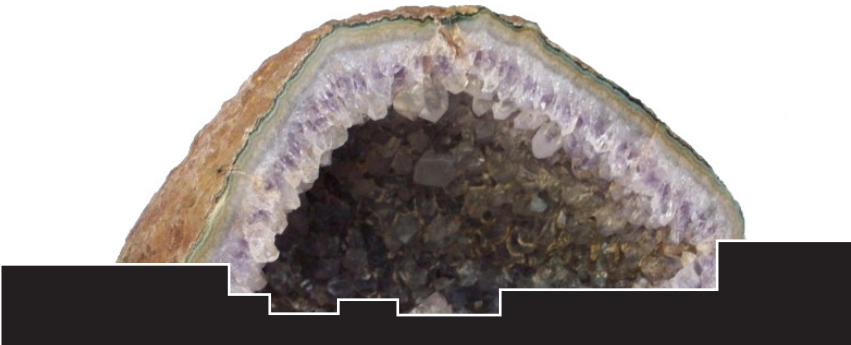
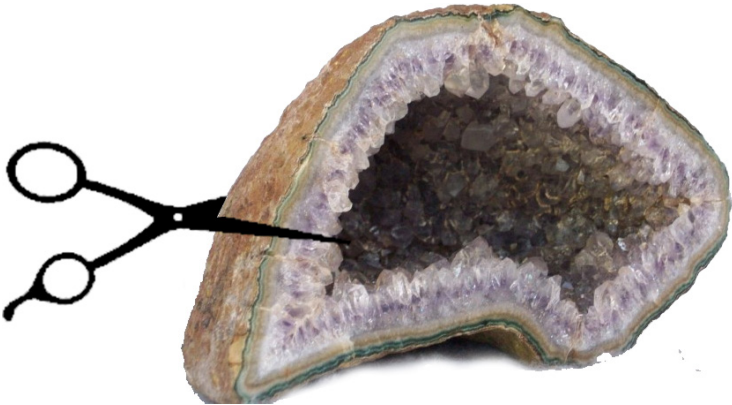

# MATERIALS AND INSPIRATION



# PROGRAM CONCEPT DIAGRAMS

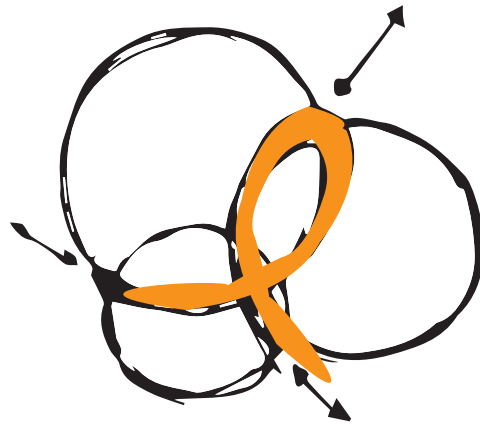
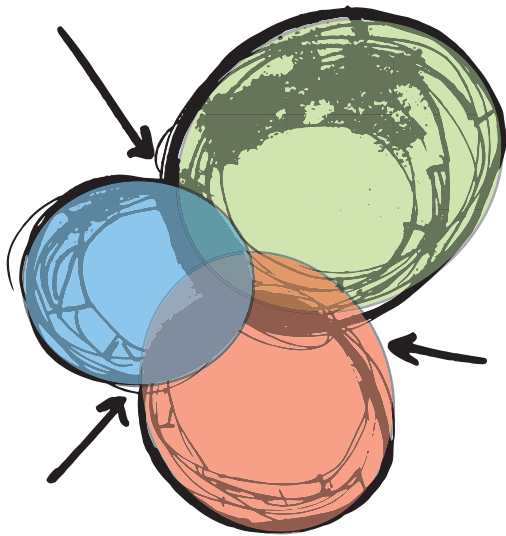

# STRUCTURAL CONCEPT DIAGRAMS

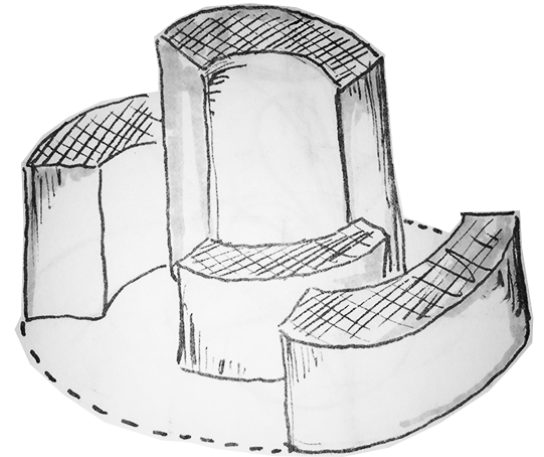
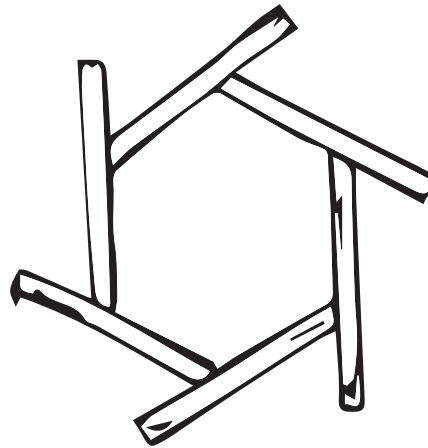

# CONCEPT DIAGRAMS

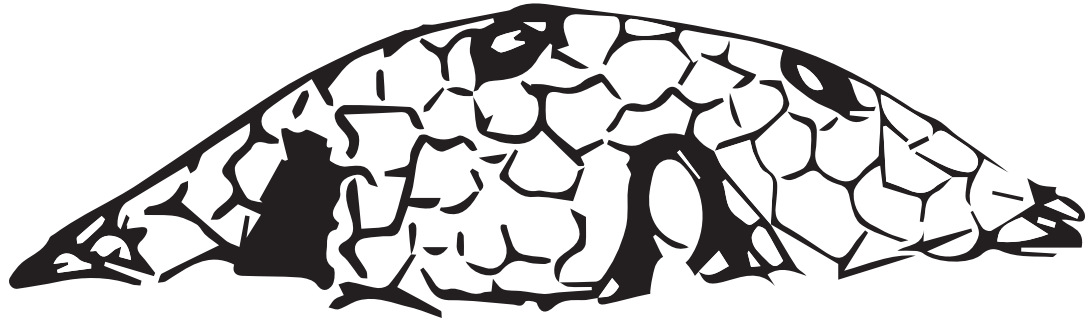

# SUN STORAGE/DISTRIBUTION

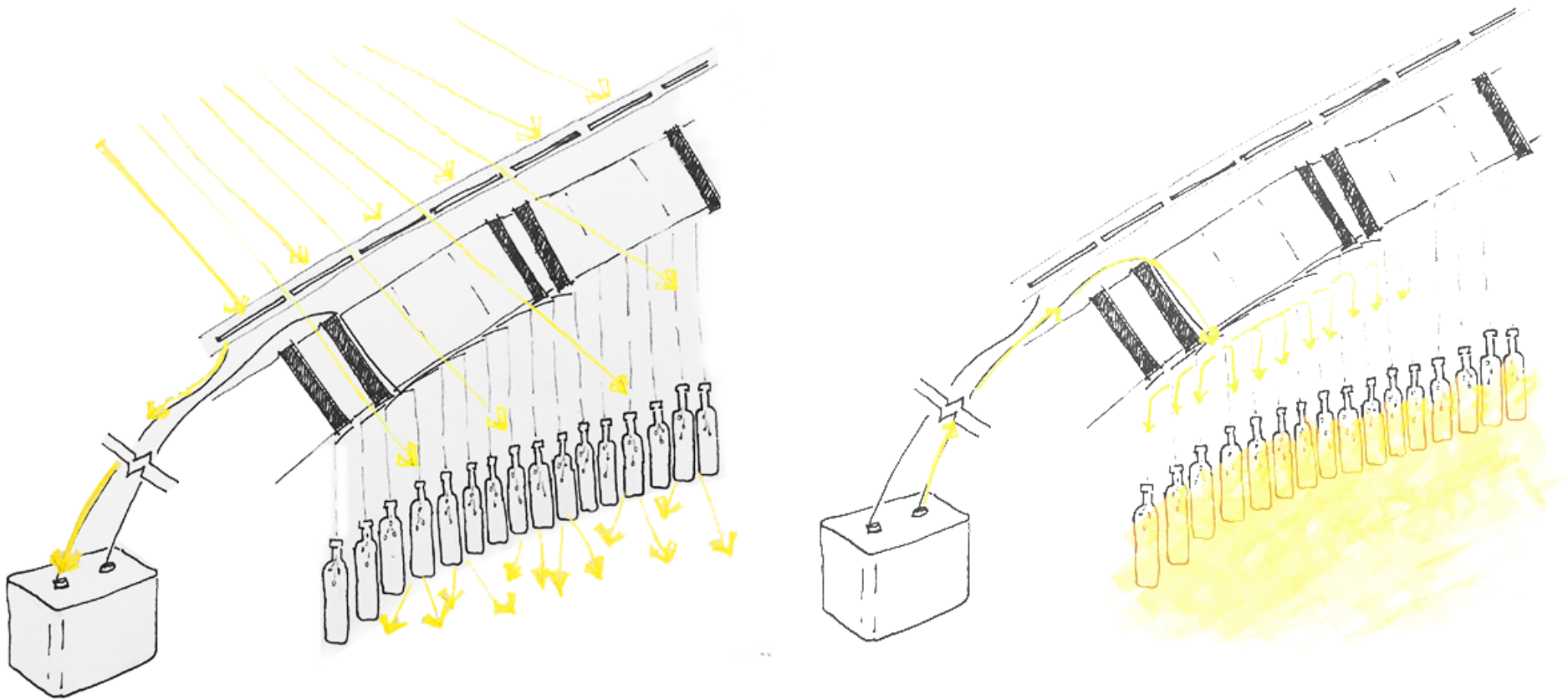

# DESIGN



PLAN AND SITE



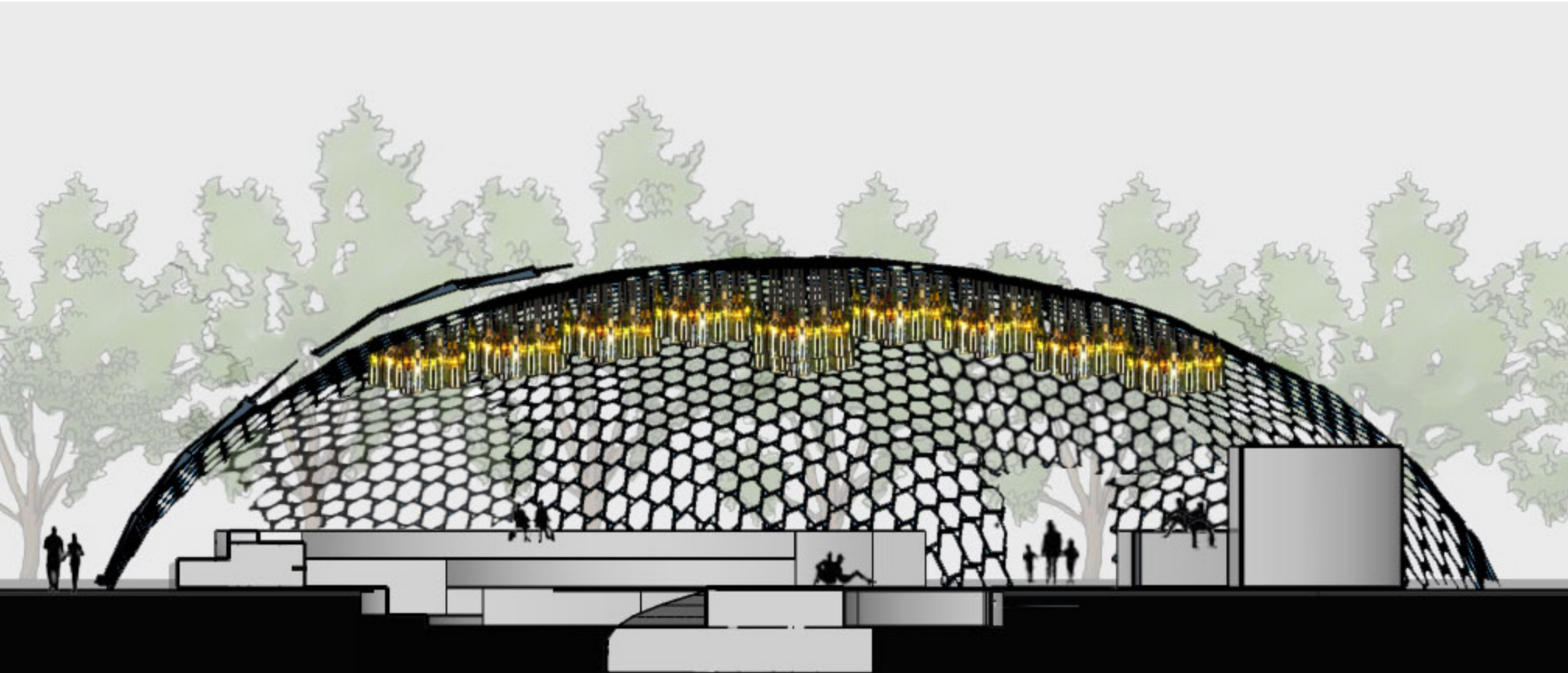

SECTION

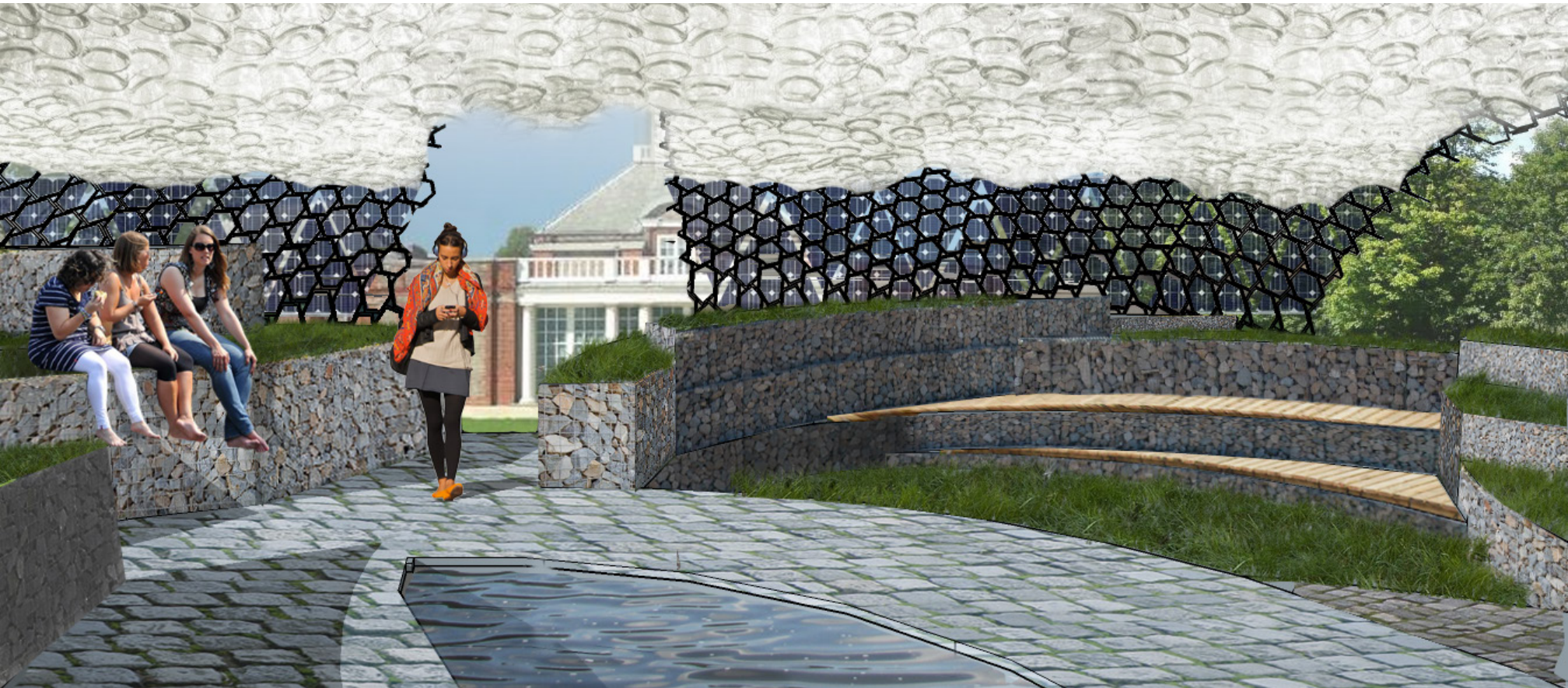

PERSPECTIVE

