

EDEN

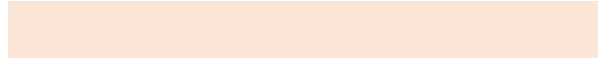

UNIVERSITY OF IDAHO - GIOVANNI FLORENCA, LUZ ESCALANTE, AND DEONA SWAGER - CULLINAN STUDIOS





SITE PICTURES

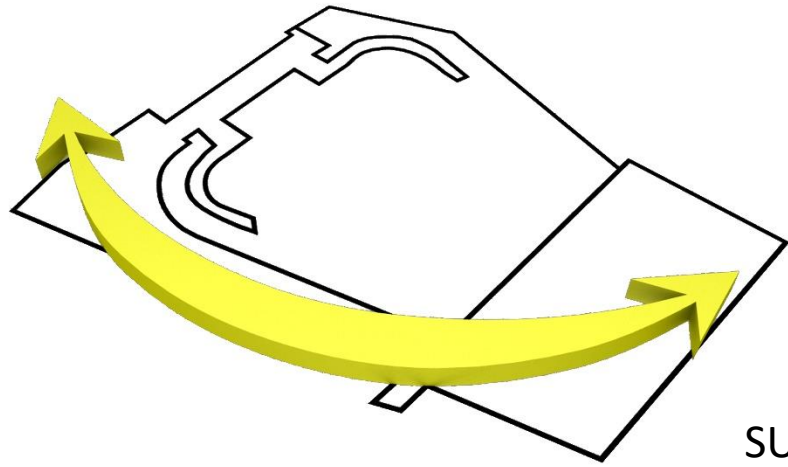

SUN PATH

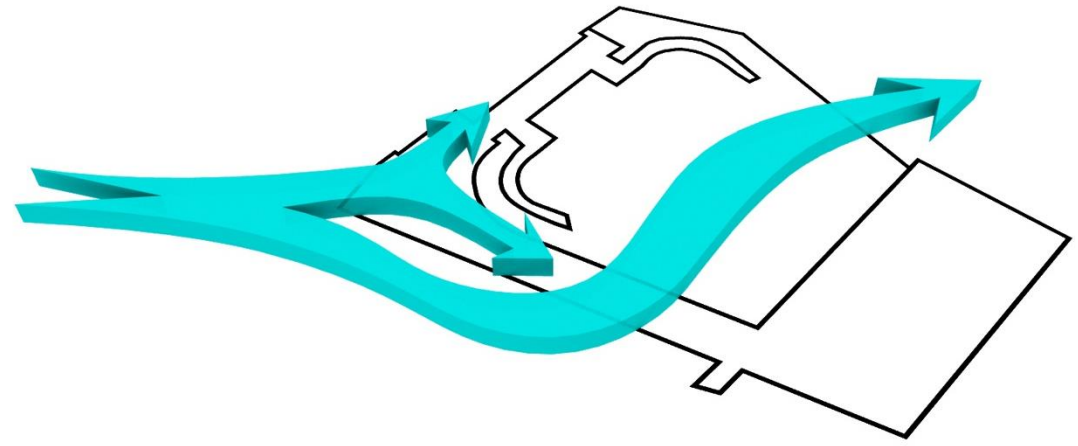

WIND PATH

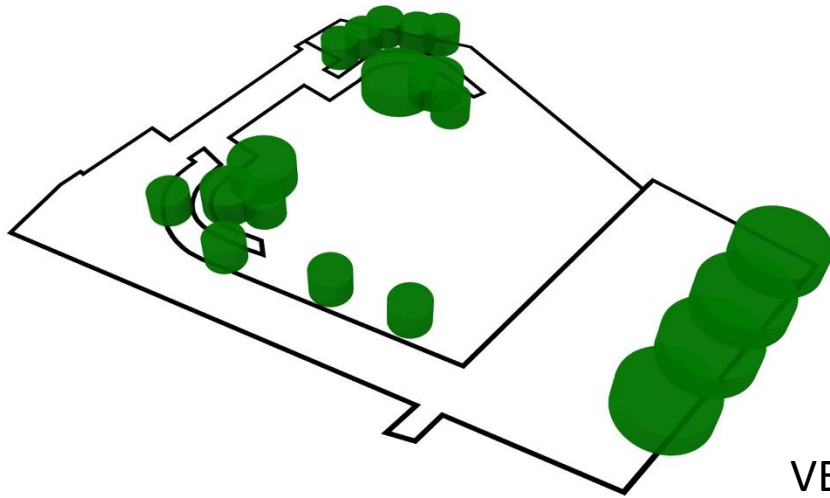

VEGETATION

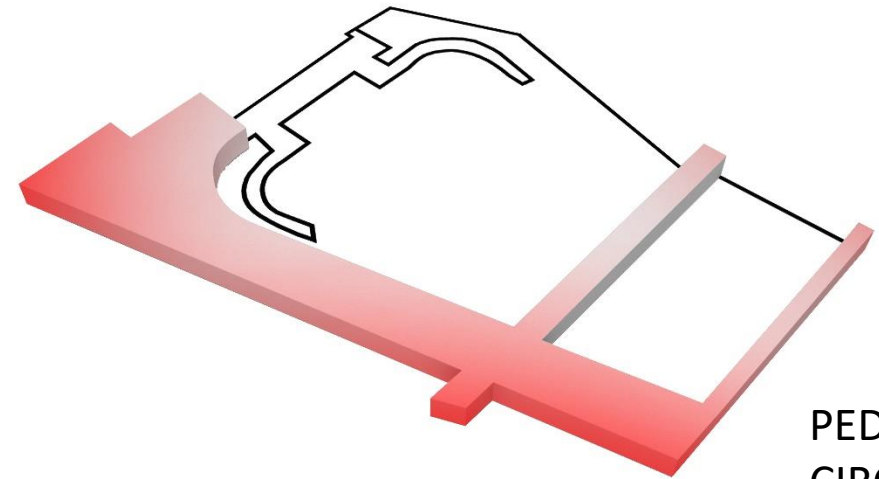

PEDESTRIAN
CIRCULATION

SITE ANALYSIS



PRECEDENTS

CONCEPTS

ORGANIC FLOORPLAN

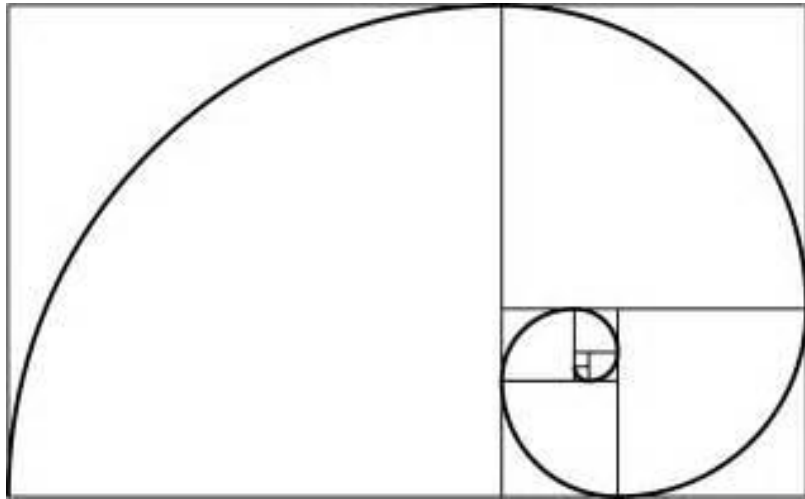

EXPERIENTIAL EVOLUTION

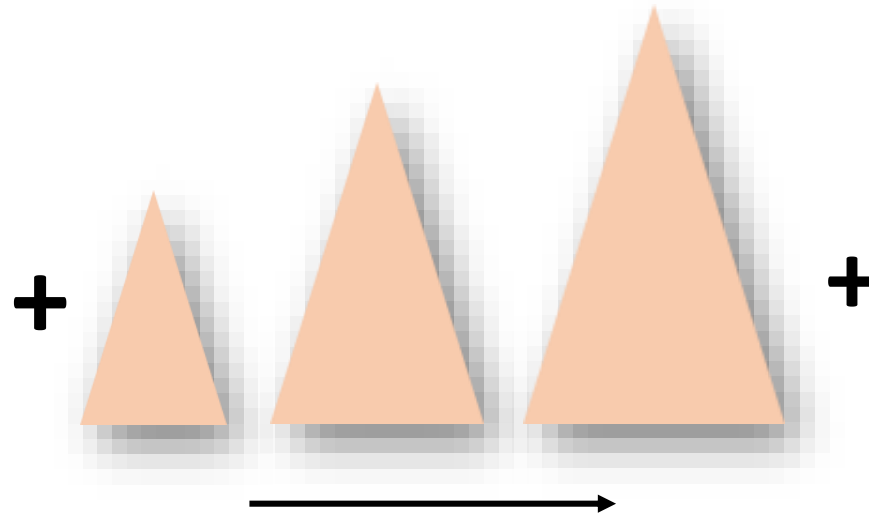

MIMIC NATURE

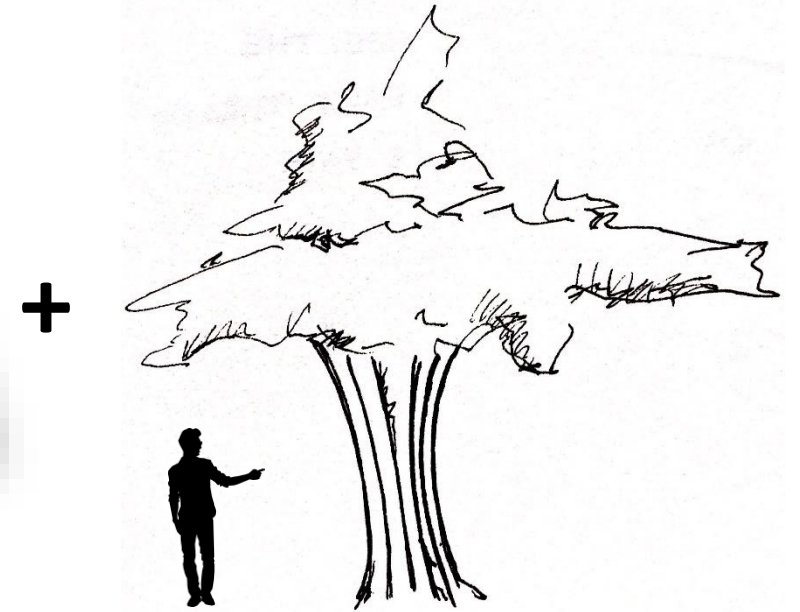

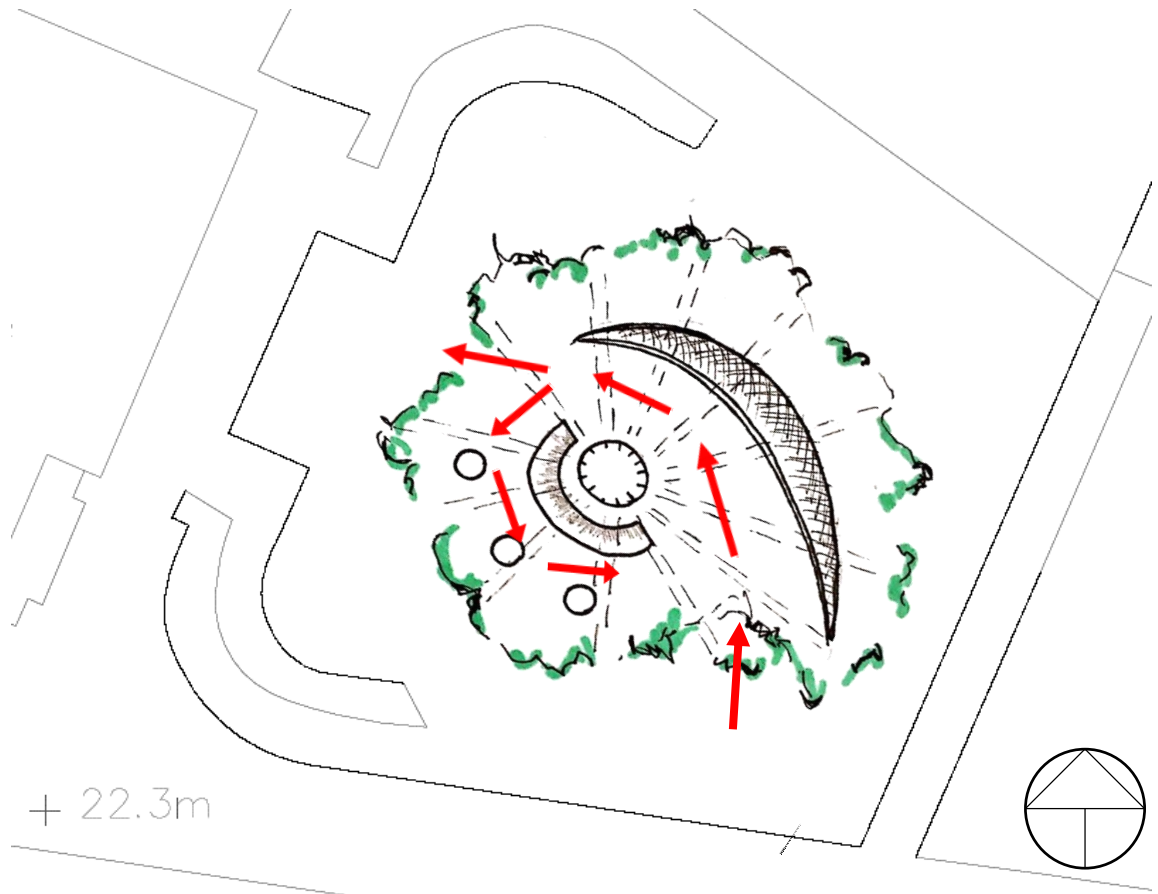

+ 22.3m

 PEDESTRIAN CIRCULATION

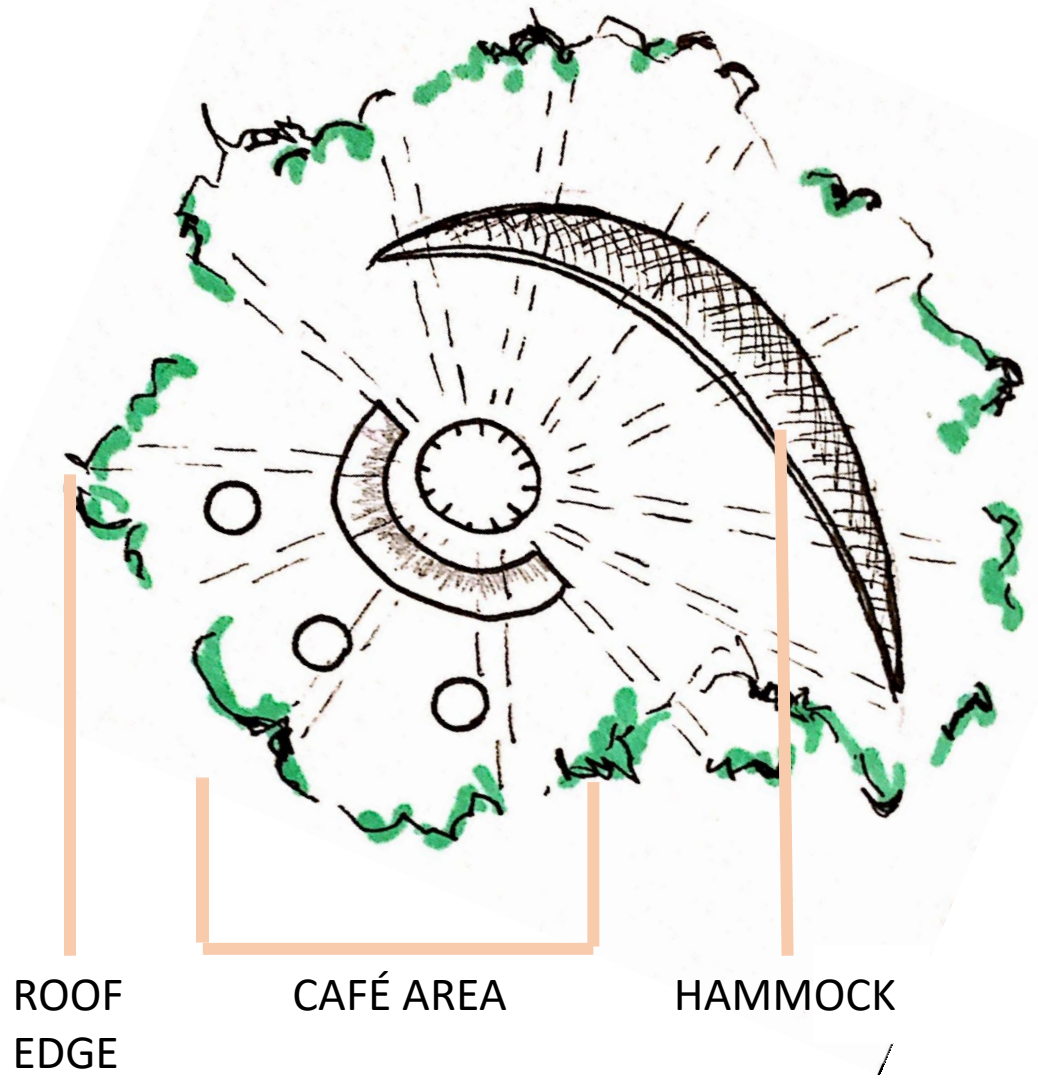

ROOF
EDGE

CAFÉ AREA

HAMMOCK

PARTI FLOOR PLAN

INTERACTIVE STRUCTURE

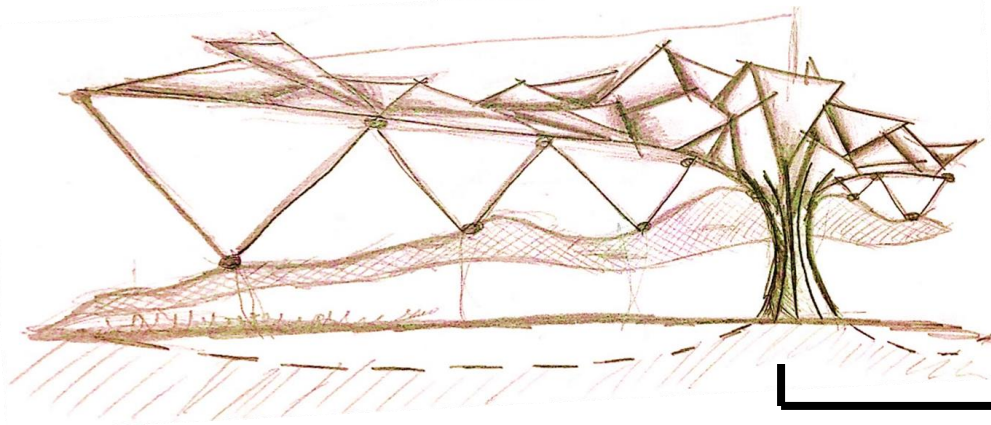
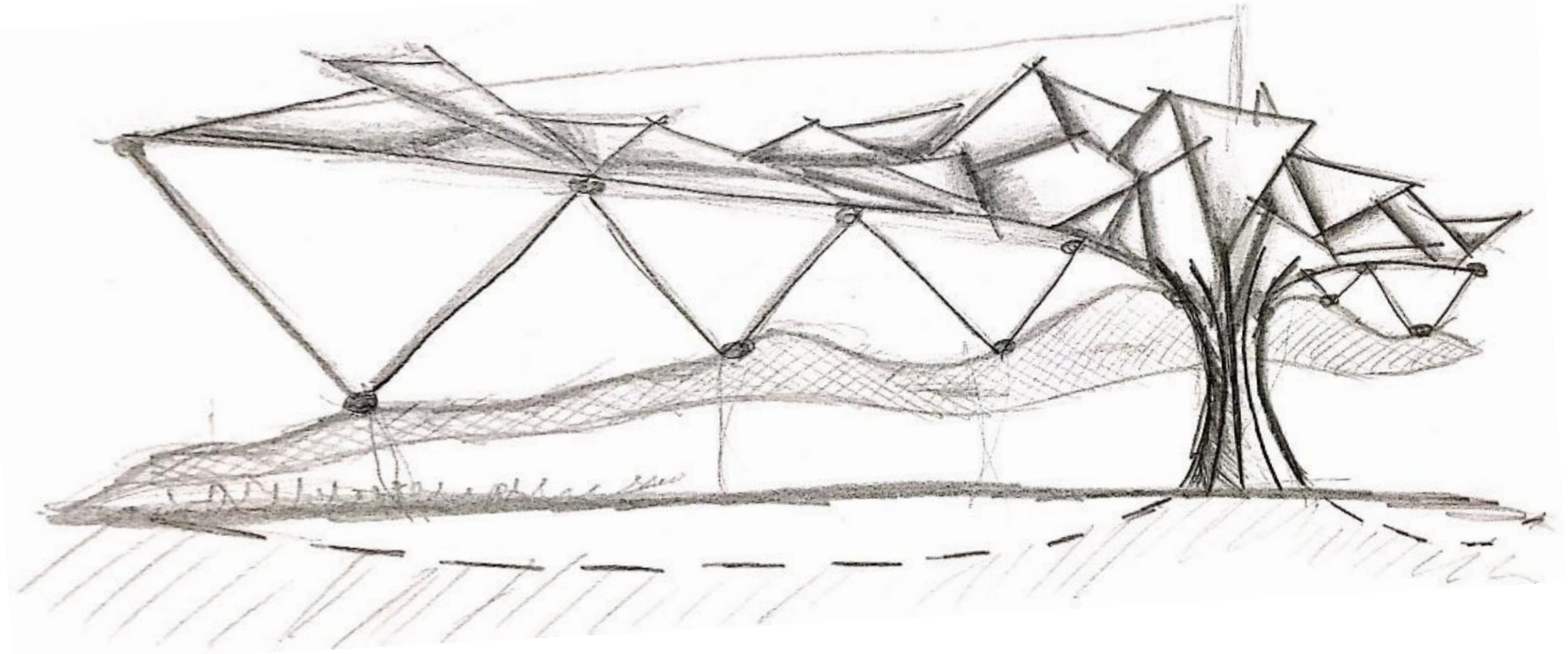

- TRIANGULAR ROOF
(SHADING DEVICE)
- HAMMOCK (INTERACTIVE)
- MAIN STRUCTURE
(CAFÉ AREA)

ROOF STRUCTURE



TIMBER STRUCTURE (GLULAM)



RECYCLED PLASTIC



HIDDEN STEEL CABLE STRUCTURE

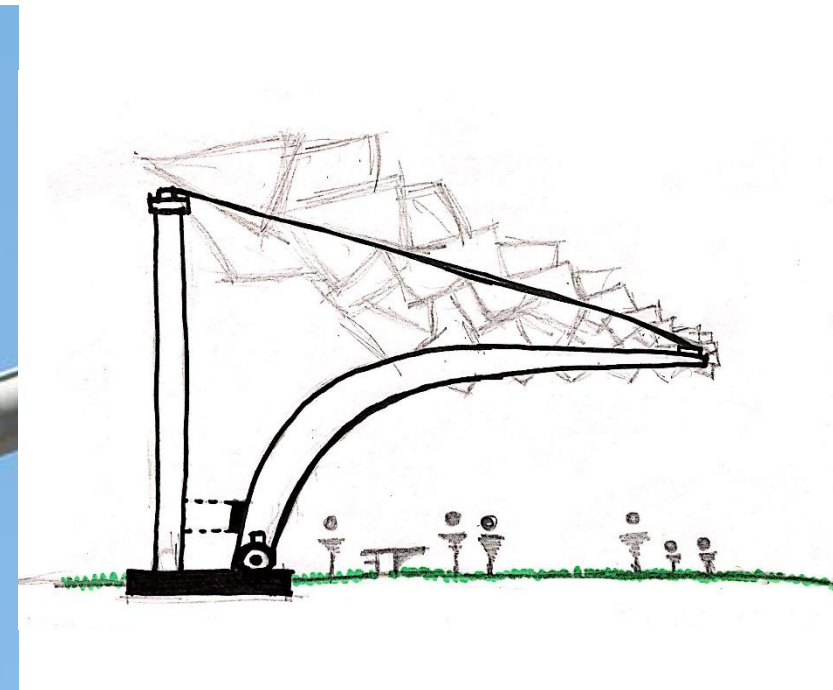

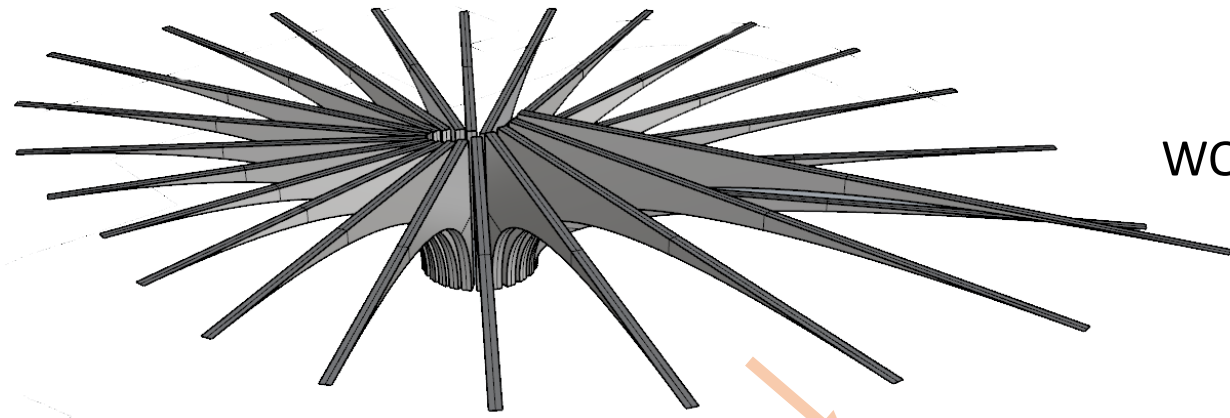

WOOD STRUCTURE

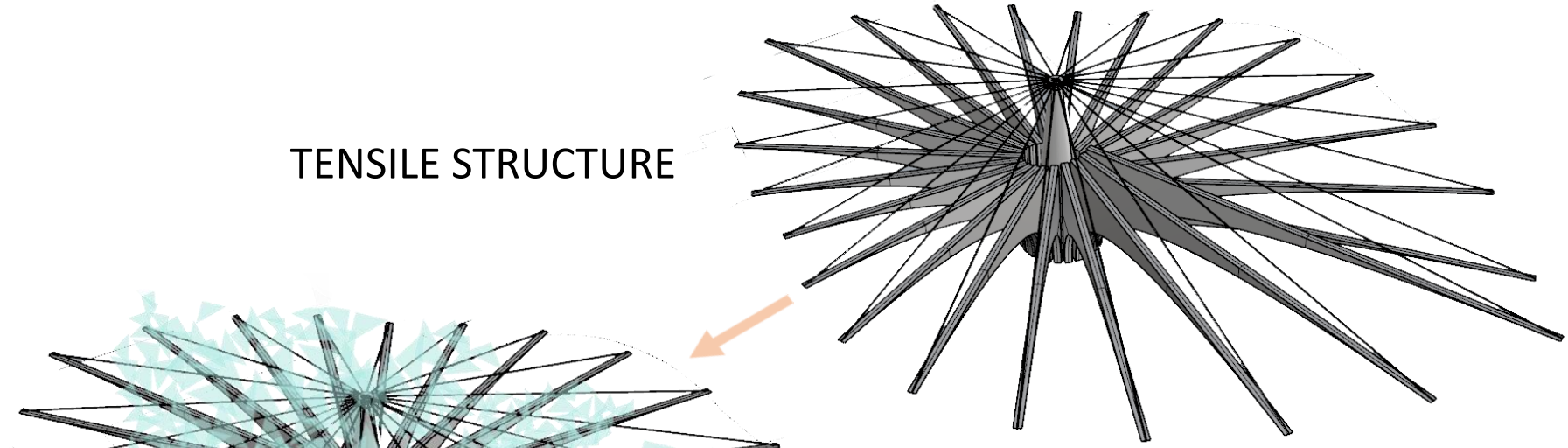

TENSILE STRUCTURE

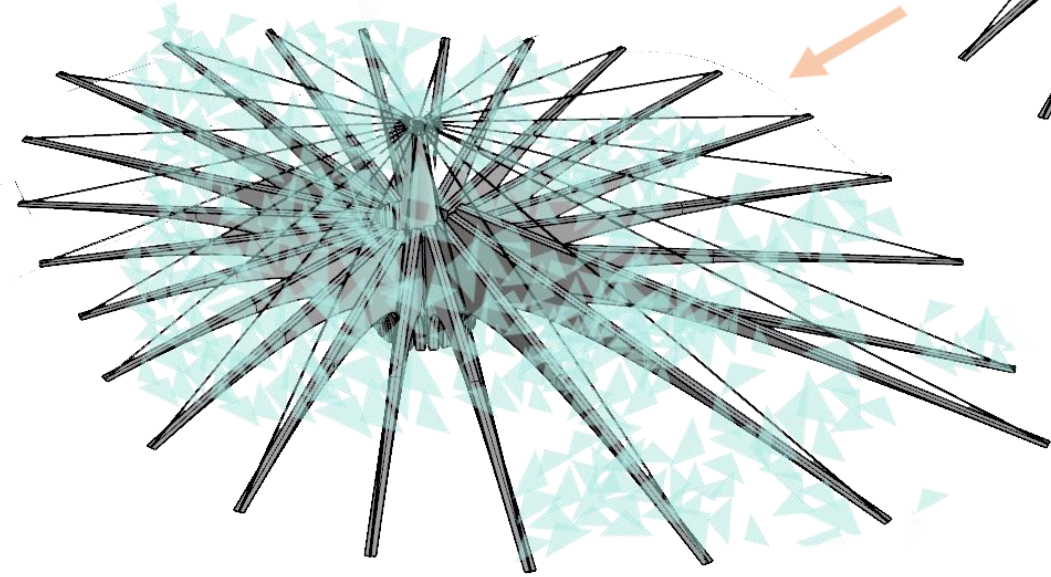

RECYCLED PLASTIC SHADING/LIGHTING DEVICE

TRUNKS



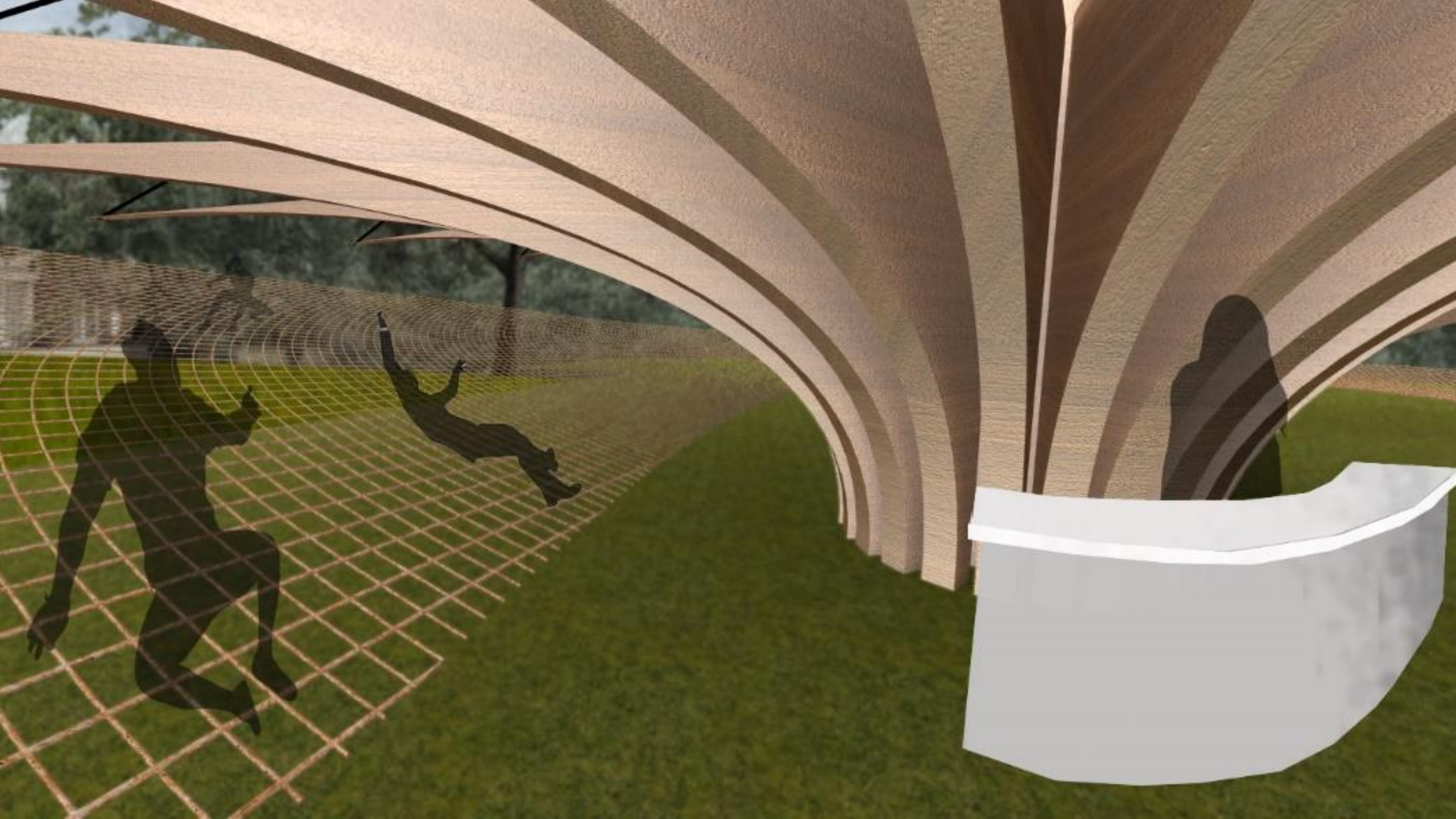

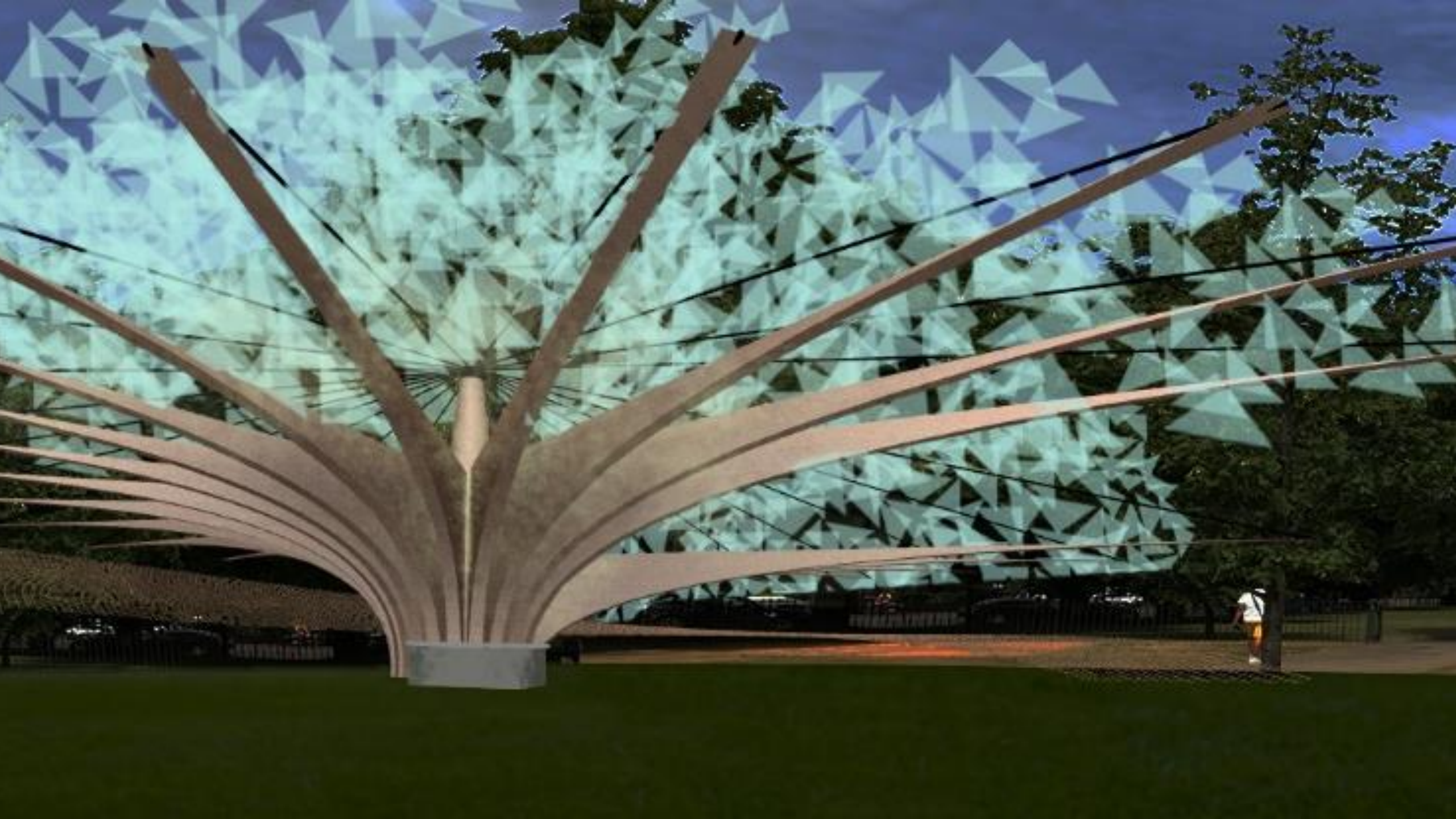

THANK YOU