

THIRD FLOOR

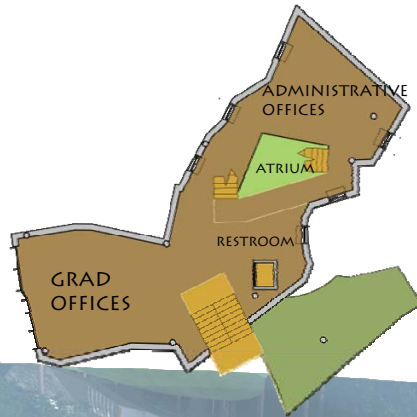

PLANS

FORTH FLOOR

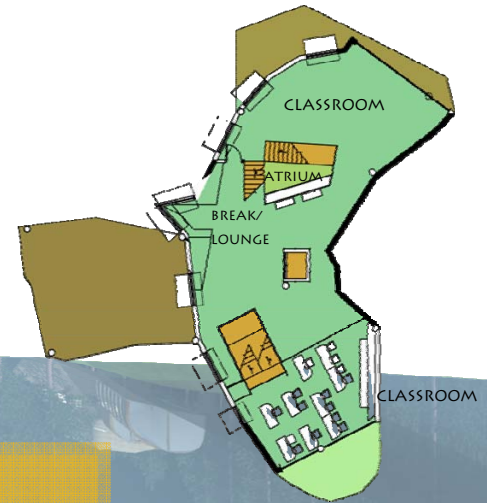

PLANS

FIFTH FLOOR

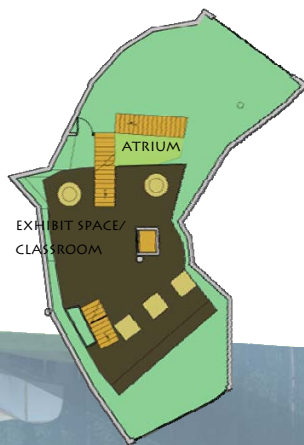

PLANS

SOUTH

WEST

ELEVATIONS

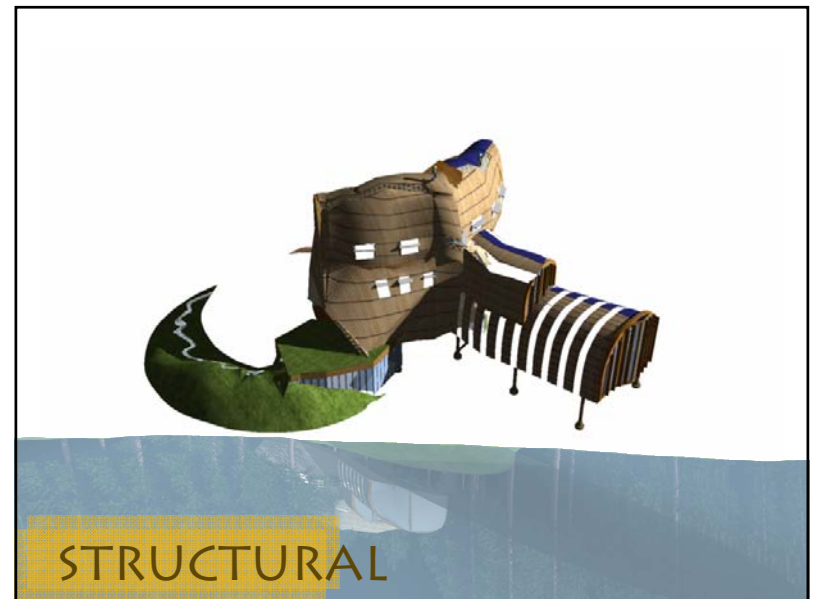
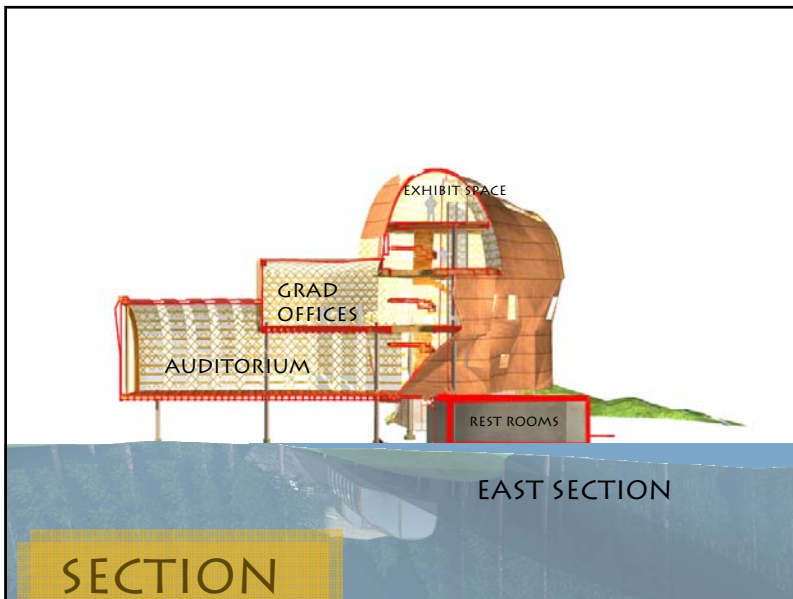
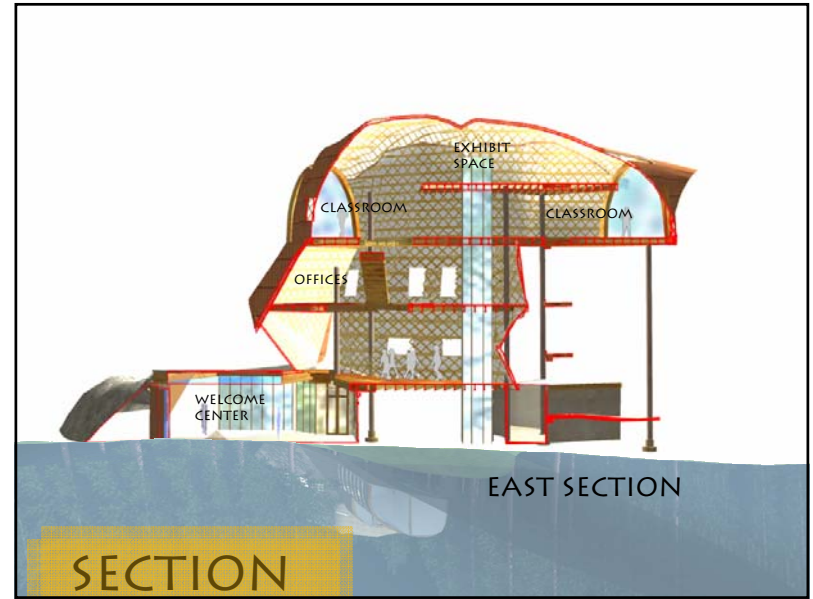
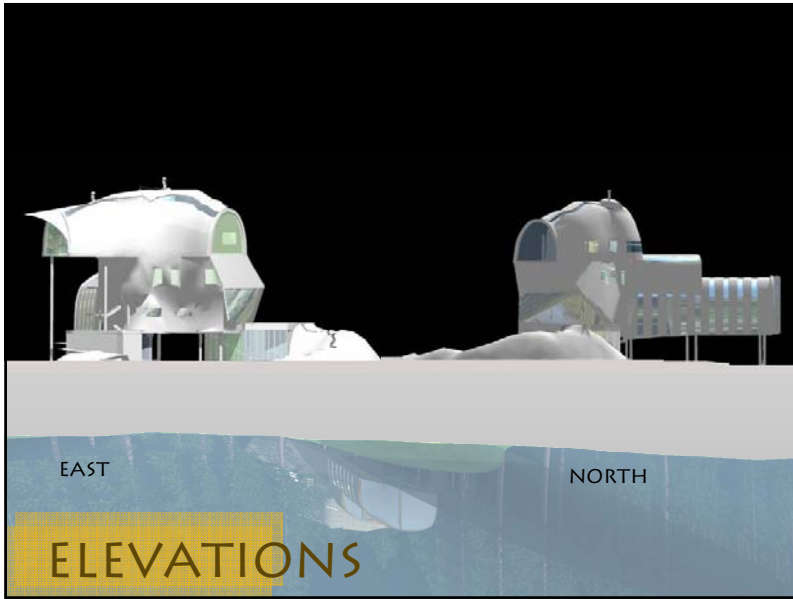



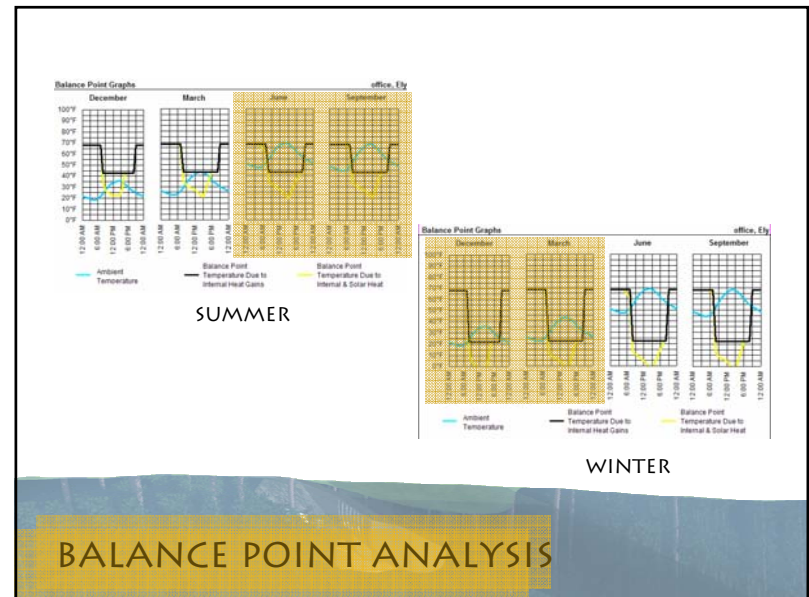
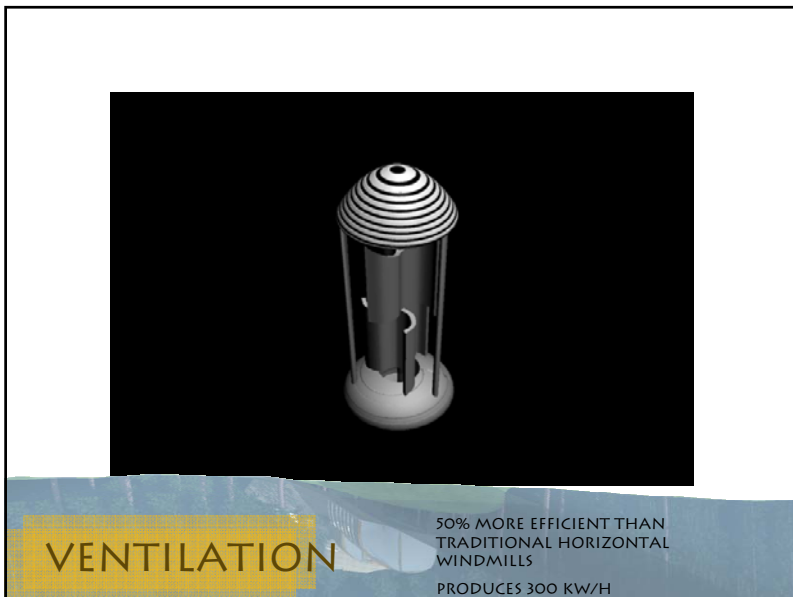
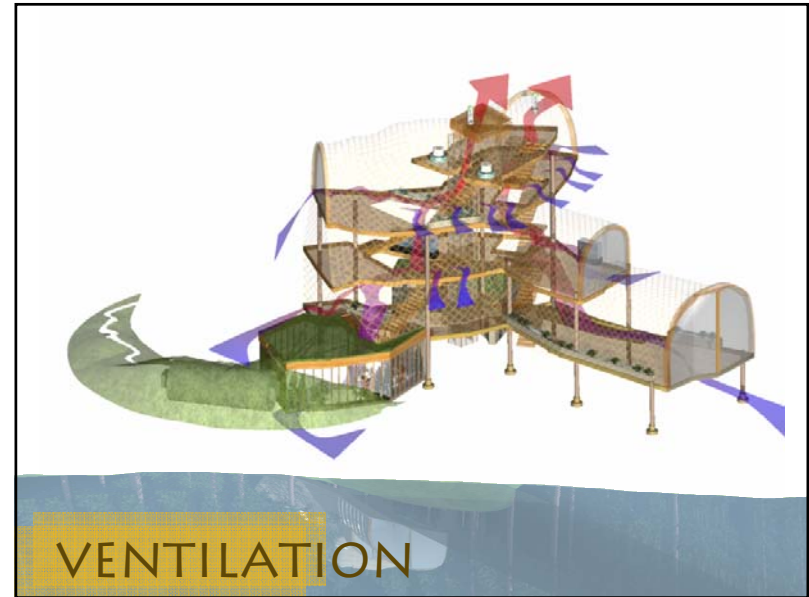

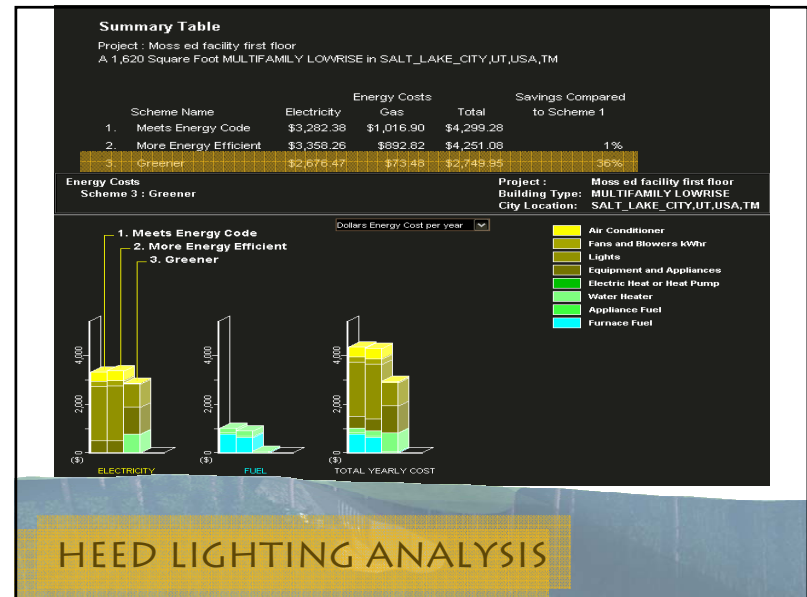
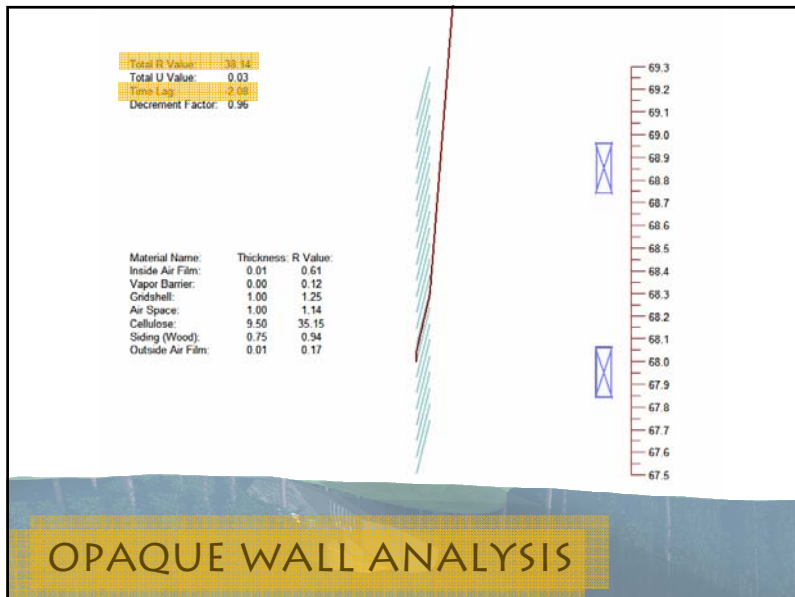
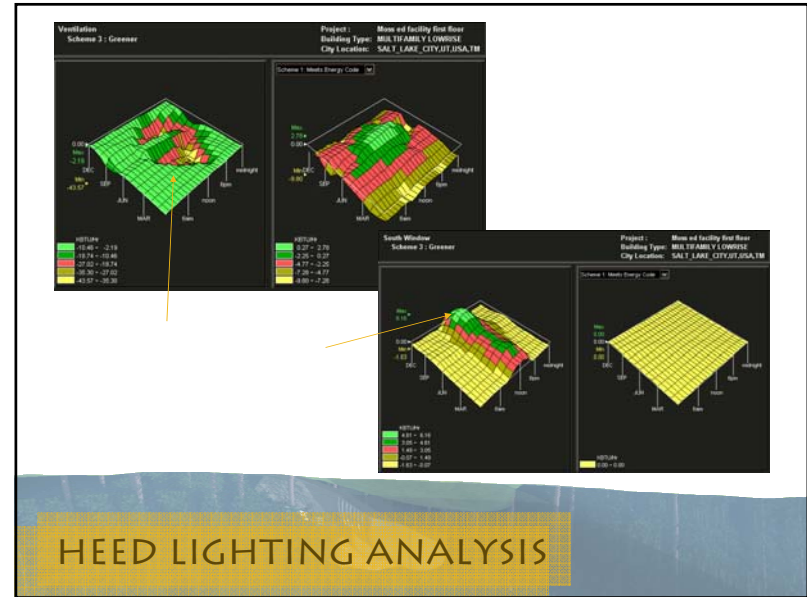
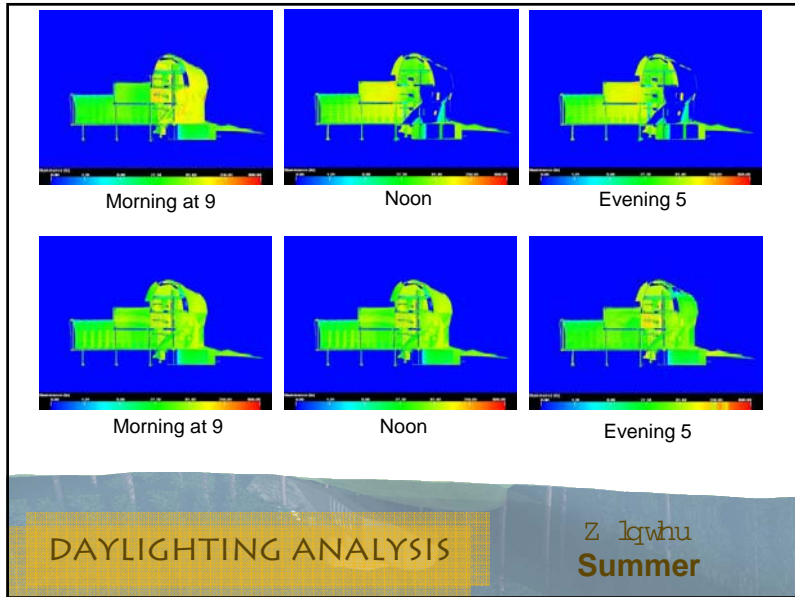

| Target Energy Performance Results (estimated) | | | |
|---|-----------|-----------|-------------|
| Energy | Design | Target | Top 10% |
| Energy Performance Rating (1-100) | 100 | 95 | 90 |
| Energy Reduction (%) | 62 | 50 | 38 |
| Source Energy Use Intensity (kBtu/Sq. Ft./yr) | 69.4 | 95.1 | 114.1 |
| Site Energy Use Intensity (kBtu/Sq. Ft./yr) | 23.0 | 31.6 | 37.9 |
| Total Annual Source Energy (kBtu) | 693,579.8 | 951,369.2 | 1,140,808.7 |
| Total Annual Site Energy (kBtu) | 230,195.7 | 315,754.8 | 378,628.8 |
| Total Annual Energy Cost (\$) | \$ 19,446 | \$ 26,674 | \$ 31,985 |

| Facility Information | | Estimated Design Energy | | | |
|--|----------------------------|---|-------|-----------------------------------|-----------------------|
| Edit | | Edit | | | |
| Facility Characteristics | | Energy Source | Units | Estimated Total Annual Energy Use | Energy Rate (\$/Unit) |
| MOSS Education Facility McCall, ID 83638 United States | | | | | |
| Space Type | Gross Floor Area (Sq. Ft.) | | | | |
| K-12 School | 5,000 | Electricity | kWh | 26,987 | \$ 0.500/kWh |
| Office (General) | 5,000 | Electricity | kWh | 40,480 | \$ 0.147/kWh |
| Total Gross Floor Area | 10,000 | Source: Data adapted from DOE/EIA. See EPA Technical Description. | | | |

ENERGY STAR TARGET

| Materials | Manufactured Cost | Initial Cost | Lifetime Cost |
|------------------------------|-------------------|--------------|---------------|
| FSC Small Dimension Lumber | Low | Medium | Low |
| Glu Lam Beams and members | Medium | Medium | Low |
| Rammed Earth | Low | Low | Low |
| Rebar | High | Medium | Low |
| Glass | High | High | Medium |
| Plastics in plumbing systems | High | Medium | Low |
| Joints for gridsehl | Medium | Low | Low |
| rubbe trench | Low | Low | Low |
| Photovoltaics | High | Low | Low |
| Metals in Wind Mill | High | Low | Low |
| Polycarbonate | High | Medium | Low |
| Cellulose | Medium | Low | Low |

**MY INTENT WAS TO ACHIEVE LOW EMISSIONS
MINIMIZATION OF IMPACT TO THE SITE**

CARBON DEBT